

AGIMAG[®]

THE MAGNETICALLY DRIVEN AGITATORS
RANGE FOR INDUSTRY

- ABSOLUTE TIGHTNESS
- PERFECT CLEANABILITY
- SANITARY SAFETY
- STERILIZATION AND CLEANING IN PLACE*

*EHEDG - FDA - USP CLASS 6

Magnetically driven agitator
for pharmaceutical
and agro-food industries

For 20 to 40 000 litres tanks

- > Blending
- > Dispersion
- > Dissolution
- > Heat transfer



mixel
agitators

AGIMAG®

THE MAGNETICALLY DRIVEN AGITATORS
RANGE FOR INDUSTRY

APPLICATIONS

Manufacture of vaccines, lotions, liquid creams, gastric dressing, eyewash, syrups, injectable medicines...

Storage of milk, yogurt, fruit juices with or without pulp, alcohol...

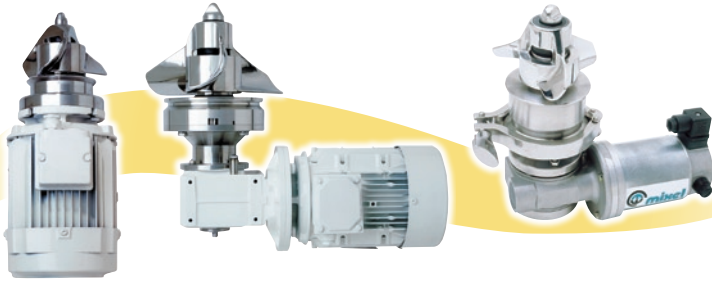

► **R SERIES (fast speed), L SERIES (slow speed) and S SERIES (special)**
For volumes from 20 to 40 000 litres

TYPE	Ø IMPELLER (mm)	MOTOR POWER (kW - rpm)	FREQUENCY & SPEED RANGE (Hz - rpm)
AGIMAG® 80R	80	0,18 - 1 500	15 - 56 / 400 - 1 500
AGIMAG® 100R	100	0,18 - 1 500	15 - 37 / 400 - 1 100
AGIMAG® 125R	125	0,55 - 1 000	15 - 50 / 300 - 1 000
AGIMAG® 160R	160	0,55 - 750	15 - 50 / 220 - 750
AGIMAG® 80L	80	0,25 - 3 000	15 - 50 / 170 - 560
AGIMAG® 100L	100	0,25 - 3 000	15 - 50 / 170 - 560
AGIMAG® 125L	125	0,25 - 3 000	15 - 50 / 170 - 560
AGIMAG® 160L	160	0,25 - 3 000	15 - 45 / 170 - 500
AGIMAG® 200L	200	0,25 - 3 000	15 - 50 / 120 - 400
AGIMAG® 200S	200	1,1 - 3 000	15 - 55 / 150 - 550
AGIMAG® 250S	250	1,1 - 1 500	15 - 63 / 80 - 330
AGIMAG® 300S	300	1,5 - 1 500	15 - 57 / 80 - 300
AGIMAG® 400S	400	2,2 - 1 500	15 - 50 / 72 - 240
AGIMAG® 600S	600	4 - 1 500	15 - 54 / 58 - 210

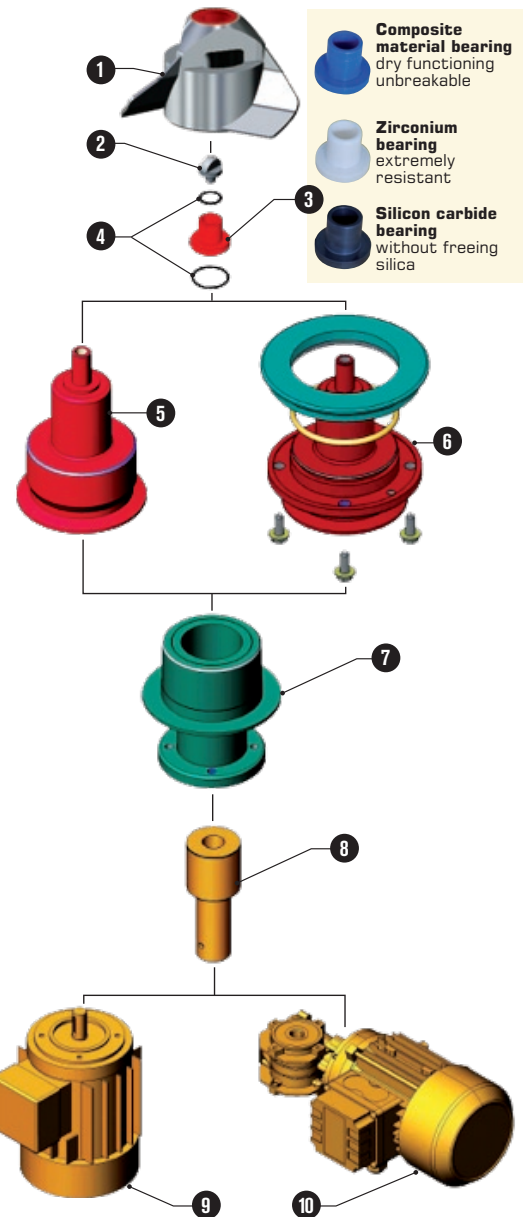

- Composite material bearing**
dry functioning
unbreakable
- Zirconium bearing**
extremely
resistant
- Silicon carbide bearing**
without freeing
silica

► **ACCESSORIES**

▲ Dispersion turbine

◀ Dismounting tool for impeller and bearings

▶ Tachometer to measure the real rotation speed of the impeller

▶ Easy removal of the impeller by assisted extraction of the motor magnet, without disassembling the motorization

- 1 External rotor (impeller)
- 2 Bearing axis
- 3 Bearing
- 4 O rings
- 5 Bell (to be welded)
- 6 Flange (to be welded) if dismountable bell
- 7 Raising block
- 8 Internal rotor
- 9 Motor
- 10 Motor + gear box

Among our customers:
SANOFI AVENTIS, SANOFI PASTEUR, MERIAL, VEATOQUINOL, VIRBAC, GSK, DELPHARM, NESTEC / NESTLE, TETRA PAK, INGREDIA, PEPSICO TROPICANA, ALCON, ESSILOR, DEGUSSA, Groupe Pierre FABRE...