

## DCD Pulling Grips

Hand-woven by experienced tradespeople in order to guarantee a consistent level of high quality, DCD Pulling Grips enclose the cable firmly over the entire length of the mesh. They are made of high tensile steel strands. Depending on the type of grip, the strand is comprised of seven, twelve, or nineteen wires. By selecting the most suitable strand, the tension distribution characteristics can be adjusted to suit the requirements.

DCD grips are reverse woven, creating a loop at the end of the grip instead of being soldered or crimped together. These grips meet the highest standards in terms of material and workmanship and we are pleased to offer a wide range of grips with different designs and eye arrangements for onsite (or premise), underground or overhead installations.

The looped pulling head is actually a separate wire rope eye which is placed inside the swage sleeve along with the wire mesh strands. The swage sleeve is then crimped forming an extremely effective anchor point for both the looped head and the wire mesh. Testing proves this is never the weakest link of the product. The flexible eye allows cable to be pulled easily through smaller ducting.

Some DCD grips have rotating heads, which allow the grip to rotate while not under load. DCD also offers the Wire Grip Swivel (pg 27), designed specifically for use with flexible eye grips. It is easily interchangeable, but it will also not rotate under load.

All capacities indicated are approximate breaking strength. Each user must decide what safety factor they require for each specific operation before selecting which grip to use. Due to metal fatigue and possible in-use damage, quoted values only apply to new grips.

Special configurations (double eyes, extra length, etc) may be available as a special factory order. Contact Customer Service with your requirements.



Reverse-Woven Grip End



Looped Pulling Head



Rotating Pulling Head



## Selecting the Correct Grip

Grips are designed for a specific range of cable diameter. To select the correct grip for the job you are pulling:

1. Determine the outside cable diameter. Fit as close as possible to the cable diameter, choosing the size smaller when on a boundary.
2. Wherever possible, use a closed mesh that assembles over the cable end. Use a split mesh when the cable end is not available.
3. Select the eye style best suited to your requirements.
4. Estimate the tension that will be put on the grip and calculate the working load you require, allowing for correct safety factors suitable for the application (3-5 times is typical for pulling grips; refer to your local requirements or practices).
5. Always read breaking strength, safety, and technical data information. Approximate mesh length is measured at an average grip diameter.
6. Taking all of the above into account, look in the size range column of the appropriate grip and determine the part number best suited to your pull.

## Multiple Cable Installation Selection

The following table will assist you in selecting the correct grip size for installations using multiple cables. If the bundle has cables of different diameters, measure the circumference of the bundle and refer to the first column in the table. If the bundle has cables of the same diameter, simply take the diameter from a single cable and refer to the appropriate column based on how many cables are in the bundle.

Mixed Cables: Circumference of Bundle	2 Cables: Diameter of Each Cable	3 Cables: Diameter of Each Cable	4 Cables: Diameter of Each Cable	5 Cables: Diameter of Each Cable	6 or 7 Cables: Diameter of Each Cable	8 Cables: Diameter of Each Cable	9 Cables: Diameter of Each Cable	Required Grip Diameter
1.57" to 1.95"	0.30" to 0.38"	0.25" to 0.31"	0.22" to 0.27"	0.19" to 0.24"	0.17" to 0.22"	0.15" to 0.19"	0.14" to 0.18"	<b>0.50" to 0.61"</b>
1.95" to 2.36"	0.38" to 0.44"	0.31" to 0.36"	0.27" to 0.31"	0.24" to 0.29"	0.22" to 0.26"	0.19" to 0.23"	0.18" to 0.21"	<b>0.62" to 0.74"</b>
2.36" to 3.14"	0.44" to 0.59"	0.36" to 0.49"	0.31" to 0.42"	0.29" to 0.38"	0.26" to 0.34"	0.23" to 0.31"	0.21" to 0.28"	<b>0.75" to 0.99"</b>
3.14" to 3.93"	0.59" to 0.75"	0.49" to 0.63"	0.42" to 0.54"	0.38" to 0.48"	0.34" to 0.43"	0.31" to 0.39"	0.28" to 0.35"	<b>1.00" to 1.24"</b>
3.93" to 4.71"	0.75" to 0.90"	0.63" to 0.76"	0.54" to 0.65"	0.48" to 0.58"	0.43" to 0.52"	0.39" to 0.46"	0.35" to 0.42"	<b>1.25" to 1.49"</b>
4.71" to 5.50"	0.90" to 1.07"	0.76" to 0.89"	0.65" to 0.77"	0.58" to 0.67"	0.52" to 0.60"	0.46" to 0.54"	0.42" to 0.49"	<b>1.50" to 1.74"</b>
5.50" to 6.28"	1.07" to 1.22"	0.89" to 1.02"	0.77" to 0.88"	0.67" to 0.77"	0.60" to 0.69"	0.54" to 0.62"	0.49" to 0.56"	<b>1.75" to 1.99"</b>
6.28" to 7.85"	1.22" to 1.53"	1.02" to 1.28"	0.88" to 1.10"	0.77" to 0.96"	0.69" to 0.86"	0.62" to 0.77"	0.56" to 0.71"	<b>2.00" to 2.49"</b>
7.85" to 9.42"	1.53" to 1.83"	1.28" to 1.53"	1.10" to 1.32"	0.96" to 1.16"	0.86" to 1.03"	0.77" to 0.93"	0.71" to 0.85"	<b>2.50" to 2.99"</b>
9.42" to 11.00"	1.83" to 2.14"	1.53" to 1.79"	1.32" to 1.54"	1.16" to 1.35"	1.03" to 1.20"	0.93" to 1.08"	0.85" to 0.99"	<b>3.00" to 3.49"</b>
11.00" to 12.57"	2.14" to 2.44"	1.79" to 2.05"	1.54" to 1.76"	1.35" to 1.54"	1.20" to 1.37"	1.08" to 1.24"	0.99" to 1.13"	<b>3.50" to 3.99"</b>
12.57" to 14.14"	2.44" to 2.75"	2.05" to 2.30"	1.76" to 1.98"	1.54" to 1.74"	1.37" to 1.55"	1.24" to 1.39"	1.13" to 1.27"	<b>4.00" to 4.49"</b>
14.14" to 15.71"	2.75" to 3.06"	2.30" to 2.56"	1.98" to 2.20"	1.74" to 1.93"	1.55" to 1.72"	1.39" to 1.55"	1.27" to 1.41"	<b>4.50" to 4.99"</b>

## Wire Grip Swivel

These swivels can be used in conjunction with DCD Wire Mesh Grips or standard 1/4" to 1/2" rope. They will allow the utility being installed to "unwind" as it is being pulled in, but like the rotary heads, these swivels will not rotate under load.



Part No.	Minimum Breaking Strength	A	B	C	Weight
<b>00501-010</b>	10,000 lb	1-1/4"	9/16"	7"	1.5 lb
<b>00501-025</b>	25,000 lb	1-5/8"	9/16"	8-5/8"	3.2 lb

## Single Weave, Single Eye, Light Duty

These grips offer a flexible eye with single weave galvanized wire construction for light duty applications, pulling single or grouped cable, where a small profile is needed. A standard kit is also available in a pouch.

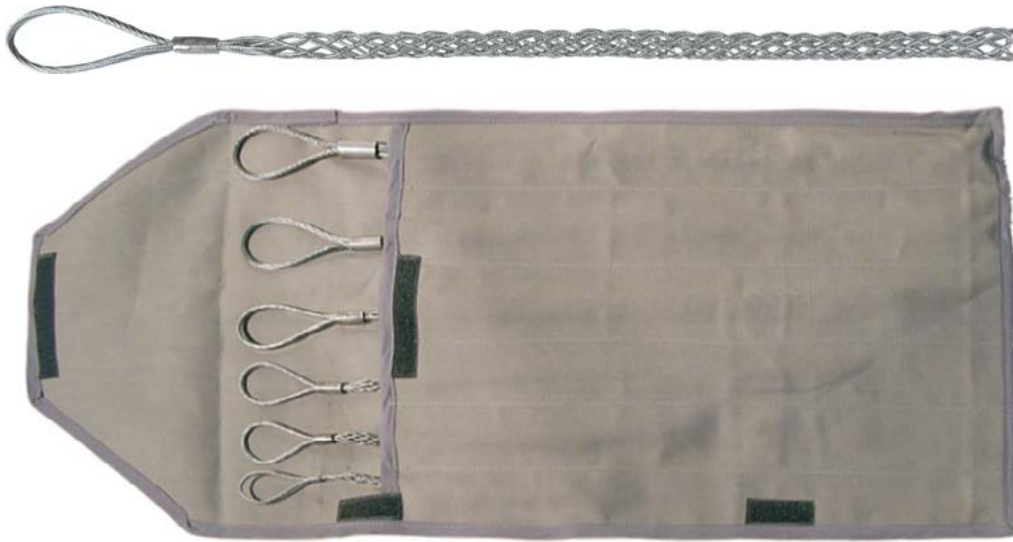

Kit with Pouch (00661-JGK)

Part No.	Size Range	Approximate Mesh Length	Approximate Breaking Strength	Weight
00661-004	0.15" to 0.24"	6-1/2"	400 lb	0.01 lb
00661-006	0.25" to 0.37"	6-1/2"	460 lb	0.01 lb
00661-010	0.38" to 0.49"	7-1/2"	860 lb	0.03 lb
00661-013	0.50" to 0.62"	9"	1,250 lb	0.06 lb
00661-016	0.63" to 0.74"	12"	1,790 lb	0.09 lb
00661-019	0.75" to 0.99"	12"	2,580 lb	0.13 lb
00661-025	1.00" to 1.24"	12-1/2"	4,090 lb	0.22 lb
00661-JGK	Kit with pouch that includes one of all above parts except 00661-004			0.90 lb

## Non-Conductive, Single/Double Weave, Single Eye

These grips are non-metallic and non-conductive, which is ideal for use in damp conditions or off-shore applications. The high-strength aramid fibers are coated, lightweight and flexible: ideal for installing fiber optic cable or other high-tech cables. Smaller sizes are single weave, larger sizes are double weave.



Part No.	Size Range	Weave	Approximate Mesh Length	Approximate Breaking Strength	Weight
00662-010	0.38" to 0.74"	Single	34"	2,500 lb	0.12 lb
00662-020	0.75" to 1.12"	Single	35"	3,700 lb	0.18 lb
00664-030	1.13" to 1.49"	Double	35"	9,800 lb	0.22 lb
00664-040	1.50" to 1.99"	Double	38"	11,800 lb	0.46 lb

## Double Weave, Single Eye

These grips offer a flexible eye and double weave galvanized wire construction for regular load pulls. The galvanized steel braid offers durability for underground installations and other more demanding situations.



Part No.	Size Range	Approximate Mesh Length	Approximate Breaking Strength	Weight
00670-025	0.24" to 0.37"	18"	4,250 lb	0.21 lb
00670-038	0.38" to 0.74"	18"	5,000 lb	0.34 lb
00670-050	0.75" to 1.12"	20"	6,600 lb	0.47 lb
00670-100	1.13" to 1.49"	21"	10,000 lb	0.69 lb
00670-125	1.50" to 1.99"	24"	13,800 lb	1.43 lb
00670-200	2.00" to 2.49"	24"	14,200 lb	1.47 lb
00670-250	2.50" to 2.99"	28"	17,500 lb	1.90 lb
00671-080	3.00" to 3.74"	30"	18,000 lb	2.59 lb
00671-095	3.75" to 4.24"	32"	26,500 lb	3.52 lb

## Double Weave, Single Eye, Slack Grip, Closed Mesh

These grips offer an offset, flexible eye and durable, double-weave galvanized wire construction for an offset pull arrangement or pulling at the mid-span of the cable. Use this style if the end is available and the grip can be mounted directly onto the cable, leaving the cable end free.



Part No.	Size Range	Approximate Mesh Length	Approximate Breaking Strength	Weight
00674-010	0.38" to 0.74"	14"	2,500 lb	0.45 lb
00674-020	0.75" to 1.12"	17"	3,000 lb	0.50 lb
00674-030	1.13" to 1.49"	18"	5,000 lb	0.75 lb
00674-040	1.50" to 1.99"	20"	10,000 lb	1.54 lb
00675-050	2.00" to 2.49"	20"	11,000 lb	1.53 lb
00675-065	2.50" to 2.99"	22"	12,000 lb	1.85 lb
00675-080	3.00" to 3.74"	24"	15,000 lb	2.02 lb
00675-095	3.75" to 4.24"	24"	15,000 lb	4.32 lb

## Double Weave, Single Eye, Slack Grip, Split Mesh (Lace-up)

Similar to the 00674/00675 above, these grips offer an offset eye and double weave wire for offset or mid-span pulls. Use the laced, split-mesh grips if the end of the cable is not available or the grip cannot be mounted over the end fitting.



Part No.	Size Range	Approximate Mesh Length	Approximate Breaking Strength	Weight
00678-010	0.38" to 0.74"	14"	4,100 lb	0.40 lb
00678-020	0.75" to 1.12"	17"	4,970 lb	0.53 lb
00678-030	1.13" to 1.49"	18"	8,150 lb	0.81 lb
00678-040	1.50" to 1.99"	20"	12,100 lb	1.47 lb
00679-050	2.00" to 2.49"	21"	16,140 lb	1.74 lb
00679-065	2.50" to 2.99"	22"	16,140 lb	2.09 lb
00679-080	3.00" to 3.74"	24"	20,170 lb	2.69 lb
00679-095	3.75" to 4.24"	24"	23,400 lb	2.94 lb

## Double Weave, Single Eye, Shoulders

These grips offer a flexible eye with shoulders and double weave galvanized wire construction. The shoulders offer added protection to the utility being pulled in as well as protecting the leading wire strands.



Part No.	Size Range	Approximate Mesh Length	Approximate Breaking Strength	Weight
00680-025	0.25" to 0.49"	18"	4,800 lb	0.25 lb
00680-038	0.50" to 0.74"	18"	5,800 lb	0.38 lb
00680-050	0.75" to 1.12"	24"	6,700 lb	0.61 lb
00680-100	1.13" to 1.49"	24"	10,000 lb	0.87 lb
00680-125	1.50" to 1.99"	24"	16,400 lb	1.31 lb
00680-200	2.00" to 2.49"	24"	18,500 lb	1.76 lb
00680-250	2.50" to 2.99"	36"	24,500 lb	3.32 lb
00680-300	3.00" to 3.74"	36"	24,500 lb	3.33 lb
00680-350	3.75" to 4.24"	48"	31,000 lb	6.56 lb
00680-400	4.25" to 4.99"	48"	31,000 lb	7.64 lb

## Triple Weave, Single Eye, Shoulders

These grips offer a color-coded, flexible eye with shoulders and triple weave galvanized wire construction. The shoulders help to protect the leading edge of the cable or ducting and this type should be used for more demanding, heavy duty applications.



Part No.	Color Code	Size Range	Approximate Mesh Length	Approximate Breaking Strength	Weight
00681-006	Dark Green	0.25" to 0.49"	28"	6,500 lb	0.41 lb
00681-012	Brown	0.50" to 0.74"	33"	10,400 lb	0.79 lb
00681-019	Light Blue	0.75" to 0.99"	41"	16,000 lb	1.47 lb
00681-025	Gold	1.00" to 1.24"	51"	25,400 lb	3.46 lb
00681-032	Black	1.25" to 1.49"	60"	31,700 lb	4.11 lb
00681-038	Red	1.50" to 1.99"	75"	32,000 lb	4.81 lb
00681-048	Yellow	2.00" to 2.49"	75"	44,600 lb	8.12 lb

## Dual Wire, Double Weave, High Strength, Shoulders

These extra high strength grips feature a dual wire, double woven construction. This type of grip should be used for heavy duty applications such as overhead transmission wire. The color-coded grips are particularly suited to bare conductor and synthetic rope applications. When pulling rope of any kind, it may be difficult to feed the leading end of the rope into the grip and we recommend use of the Feed Tube (see page 32) to help with these situations.



Part No.	Color Code	Conductor Size Range	Rope Size Range	Approximate Mesh Length	Head Length	Approximate Breaking Strength	Weight
00695-019	Black	0.19" to 0.37"	0.25" to 0.65"	24"	10"	6,800 lb	0.61 lb
00695-038	Dark Green	0.38" to 0.62"	0.50" to 0.90"	36"	12"	14,500 lb	1.56 lb
00695-063	Red	0.63" to 0.87"	0.75" to 1.10"	48"	13"	21,500 lb	2.53 lb
00695-088	Dark Blue	0.88" to 1.12"	1.00" to 1.50"	60"	15"	32,000 lb	6.14 lb
00695-113	Yellow	1.13" to 1.37"	1.25" to 1.70"	76"	18"	48,000 lb	13.06 lb
00695-138	Aluminum	1.38" to 1.90"	1.50" to 2.10"	89"	24"	68,000 lb	19.87 lb

## Rotary Head Grips

The following two grips have a rotary head that can be fitted to a DCD Line Swivel (00505 series) for smooth rotation or linked to a shackle in the pulling string.

Please note that the rotating head does not replace the use of a Line Swivel. There are no bearings to allow rotation under load and severe damage may occur to the utility being installed if this product is used without the correct swivel. Select the appropriate swivel and safe working load based on your applied safety factors.

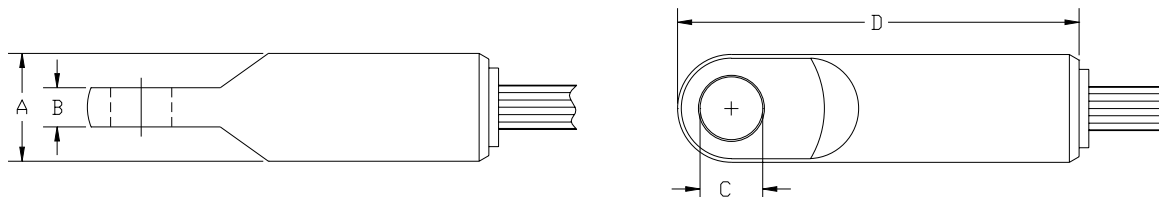

## Triple Weave, Rotary Head, Shoulders

These grips offer a stainless steel rotary head with color-coded shoulders and triple-weave galvanized wire construction for extra strength. The shoulders help to protect the leading edge of the cable or ducting and this type should be used for heavy duty applications.



Part No.	Color Code	Size Range	Approximate Mesh Length	A	B	C	D	Approximate Breaking Strength	Weight
00682-006	Dark Green	0.25" to 0.49"	28"	7/8"	5/16"	1/2"	2-3/4"	6,500 lb	0.53 lb
00682-012	Brown	0.50" to 0.74"	33"	1"	1/2"	9/16"	3-7/8"	10,400 lb	1.05 lb
00682-019	Light Blue	0.75" to 0.99"	41"	1"	1/2"	9/16"	3-7/8"	16,000 lb	1.54 lb
00682-025	Gold	1.00" to 1.24"	51"	1-3/8"	1/2"	11/16"	5-3/8"	25,400 lb	3.85 lb
00682-032	Black	1.25" to 1.49"	60"	1-5/8"	9/16"	7/8"	6-1/8"	31,700 lb	5.27 lb
00682-038	Red	1.50" to 1.99"	75"	1-7/8"	21/32"	1"	7-3/8"	33,000 lb	7.19 lb
00682-048	Yellow	2.00" to 2.49"	75"	1-7/8"	21/32"	1"	7-3/8"	44,600 lb	9.51 lb

## Double Weave, Rotary Head, Shoulders

These grips offer a stainless steel rotary head with double-weave galvanized wire construction for durability. The shoulders help to protect the leading edge of the cable or ducting and this type should be used for medium to heavy duty applications.



Part No.	Size Range	Approximate Mesh Length	A	B	C	D	Approximate Breaking Strength	Weight
00690-038	0.50" to 0.74"	16"	7/8"	5/16"	1/2"	2-3/4"	5,800 lb	0.49 lb
00690-050	0.75" to 1.12"	24"	7/8"	5/16"	1/2"	2-3/4"	6,700 lb	0.72 lb
00690-100	1.13" to 1.49"	33"	1-3/8"	1/2"	11/16"	5-3/8"	13,000 lb	2.31 lb
00690-125	1.50" to 1.99"	36"	1-3/8"	1/2"	11/16"	5-3/8"	16,500 lb	3.00 lb
00690-200	2.00" to 2.49"	36"	1-5/8"	9/16"	7/8"	6-1/8"	21,000 lb	4.27 lb
00690-250	2.50" to 2.99"	38"	1-7/8"	21/32"	1"	7-3/8"	33,000 lb	7.03 lb
00690-300	3.00" to 3.74"	39"	1-7/8"	21/32"	1"	7-3/8"	41,000 lb	7.29 lb
00690-350	3.75" to 4.24"	42"	1-7/8"	21/32"	1"	7-3/8"	48,000 lb	8.55 lb
00690-400	4.25" to 4.99"	58"	1-7/8"	21/32"	1"	7-3/8"	48,000 lb	10.88 lb

## Feed Tube for Rope (used with 00695 Series)

When pulling rope, this Feed Tube can be used to help feed the leading end of the rope into the grip. See page 30 for details on the 00695 Series.



Part No.	Rope Size Range	Tube Length	Weight
00696-019	0.25" to 0.65"	28"	0.94 lb
00696-038	0.50" to 0.90"	40"	2.32 lb
00696-063	0.75" to 1.10"	52"	2.71 lb
00696-088	1.00" to 1.50"	67"	5.65 lb
00696-113	1.25" to 1.70"	83"	9.20 lb
00696-138	1.50" to 2.10"	96"	10.28 lb

## Double Weave, Open Ends

These grips are open at both ends to splice rope or cable ends together (ex. for elevator or crane rope replacement) and have a double weave galvanized wire construction. The old cable may be attached to the new one and simply pulled through the blocks.



Part No.	Rope Size Range	Approximate Mesh Length	Approximate Breaking Strength	Weight
00697-010	0.38" to 0.74"	60"	4,100 lb	0.58 lb
00697-020	0.75" to 1.12"	60"	4,974 lb	0.83 lb

## Fiber Headboard

Originally intended for pulling OPGW cable, the Fiber Headboard is an anti-torsional device for applications in which you don't want rotation to occur. It incorporates a 00505-035 Line Swivel at the lead (pulling line) end, a 00520-035 Can-Link Connector at the tail (cable) end, and three dangling arms providing the torque stability required to prevent turning.

Part No.	Approximate Length	5:1 Safe Working Load	Weight
00698-035	20'	8,500 lb	180 lb

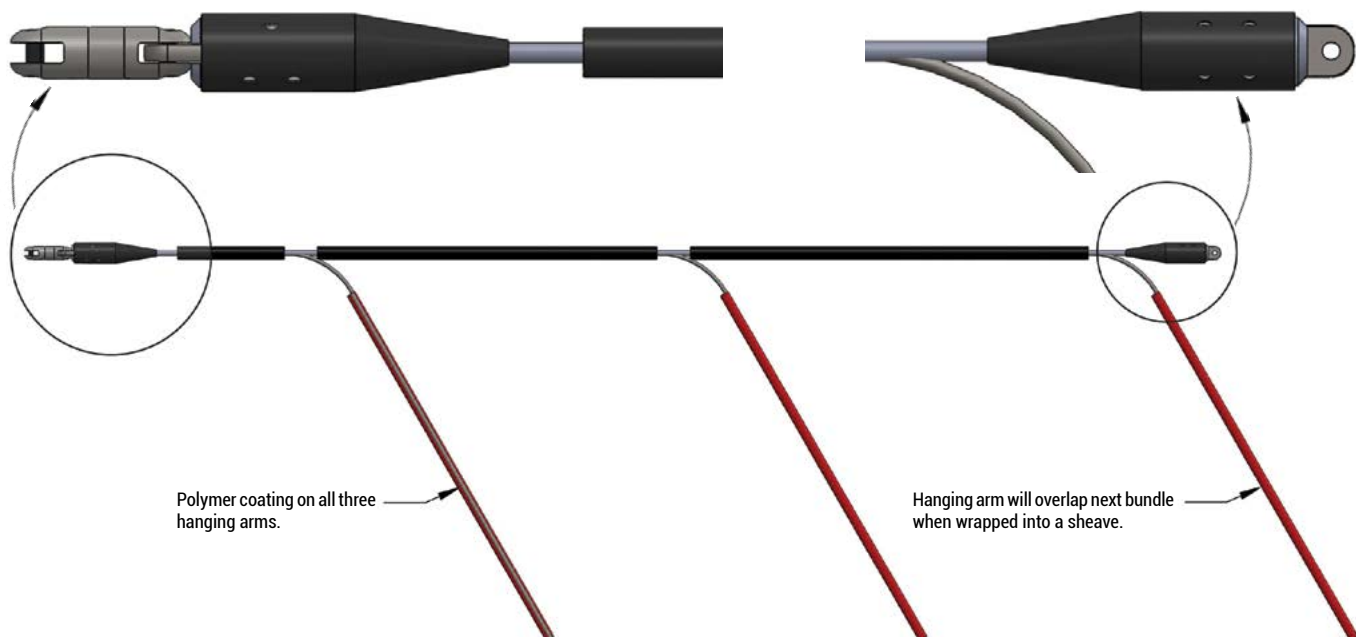

## Support Grips

Cable Support Grips are used for supporting any kind of cable in permanent installations. They can be used in either horizontal or vertical installations to relieve the cable weight from connections and fixtures. DCD grips are manufactured of durable galvanized steel wire for indoor or under cover installations. For installations exposed to weather, stainless steel versions are available for all types.

DCD offers three basic types of eye: single, double or offset. Each type is available in single weave for light duty applications, double weave for heavy duty applications, or lace-up weave when the cable end is not available for slipping the grip over. Support grips are produced on demand, particularly in stainless steel, except in some of the most common sizes. Typically, support grips are ordered in bulk for annual utility supply contracts. Please allow 8-10 weeks for delivery; some exceptions may apply. Contact Customer Service for availability.

Note: Always read breaking strength, safety, and technical data information. Approximate mesh length is measured at an average grip diameter. For stainless steel grips, reduce Approximate Breaking Strength by 10%.

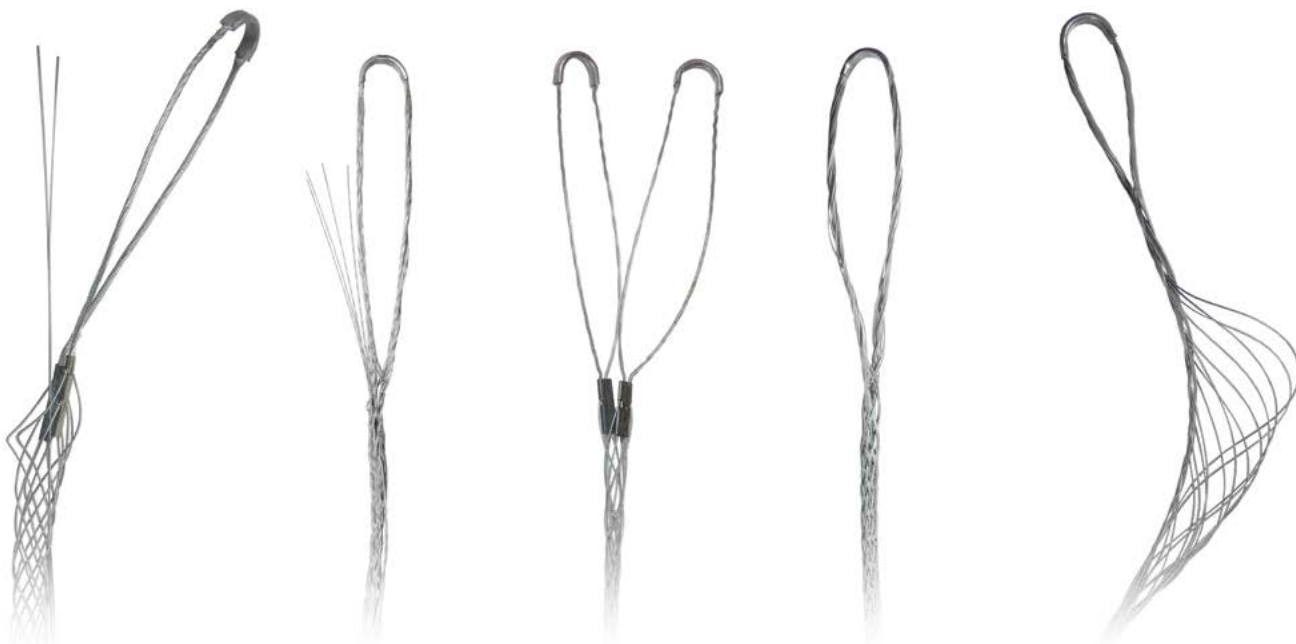

### Single Eye, Single Weave, Closed Mesh

For permanent installations, horizontal or vertical, where the cable end is available for assembly of the support grip.



Galvanized Part No.	Stainless Part No.	Size Range	Approximate Mesh Length	Approximate Breaking Strength	Weight
00800-016	00800-016S	0.15" to 0.24"	4"	350 lb	0.02 lb
00800-024	00800-024S	0.25" to 0.29"	4"	550 lb	0.03 lb
00800-031	00800-031S	0.30" to 0.39"	5"	900 lb	0.04 lb
00800-039	00800-039S	0.40" to 0.49"	5"	900 lb	0.04 lb
00800-051	00800-051S	0.50" to 0.62"	7"	900 lb	0.04 lb
00800-063	00800-063S	0.63" to 0.74"	10"	1,750 lb	0.11 lb
00800-079	00800-079S	0.75" to 0.99"	10"	2,100 lb	0.12 lb
00800-098	00800-098S	1.00" to 1.24"	13"	3,050 lb	0.19 lb
00800-118	00800-118S	1.25" to 1.49"	13"	3,050 lb	0.20 lb
00800-150	00800-150S	1.50" to 1.74"	15"	3,050 lb	0.21 lb
00800-173	00800-173S	1.75" to 1.99"	15"	4,050 lb	0.31 lb
00800-197	00800-197S	2.00" to 2.49"	19"	5,700 lb	0.55 lb
00800-252	00800-252S	2.50" to 2.99"	19"	5,700 lb	1.00 lb
00800-299	00800-299S	3.00" to 3.49"	19"	14,250 lb	1.10 lb
00800-350	00800-350S	3.50" to 3.99"	20"	14,250 lb	1.30 lb



## Double Eye, Single Weave, Closed Mesh

Fitted with a double eye, for permanent installations where the cable end is available for assembly of the support grip.



Galvanized Part No.	Stainless Part No.	Size Range	Approximate Mesh Length	Approximate Breaking Strength	Weight
00801-051	00801-051S	0.50" to 0.62"	7"	900 lb	0.05 lb
00801-063	00801-063S	0.63" to 0.74"	10"	1,750 lb	0.09 lb
00801-079	00801-079S	0.75" to 0.99"	10"	2,100 lb	0.11 lb
00801-098	00801-098S	1.00" to 1.24"	13"	3,050 lb	0.19 lb
00801-118	00801-118S	1.25" to 1.49"	13"	3,050 lb	0.19 lb
00801-150	00801-150S	1.50" to 1.74"	15"	3,050 lb	0.21 lb
00801-173	00801-173S	1.75" to 1.99"	15"	4,050 lb	0.35 lb
00801-197	00801-197S	2.00" to 2.49"	19"	5,700 lb	0.43 lb
00801-252	00801-252S	2.50" to 2.99"	19"	5,700 lb	1.01 lb
00801-299	00801-299S	3.00" to 3.49"	19"	14,250 lb	1.23 lb
00801-350	00801-350S	3.50" to 3.99"	20"	14,250 lb	1.32 lb

## Offset Eye, Single Weave, Closed Mesh

For permanent installations where the support point is offset and the cable end is available for assembly of the support grip.



Galvanized Part No.	Stainless Part No.	Size Range	Approximate Mesh Length	Approximate Breaking Strength	Weight
00802-051	00802-051S	0.50" to 0.62"	7"	900 lb	0.04 lb
00802-063	00802-063S	0.63" to 0.74"	10"	1,750 lb	0.09 lb
00802-079	00802-079S	0.75" to 0.99"	10"	2,100 lb	0.11 lb
00802-098	00802-098S	1.00" to 1.24"	13"	3,050 lb	0.16 lb
00802-118	00802-118S	1.25" to 1.49"	13"	3,050 lb	0.17 lb
00802-150	00802-150S	1.50" to 1.74"	15"	3,050 lb	0.18 lb
00802-173	00802-173S	1.75" to 1.99"	15"	4,050 lb	0.27 lb
00802-197	00802-197S	2.00" to 2.49"	19"	5,700 lb	1.01 lb
00802-252	00802-252S	2.50" to 2.99"	19"	5,700 lb	1.01 lb
00802-299	00802-299S	3.00" to 3.49"	19"	14,250 lb	1.10 lb
00802-350	00802-350S	3.50" to 3.99"	20"	14,250 lb	1.32 lb

## Single Eye, Double Weave, Closed Mesh

For heavy duty permanent installations, horizontal or vertical, where the cable end is available for assembly of the support grip.



Galvanized Part No.	Stainless Part No.	Size Range	Approximate Mesh Length	Approximate Breaking Strength	Weight
00820-039	00820-039S	0.38" to 0.74"	25"	5,800 lb	0.42 lb
00820-079	00820-079S	0.75" to 1.12"	25"	6,650 lb	0.60 lb
00820-118	00820-118S	1.13" to 1.49"	30"	10,000 lb	1.11 lb
00820-157	00820-157S	1.50" to 1.99"	34"	13,800 lb	1.50 lb

### Double Eye, Double Weave, Closed Mesh

Fitted with a double eye, for heavy duty permanent installations where the cable end is available for assembly of the support grip.



Galvanized Part No.	Stainless Part No.	Size Range	Approximate Mesh Length	Approximate Breaking Strength	Weight
00821-079	00821-079S	0.75" to 1.12"	25"	6,650 lb	0.60 lb
00821-118	00821-118S	1.13" to 1.49"	30"	10,000 lb	1.14 lb
00821-150	00821-150S	1.50" to 1.99"	34"	13,800 lb	1.64 lb
00821-197	00821-197S	2.00" to 2.49"	37"	15,000 lb	2.02 lb
00821-256	00821-256S	2.50" to 3.12"	43"	17,500 lb	3.45 lb
00821-315	00821-315S	3.13" to 3.74"	43"	18,000 lb	4.14 lb

### Single Eye, Single Weave, Split Mesh (Lace-up)

For permanent installations where the cable end is not available for assembly of the support grip, the support grip may be laced over the mid-span.



Galvanized Part No.	Stainless Part No.	Size Range	Approximate Mesh Length	Approximate Breaking Strength	Weight
00810-051	00810-051S	0.50" to 0.62"	5"	900 lb	0.05 lb
00810-063	00810-063S	0.63" to 0.74"	10"	1,750 lb	0.12 lb
00810-079	00810-079S	0.75" to 0.99"	10"	2,100 lb	0.15 lb
00810-098	00810-098S	1.00" to 1.24"	13"	3,050 lb	0.19 lb
00810-118	00810-118S	1.25" to 1.49"	13"	3,050 lb	0.22 lb
00810-150	00810-150S	1.50" to 1.99"	15"	3,050 lb	0.24 lb
00810-197	00810-197S	2.00" to 2.49"	19"	5,700 lb	0.57 lb
00810-252	00810-252S	2.50" to 2.99"	19"	5,700 lb	0.88 lb
00810-299	00810-299S	3.00" to 3.49"	19"	14,250 lb	1.10 lb
00810-350	00810-350S	3.50" to 3.99"	20"	14,250 lb	1.32 lb

### Double Eye, Single Weave, Split Mesh (Lace-up)

Fitted with a double eye, for permanent installations where the cable end is not available for assembly of the support grip, the grip may be laced over the mid-span.



Galvanized Part No.	Stainless Part No.	Size Range	Approximate Mesh Length	Approximate Breaking Strength	Weight
00811-051	00811-051S	0.50" to 0.62"	5"	900 lb	0.05 lb
00811-063	00811-063S	0.63" to 0.74"	10"	1,750 lb	0.12 lb
00811-079	00811-079S	0.75" to 0.99"	10"	2,100 lb	0.15 lb
00811-098	00811-098S	1.00" to 1.24"	13"	3,050 lb	0.21 lb
00811-118	00811-118S	1.25" to 1.49"	13"	3,050 lb	0.21 lb
00811-150	00811-150S	1.50" to 1.99"	15"	3,050 lb	0.24 lb
00811-197	00811-197S	2.00" to 2.49"	19"	5,700 lb	0.55 lb
00811-252	00811-252S	2.50" to 2.99"	19"	5,700 lb	0.88 lb
00811-299	00811-299S	3.00" to 3.49"	19"	14,250 lb	1.10 lb
00811-350	00811-350S	3.50" to 3.99"	20"	14,250 lb	1.32 lb

## Offset Eye, Single Weave, Split Mesh (Lace-up)

For permanent installations where the support point is offset and the cable end is not available for assembly of the support grip, the support grip may be laced over the mid-span.



Galvanized Part No.	Stainless Part No.	Size Range	Approximate Mesh Length	Approximate Breaking Strength	Weight
00812-051	00812-051S	0.50" to 0.62"	5"	900 lb	0.05 lb
00812-063	00812-063S	0.63" to 0.74"	10"	1,750 lb	0.09 lb
00812-079	00812-079S	0.75" to 0.99"	10"	2,100 lb	0.11 lb
00812-098	00812-098S	1.00" to 1.24"	13"	3,050 lb	0.17 lb
00812-118	00812-118S	1.25" to 1.49"	13"	3,050 lb	0.19 lb
00812-150	00812-150S	1.50" to 1.99"	15"	3,050 lb	0.19 lb
00812-197	00812-197S	2.00" to 2.49"	19"	5,700 lb	0.56 lb
00812-252	00812-252S	2.50" to 2.99"	19"	5,700 lb	1.01 lb
00812-299	00812-299S	3.00" to 3.49"	19"	14,250 lb	1.23 lb
00812-350	00812-350S	3.50" to 3.99"	20"	14,250 lb	1.32 lb

## Single Eye, Double Weave, Split Mesh (Lace-up)

For heavy duty permanent installations where the cable end is not available for assembly of the support grip, the support grip may be laced over the mid-span.



Galvanized Part No.	Stainless Part No.	Size Range	Approximate Mesh Length	Approximate Breaking Strength	Weight
00830-079	00830-079S	0.75" to 1.12"	25"	6,650 lb	0.62 lb
00830-118	00830-118S	1.13" to 1.49"	30"	10,000 lb	1.13 lb
00830-150	00830-150S	1.50" to 1.99"	34"	13,800 lb	1.72 lb

## Double Eye, Double Weave, Split Mesh (Lace-up)

Fitted with a double eye, for heavy duty permanent installations where the cable end is not available for assembly of the support grip, the support grip may be laced over the mid-span.



Galvanized Part No.	Stainless Part No.	Size Range	Approximate Mesh Length	Approximate Breaking Strength	Weight
00831-079	00831-079S	0.75" to 1.12"	25"	6,650 lb	0.61 lb
00831-118	00831-118S	1.13" to 1.49"	30"	10,000 lb	1.19 lb
00831-150	00831-150S	1.50" to 1.99"	34"	13,800 lb	1.87 lb
00831-197	00831-197S	2.00" to 2.49"	37"	15,000 lb	2.77 lb
00831-256	00831-256S	2.50" to 3.12"	39"	17,500 lb	3.68 lb
00831-315	00831-315S	3.13" to 3.74"	43"	18,000 lb	4.45 lb