

LIMITED ONE YEAR WARRANTY

Chaney Instrument Company warrants that all products it manufactures to be of good material and workmanship and to be free of defects if properly installed and operated for a period of one year from date of purchase. REMEDY FOR BREACH OF THIS WARRANTY IS EXPRESSLY LIMITED TO REPAIR OR REPLACEMENT OF DEFECTIVE ITEMS. Any product which, under normal use and service, is proven to breach the warranty contained herein within ONE YEAR from date of sale will, upon examination by Chaney, and at its sole option, be repaired or replaced by Chaney. In all cases, transportation costs and charges for returned goods shall be paid for by the purchaser. Chaney hereby disclaims all responsibility for such transportation costs and charges. This warranty will not be breached, and Chaney will give no credit for products it manufactures which shall have received normal wear and tear, been damaged, tampered, abused, improperly installed, damaged in shipping, or repaired or altered by others than authorized representatives of Chaney.

THE ABOVE-DESCRIBED WARRANTY IS EXPRESSLY IN LIEU OF ALL OTHER WARRANTIES, EXPRESS OR IMPLIED, AND ALL OTHER WARRANTIES ARE HEREBY EXPRESSLY DISCLAIMED, INCLUDING WITHOUT LIMITATION THE IMPLIED WARRANTY OF MERCHANTABILITY AND THE IMPLIED WARRANTY OF FITNESS FOR A PARTICULAR PURPOSE. CHANEY EXPRESSLY DISCLAIMS ALL LIABILITY FOR SPECIAL, CONSEQUENTIAL OR INCIDENTAL DAMAGES, WHETHER ARISING IN TORT OR BY CONTRACT FROM ANY BREACH OF THIS WARRANTY. SOME STATES DO NOT ALLOW THE EXCLUSION OR LIMITATION OF INCIDENTAL OR CONSEQUENTIAL DAMAGES, SO THE ABOVE LIMITATION OR EXCLUSION MAY NOT APPLY TO YOU. CHANEY FURTHER DISCLAIMS ALL LIABILITY FROM PERSONAL INJURY RELATING TO ITS PRODUCTS TO THE EXTENT PERMITTED BY LAW. BY ACCEPTANCE OF ANY OF CHANEY'S EQUIPMENT OR PRODUCTS, THE PURCHASER ASSUMES ALL LIABILITY FOR THE CONSEQUENCES ARISING FROM THEIR USE OR MISUSE. NO PERSON, FIRM OR CORPORATION IS AUTHORIZED TO ASSUME FOR CHANEY ANY OTHER LIABILITY IN CONNECTION WITH THE SALE OF ITS PRODUCTS. FURTHERMORE, NO PERSON, FIRM OR CORPORATION IS AUTHORIZED TO MODIFY OR WAIVE THE TERMS OF THIS PARAGRAPH, AND THE PRECEDING PARAGRAPH, UNLESS DONE IN WRITING AND SIGNED BY A DULY AUTHORIZED AGENT OF CHANEY. THIS WARRANTY GIVES YOU SPECIFIC LEGAL RIGHTS, AND YOU MAY ALSO HAVE OTHER RIGHTS WHICH VARY FROM STATE TO STATE.

For in-warranty repair, please contact:

Customer Care Department
Chaney Instrument Company
965 Wells Street
Lake Geneva, WI 53147

This device complies with part 15 of the FCC rules. Operation is subject to the following two conditions:

- 1- This device may NOT cause harmful interference, and
- 2- This device must accept any interference received, including interference that may cause undesired operation.

NOTE: This equipment has been tested and found to comply with the limits for a Class B digital device, pursuant to Part 15 of the FCC rules. These limits are designed to provide reasonable protection against harmful interference in a residential installation. This equipment generates, uses and can radiate radio frequency energy and, if not installed and used in accordance with the instructions, may cause harmful interference to radio communications. However, There is no guarantee that interference will not occur in a particular installation. If this equipment does cause harmful interference to radio or television reception, which can be determined by turning the equipment off and on, the user is encouraged to try to correct the interference by one or more of the following measures:

- Reorient or relocate the receiving antenna.
- Increase the separation between the equipment and the receiver.
- Connect the equipment into an outlet on a circuit different from that to which the receiver is connected.
- Consult the dealer or an experienced radio/TV technician for help.

NOTE: The manufacturer is not responsible for any radio or TV interference caused by unauthorized modifications to this equipment. Such modifications could void the user authority to operate the equipment.

ACURITE® is a registered trademark of the Chaney Instrument Co. Lake Geneva, WI

08510 INST 120211

ACURITE®
DESIGNED TO WORK FOR YOU™

**Public
Alert**



Weather Alert Radio
desktop model #08510

Instruction Manual

- 1** Introduction: About the Weather Alert Radio
- 3** Overview of Features

Section 1: Setup

- 6** Installing Batteries and Powering On
- 7** AC Power Adapter
- 9** Quick Setup
 - FIPS Code Entry, Channel Setup, Time zone, DST
 - Current Time Setting, Current Date Setting

Section 2: Using Your Weather Alert Radio

- 12** Reception
- 12** Listen Modes
- 13** Receiving Alerts
- 13** Silencing Alerts
- 13** Viewing Alert Message History
- 14** Volume Control, Backlight, Scroll Rate, Headphone Jack
- 15** Manual Setup
 - Edit FIPS Code, Edit Channel, Edit Time/Date, Edit Alerts
 - Language Selection

Section 3: Troubleshooting and Reference

- 17** Troubleshooting
- 18** Specifications
- 19** Reference: Alert Description Chart

Parts List desktop model #08510

- 1. Weather alert radio
- 2. AC power adapter

**Introduction**

The Acurite® Weather Alert Radio will receive encoded civil and weather emergency alert messages from the National Oceanic and Atmospheric Administration (NOAA) Weather Radio broadcast towers. These broadcast stations are located all over the United States. NOAA operates more than 1000 towers throughout the 50 states, Puerto Rico, the U.S. Virgin islands and in the U.S. Pacific Territories. This weather alert radio uses Specific Area Message Encoding (S.A.M.E) to identify specific areas, like a county or localized area of a state. This technology limits the occurrence of “false alarms”, that is, alert messages that do not apply to your area.

The Acurite® Weather Alert Radio will receive all 7 NOAA weather alert channels. When an official alert is received, the radio will automatically switch on and you will hear the tone and audio voice broadcast. The alert type and message will scroll across the display. One of the color-coded LED’s will also illuminate- signifying which type of message has been received; “Advisory” is yellow, “Watch” is orange and “Warning” is red.

The Weather Alert Radio includes an AC power adapter. The AC power adapter is the primary power source for the radio. In an emergency, you may need to take the radio with you to a safe area , the radio features a battery compartment for holding standard alkaline batteries (not included). This feature also provides backup power for the radio in the event of a power failure.

Please read through this manual to learn more about the Acurite® Weather Alert Radio. Keep this manual for future reference.

IMPORTANT!

This weather radio is NOT waterproof. To reduce the risk of fire, electric shock, or damage to the unit, do not expose this product to rain, moisture, or immerse in water.

This product has the capability to operate with three (3) 1.5v "AA" alkaline batteries (not included). Use of rechargeable batteries are not recommended. This radio does not NOT contain charging circuits and will NOT charge or supply power to the batteries.

To reduce the risk of electric shock, DO NOT disassemble or modify this product. Take this product to manufacturer authorized service personnel when service or repair work is required. Opening the case of the radio or the power dock/adaptor voids the warranty. This product contains NO user serviceable parts.

TEST YOUR SIGNAL RECEPTION BEFORE RELYING ON THIS DEVICE IN EMERGENCIES. RECEPTION of the national weather service TEST is the best way to ensure your radio will have proper reception during an emergency. The national weather service (NWS) conducts a required weekly test (RWT) of NOAA all hazards weather alert radios every Wednesday between 11 AM and 12 noon (central time), when weather permits.

The test consists of the RWT SAME code, a short tone and message explaining the test. If adverse weather prevents the test from being broadcast on Wed., it is postponed until the next day with good weather. If the test is not conducted by Friday, it is postponed until the following Wednesday.

Overview

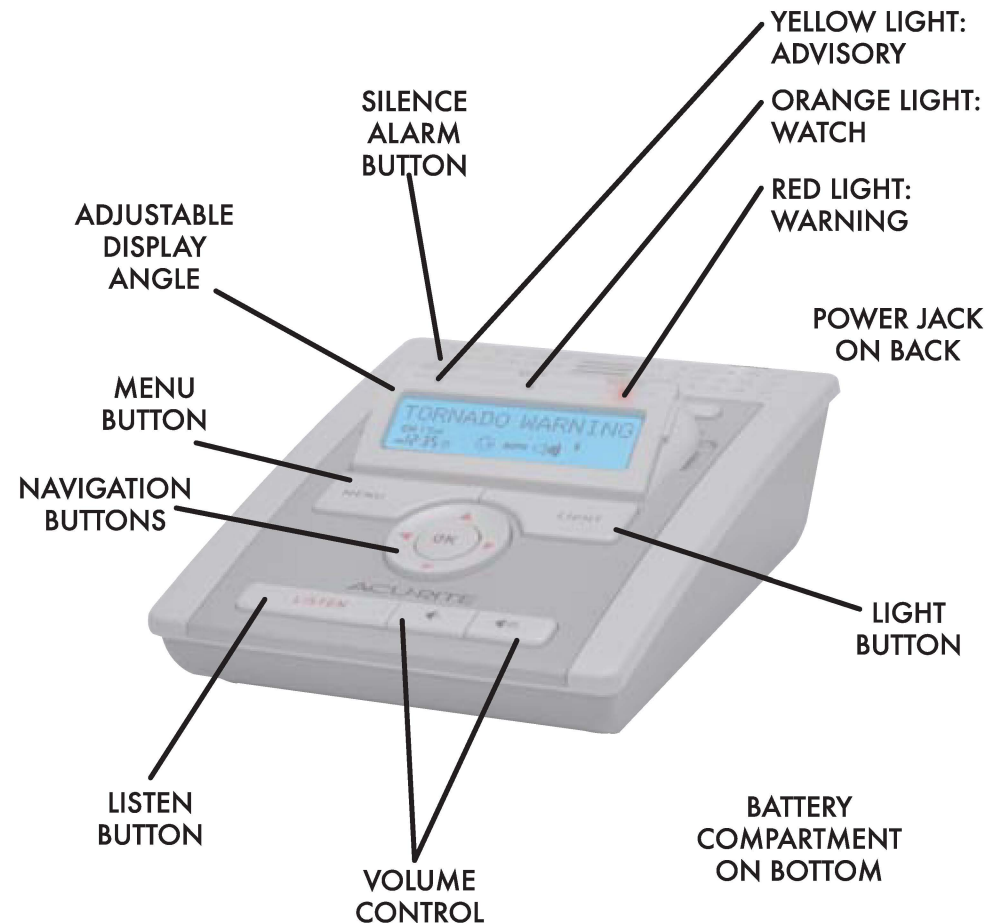

Display Features

DISPLAY BACKLIGHT

The LCD features a blue backlight for easy night viewing. The backlight is momentary when the radio is battery powered, and constant ON or OFF when AC powered with included AC power adapter.

SIGNAL STRENGTH INDICATOR

This gives you a reference to indicate the strength of the NOAA radio signal.

MESSAGE DISPLAY AREA

This area is used to display the type of alert and the specific alert issued, as well as the menu text area.

AC POWER INDICATOR

This icon indicates when the unit is AC powered.

LOW BATTERY INDICATOR

This icon indicates when the batteries inside the unit are running low.

MENU MODE INDICATOR

This icon indicates when you are in menu mode.

HISTORY MODE INDICATOR

This icon indicates when you are reviewing previous advisories, watches, or warnings.

CURRENT CHANNEL

Displays the currently selected channel. There are 7 total weather channel frequencies. The channel with the strongest reception is selected automatically in QUICK SETUP.

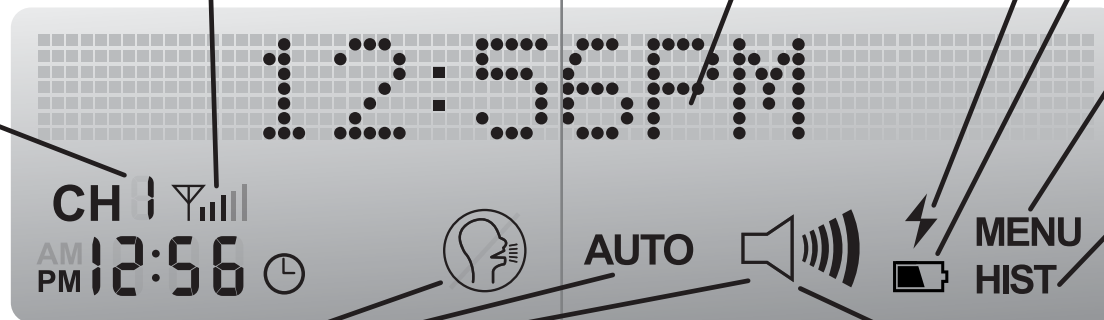

LISTEN MODE INDICATORS

One of three Listen Modes are selected by pressing the "LISTEN" button.



SILENCED: unit will not automatically sound audio alert to notify you to advisories or watches. **WARNINGS** will still sound audio alert to notify you, warnings cannot be silenced.



AUTO ON: unit will automatically sound audio to notify you of all advisories, watches, and warnings that it is programmed to receive.



ON: unit will display ON when you manually turn on the weather report.

VOLUME INDICATOR

The Volume Level is selected by pressing the "VOLUME" buttons located on the side of the unit.

SILENCED: the volume indicator is disabled when the radio is silenced. Unit will not automatically sound audio alert to notify you to advisories or watches. **WARNINGS** will still sound an audio alert to notify you, warnings cannot be silenced and will sound at a mandated high volume to ensure user hears the warning.

Installing Backup Batteries

REMOVE
BATTERY
COVER

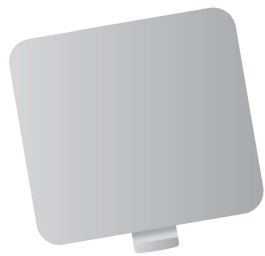

INSTALL THREE (3)
"AA" STANDARD
ALKALINE
BATTERIES



Bottom of radio shown

After installing batteries, the weather report audio will automatically turn on. If you wish to silence the weather report audio, press the "LISTEN" button.

NOTE: The power adapter is the main power source for this weather radio. The batteries provide backup power in the event of a power outage and allow you to move quickly and take your radio with you to a safe location during an emergency.

The internal radio is always "listening" for alerts, even when the audio speaker is silenced. This requires substantial power, as a result, the weather radio will last approximately 3 days on battery power alone.

Power Adapter

After powering on the radio and choosing placement, you will need to plug-in the power adapter to supply main power to the Weather Radio. Note the "⚡" icon will display - indicating the radio is plugged in and powered by the AC adapter.

AC adapter

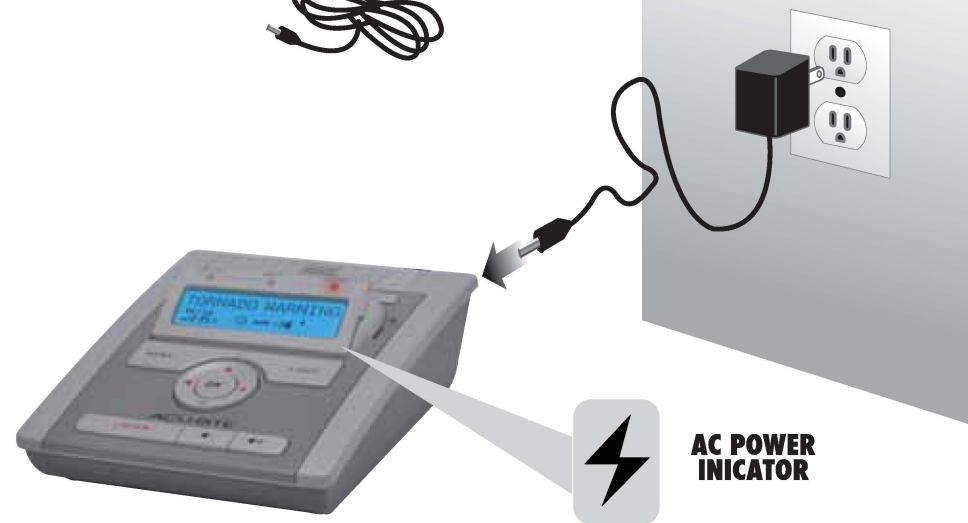
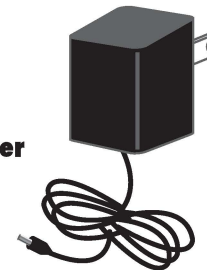

BATTERY SAFETY: Clean the battery contacts and also those of the device prior to battery installation. Remove batteries from equipment which is not to be used for an extended period of time. Follow the polarity (+/-) diagram in the battery compartment. Promptly remove dead batteries from the device. Dispose of used batteries properly. Only batteries of the same or equivalent type as recommended are to be used. DO NOT incinerate used batteries. DO NOT dispose of batteries in fire, as batteries may explode or leak. DO NOT mix old and new batteries or types of batteries (alkaline/standard). DO NOT use rechargeable batteries. DO NOT recharge non-rechargeable batteries. DO NOT short-circuit the supply terminals.

Setup

After powering on the radio, your radio is ready to receive emergency alerts from the national weather service. It is recommended that your specific radio location code (FIPS code) be entered, which will limit any "false alarms" (alerts that do not apply to your location) from being activated. Additionally, you will need to set your preferences- such as the date and time.

The easiest way to ensure that all of your preferences are set is to go through the "Quick Setup" process. This only takes a few minutes to complete.

If you have more experience with weather alert radios, you may wish to manually enter multiple FIPS location codes and manually select your channel, the "Manual Setup" mode will allow you to do this.

NOTE: All FIPS codes entered will remain in the radio, even if the radio power is interrupted due to dead batteries and no power. To clear all the entered codes and reset the radio to factory settings, refer to the troubleshooting section in this manual.



Please DO NOT return product to the retail store.
For technical assistance and product return information, please call
Customer Care: **877-221-1252** Mon. - Fri. 8:00 A.M. to 4:30 P.M. (CST)

www.acurite.com

Quick Setup

After powering on the radio, you will need to set your preferences. Most basic preferences can be set by going through the Quick Setup process.

To access the Quick Setup menu, press the "MENU" button on the radio. The display will show "< SELECT >". To select the Quick Setup menu, navigate right by pressing the "▶" navigation button. Press "OK" to enter into Quick Setup. You may exit the menu at any time by pressing the "MENU" button.

1. FIPS Code Entry

To find your SAME# (FIPS code), call the national weather service toll free at **1-888-NWS-SAME** (1-888-697-7263) or visiting the website below.

www.weather.gov/nwr/indexnw.htm#sametable

MY FIPS CODE _____

The NOAA weather radio transmission is coded with Specific Area Message Encoding (S.A.M.E.). **SAME** allows you to customize the alerts to warn you about conditions only relevant to your specific area, which will reduce unwanted alerts. **SAME** is activated automatically after you enter in your **FIPS** code.

A Federal Information Processing System, or **FIPS** code is a six digit code that identifies your state and county/parish in the United States. The default selection for the FIPS code is "000000" which allows the radio to respond to all advisories, watches, and warnings. To customize the alerts you receive to your specific area, you will need to enter your location's FIPS code.

To enter your code, press the "▲" or "▼" navigation buttons to adjust the currently selected (flashing) digit. Press the "▶" or "◀" navigation buttons to move to select the digit you would like to adjust.

Press the "OK" button once you are finished entering your 6 digit location code (SAME#/FIPS code)

2. Channel Setup

After you enter your FIPS code, the display will read "FIPS CODE SET" and will automatically move on to "CHANNEL SETUP - PRESS OK TO SCAN". After you press OK, the radio will automatically scan for the strongest channel available. The display will read "SEARCHING".

After scanning, the display will read "THE STRONGEST SIGNAL IS CHANNEL _". This is the channel that the radio has determined offers the best signal strength.

3. Time zone

After your radio has acquired the strongest channel, the quick setup process will automatically move on to "ENTER TIME ZONE". To enter your time zone, press the "▼" or "▲" navigation buttons to find your time zone. Press the "OK" button to confirm your selection.

4. Daylight Saving Time (DST) Observance

After you set your time zone, the quick setup process will automatically move on to Daylight Saving Time setting. The display will read "DST ON", press the "▼" or "▲" navigation buttons to select either "ON" or "OFF" to select whether daylight saving time is observed in your area. Press the "OK" button to confirm your selection.

5. Enter Current Time

After you set your time zone, the quick setup process will automatically move on to Current Time setting. The display will read "12:00AM" by default. The hour needs to be set first, press "▼" or "▲" buttons to adjust the hour, then press the "▶" button to move over to setting the minutes. Again, press the "▼" or "▲" buttons to adjust the minutes, then press the "▶" navigation button to move over to setting AM or PM. Press the "▼" or "▲" buttons to select "AM" or "PM". Press the "OK" button to confirm your selection.

6. Current Date

After you enter your current time the quick setup will automatically move on to setting the date. The display will read "MONTH 01". Adjust the month by pressing the "▼" or "▲" navigation buttons, press "OK" to confirm your selection.

Next, you will need to set the date by pressing the "▼" or "▲" navigation buttons to adjust, press "OK" to confirm your selection.

Finally, you will need to enter the YEAR by pressing the "▼" or "▲" buttons to adjust, press "OK" to confirm your selection.

The Quick Setup Process Is Now Complete

The quick setup process is now complete, the display will read "SETUP COMPLETE" and revert back to the default clock display on the home screen.

Placement

It is critical to choose a placement location where the radio can receive the emergency alert signal broadcast, such as near a window on an outside wall. To quickly check your radio reception throughout your home, simply turn on the radio by pressing the "LISTEN" button repeatedly until you hear the speaker turn on.

You may also want to place the radio in a location you are most likely to hear the alert tone or see the alert indicator lights.

Keep the radio away from other electronic interference sources such as computer monitors and TV's, other radios, motors, microwaves, etc. This radio is designed for tabletop placement, place the unit on a level dry surface away from moisture.

Using Your Weather Radio

Reception

The reception icon will show full bars if the reception is optimal, press the "LISTEN" button to manually check and listen to how good your reception is. If you do not have good reception, you may need to relocate the radio to an outside wall near a window.

RECEPTION of the WEEKLY TEST is the best way to ensure your radio will have proper reception during an emergency. The national weather service (NWS) conducts a required weekly test (RWT) of NOAA all hazards weather alert radios every Wednesday between 11 AM and 12 noon (central time), when weather permits.

The test consists of the RWT SAME code, a short tone and message explaining the test. If adverse weather prevents the test from being broadcast on Wed., it is postponed until the next day with good weather. If the test is not conducted by Friday, it is postponed until the following Wednesday.

Listen Modes

The weather radio has three modes for handling alerts and listening to the weather report. Pressing the "LISTEN" button toggles between modes.

SILENCED: when the display shows "  ", the only AUDIO alerts you will receive will be WARNINGS. Advisories and watch alerts will still message on the display, and the LED will illuminate, but the audio report will not play.

AUTO ON: when the display reads "AUTO", the audio report will play for ALL advisories, watches and warnings that it is programmed to respond to. Additionally, the alert message will scroll on the display, and the LED will illuminate.

LISTEN: when the display shows "   ", the audio weather report is ON.

Receiving Alerts

If the radio is set to "AUTO", when any alert (advisory, watch or warning) is issued by the NWS, the radio will automatically turn on, and the audio weather report will sound. Additionally, a text readout of the type of alert (advisory, watch or warning) will scroll across the display and the appropriate alert light will illuminate.

Silencing Alerts

When an alert is sounding, press the "SILENCE ALARM" button to silence the tone. Please note that if you leave the radio in silenced mode, the audio report and siren for advisories and for watches will NOT sound. Only WARNINGS will sound as they cannot be silenced in any way, as mandated by NOAA.

Viewing Alert Message History

The weather alert radio will hold up to 4 messages in it's memory at a time, in sequence of when they were received.

To view the messages in history, press the "▲" or "▼" navigation buttons when the radio is showing the default clock display to cycle through history of the last 4 messages received. The HISTORY (HIST) mode indicator will display to confirm you are looking at an older alert message.

If there have been no messages received, the display will read "NO MESSAGES"

NOTE: if there are no messages in the history, and the radio has been under continuous power, you may have a reception issue. Please refer to the troubleshooting section.

Volume Control

The volume control buttons are located on the front of the radio. 1 of 10 volume levels are shown in the volume indicator icon on the display. NOTE that the volume will automatically increase to loudest when an actual WARNING has been received, as per NOAA radio requirements.

Backlight

The radio includes a blue backlight to illuminate the display for easy low-light viewing. The backlight will activate automatically for 10 seconds with every button press.

The backlight can be constant ON or OFF when AC powered using the included AC power adapter. Press the "LIGHT" button to turn the backlight ON or OFF. NOTE that the display backlight AND indicator LED's will automatically come on when an alert is received.

Changing the Scrolling Text Rate

The message area scrolling speed can be adjusted to scroll at a slower or faster rate. When the radio is showing the default clock display, press the "▶" navigation button. "SCROLLING RATE _" will appear on the display. Press the "▲" or "▼" to choose 1, 2, or 3 scrolling rate (3 being the fastest). Press the "OK" button to confirm your selection.

Telescopic Antenna

The Weather Alert Radio features an integrated telescopic antenna which can be orientated to receive the signal better. This antenna is NOT removable, but can be folded and "stowed" onto the back of the radio housing for storage or travel convenience.

Headphone Jack

The Weather Alert Radio features a small 3.5mm (standard) headphone jack on the top edge of the radio housing. You may choose to plug in any standard pair of headphones or external powered speakers to hear the weather report.

Manual Setup

Most basic preferences can be set by going through the Quick Setup process. The manual setup offers more advanced options.

To access the Manual Setup menu, press the "MENU" button on the radio. The display will show "< SELECT >". To select the Manual Setup menu, navigate left by pressing the "◀" navigation button. Press "OK" to enter into Manual Setup. Note that you may exit the menu by pressing the "MENU".

Once in manual setup menu, scroll through setting options by pressing the "▶" or "◀" buttons. Press "OK" to confirm your selection. The Manual Setup options are: EDIT FIPS CODE, EDIT CHANNEL, EDIT TIME/DATE, EDIT ALERTS, LANGUAGE SETUP.

1. Edit FIPS Code

If you wish to edit your previously entered SAME# or FIPS code, this is where you may do so. Press the "OK" button to edit your FIPS code.

To edit your code, press the "▲" or "▼" navigation buttons to adjust the currently selected (flashing) digit. Press the "▶" navigation button to move to the right to adjust the next digit.

Press the "OK" button once you are finished editing your 6 digit location code (SAME#/FIPS code)

The display will then read "ADD ANOTHER FIPS CODE". Because NOAA transmission areas overlap, you may want to set more than one S.A.M.E location. This is especially true if you live near the border of a county-you may want to receive alerts from both. If you wish to add another FIPS code, use the "▲" or "▼" navigation buttons to choose "YES". Press "OK" to confirm your selection. Enter in up to 10 total FIPS codes into memory in the same manner you entered your first FIPS code, using the navigation buttons.

NOTE: Entering FIPS codes only allows the radio to receive the alerts that are being transmitted from your local station. Entering a code from a distant state WILL NOT allow you to receive alert messages from that state.

2. Edit Channel

Enter into "EDIT CHANNEL" If you wish to manually select a channel. The display will read "SELECT CHANNEL _", press the "▲" or "▼" navigation buttons to select one of the seven NOAA broadcast channels.

If you wish to select your recommended channel, visit the NOAA website and review the table to find the correct weather band channel for your area. Find your state, and then search the list for your county.

www.nws.noaa.gov/nwr/index.htm

3. Edit Time/Date

To edit the time zone, DST preference, Time, and Date, enter into "EDIT TIME/DATE." Use the navigation buttons to adjust each selection and the "OK" button to confirm your selections. (refer to page 10 for more details on time and date settings).

4. Edit Alerts

Your Acurite Weather Alert Radio gives you the ability to fine tune which alerts you want to be notified of. Enter into "EDIT ALERTS" menu to remove or add specific advisories or watches you want to be notified of.

When in the Edit alert menu, an alert message will scroll across the display. Press the "▲" button to toggle the alert on (bell icon  shown for ON status) or off (no bell icon shown for OFF status)

Warnings cannot be turned off, but are shown so you can get a complete picture of which alerts you will receive. Please look over the "Alert Description Chart" in the back section of this manual for more information on the available alerts.

5. Language

To select English, Spanish or French language for alert text, use the navigation buttons to make your selection and press "OK" to confirm your language selection.

Problem	Possible Solution
No Power	<p>Make sure the AC power adapter is securely plugged into the radio and then wall socket. The "⚡" indicator icon will display to confirm radio is being powered by the AC power adapter.</p> <p>Make sure batteries are fresh in case AC power fails. If the radio is being powered by batteries alone, note that the batteries will only last approximately 3 days.</p>
No Sound From Speaker	<p>Check that the volume is adjusted up to an audible level. If any external speaker/headphones are plugged into the headphone jack, the main speaker is bypassed and will NOT sound until external speaker/headphones are unplugged.</p>
Poor Weather Report Reception	<p>Relocate the radio or reorientate the antenna for better reception.</p> <p>Make sure the radio is located near an external wall window for best reception. If you are in a weak reception area, you will need to pay special attention that the radio is placed near a window and at a high placement for best reception possible.</p> <p>Ensure that the radio is set to the correct channel for proper reception. You may need to change the channel. Refer to Quick Setup: Channel Setup (page 10) to automatically re-scan for the strongest channel.</p> <p>Contact the NWS to make certain they are currently broadcasting.</p>
The radio is not responding to weather alerts	<p>Make sure you have programmed in the correct S.A.M.E# (FIPS code) for your area. Contact the NWS to make certain they are currently broadcasting.</p>
<p>TO RESET RADIO TO FACTORY DEFAULTS: press the "◀", "▶" and "LISTEN" buttons at the same time and select "YES". NOTE: You will then need to remove and re-insert the batteries for the RESET to take effect.</p>	

SPECIFICATIONS

Batteries: 3 x "AA" (not included)

AC Adapter: output 4.5 V DC
(AC/DC Power Adapter included)

AC Power input: 4.5 V DC

Channels: Digital PLL tuning for
7 NOAA channels

RF reception range: ~50 miles (80 km)

Channel 1 - 162.400 Mhz

Channel 2 - 162.425 Mhz

Channel 3 - 162.450 Mhz

Channel 4 - 162.475 Mhz

Channel 5 - 162.500 Mhz

Channel 6 - 162.525 Mhz

Channel 7 - 162.550 Mhz

Voice output: 77dB/1m { 1KHZ }

Sensitivity: { -5dB }

Size: H 2.0" x W 5.5" x D 6.5"



Please DO NOT return product to the retail store.
For technical assistance and product return information, please call
Customer Care: **877-221-1252** Mon. - Fri. 8:00 A.M. to 4:30 P.M. (CST)

www.acurite.com

PRODUCT REGISTRATION

To receive product updates
and information, Go to

www.AcuRite.com

SUPPORT

- Support Forum
- Archived Products
- ▶ Register a Product

REFERENCE

Alert Description Chart

The following table lists the alert codes and the associated alert message broadcast by NOAA, as well as the alert type. Alert on default is also listed as ALERT ON (YES) or ALERT OFF (NO) from the factory.

NOAA Code	ALERT ON DEFAULT	ALERT TYPE	ALERT MESSAGE
ADR	NO	Advisory	Administrative Message
AVA	NO	Watch	Avalanche Watch
AVW	YES	Warning	Avalanche Warning
BHW	YES	Warning	Biological Hazard Warning
BWW	YES	Warning	Boil Water Warning
BZW	YES	Warning	Blizzard Warning
CAE	NO	Advisory	Child Abduction Emergency
CDW	YES	Warning	Civil Danger Warning
CEM	YES	Warning	Civil Emergency Message
CFA	NO	Watch	Coastal Flood Watch
CFW	YES	Warning	Coastal Flood Warning
CHW	YES	Warning	Chemical Hazard warning
CWW	YES	Warning	Contaminated Water Warning

NOAA Code	ALERT ON DEFAULT	ALERT TYPE	ALERT MESSAGE
DBA	NO	Watch	Dam Watch
DBW	YES	Warning	Dam Break Warning
DEW	YES	Warning	Contagious Disease Warning
DMO	NO	Advisory	Practice - Demo
DSW	YES	Warning	Dust Storm Warning
EAN	YES	Warning	Emergency Action Notification
EAT	YES	Advisory	Emergency Action Termination
EQW	YES	Warning	Earthquake Warning
EVA	NO	Watch	Evacuation Watch
EVI	YES	Warning	Immediate Evacuation
FCW	YES	Warning	Food Contamination Warning
FFA	NO	Watch	Flash Flood Watch
FFS	NO	Advisory	Flash Flood Statement
FFW	YES	Warning	Flash Flood Warning
FLA	NO	Watch	Flood Watch
FLS	NO	Advisory	Flood Statement

NOAA Code	ALERT ON DEFAULT	ALERT TYPE	ALERT MESSAGE
FLW	YES	Warning	Flood Warning
FRW	YES	Warning	Fire Warning
FSW	YES	Warning	Flash Freeze Warning
FZW	YES	Warning	Freeze Warning
HLS	NO	Advisory	Hurricane Statement
HMW	YES	Warning	Hazardous Materials Warning
HUA	NO	Watch	Hurricane Watch
HUW	YES	Warning	Hurricane Warning
HWA	NO	Watch	High Wind Watch
HWW	YES	Warning	High Wind Warning
IBW	YES	Warning	Iceberg Warning
IFW	YES	Warning	Industrial Fire Warning
LAE	YES	Advisory	Local Area Emergency
LEW	YES	Warning	Law Enforcement Warning
LSW	YES	Warning	Land Slide Warning
NAT	NO	Advisory	National Audible Test

NOAA Code	ALERT ON DEFAULT	ALERT TYPE	ALERT MESSAGE
NIC	NO	Advisory	National Information Center
NMN	NO	Advisory	Network Notification Message
NPT	NO	Advisory	National Periodic Test
NST	NO	Advisory	National Silent Test
NUW	YES	Warning	Nuclear Power Plant Warning
POS	NO	Advisory	Power Outage Advisory
RHW	YES	Warning	Radiological Hazard Warning
RMT	NO	Advisory	Required Monthly Test
RWT	YES	Advisory	Required Weekly Test
SMW	YES	Warning	Special Marine Warning
SPS	NO	Advisory	Special Weather Statement
SPW	YES	Warning	Shelter In - Place Warning
SVA	NO	Watch	Severe Thunderstorm Watch
SVR	YES	Warning	Severe Thunderstorm Warning
SVS	NO	Advisory	Severe Weather Statement
TOA	NO	Watch	Tornado Watch

NOAA Code	ALERT ON DEFAULT	ALERT TYPE	ALERT MESSAGE
TOE	NO	Advisory	911 Telephone Outage Emergency
TOR	YES	Warning	Tornado Warning
TRA	NO	Watch	Tropical Storm Watch
TRW	YES	Warning	Tropical Storm Warning
TSA	YES	Watch	Tsunami Watch
TSW	YES	Warning	Tsunami Warning
TXB	NO	Advisory	Transmitter Backup On
TXF	NO	Advisory	Transmitter Carrier Off
TXO	NO	Advisory	Transmitter Carrier On
TXP	NO	Advisory	Transmitter Primary On
VOW	YES	Warning	Volcano Warning
WFA	NO	Watch	Wild Fire Watch
WFW	YES	Warning	Wild Fire Warning
WSA	NO	Watch	Winter Storm Watch
WSW	YES	Warning	Winter Storm Warning
??A	NO	Watch	Unrecognized Watch

NOAA Code	ALERT ON DEFAULT	ALERT TYPE	ALERT MESSAGE
??E	NO	Advisory	Unrecognized Emergency
??S	NO	Advisory	Unrecognized Statement
??W	YES	Warning	Unrecognized Warning



S.A.M.E.
Specific Area Message Encoding



To find your SAME# (FIPS code), call the national weather service toll free at **1-888-NWS-SAME** (1-888-697-7263) or visiting the website below.

www.weather.gov/nwr/indexnw.htm#sametable

IMPORTANT NOTICE

Have questions about product setup or operation? We're here to help!

24/7 Support: www.acurite.com

- › Product Setup & Demo Videos
- › Product Manuals
- › Frequently Asked Questions
- › Register your Product
- › Support Forum
- › Submit Feedback & Ideas

EMAIL:
info@chaney-inst.com

TOLL FREE:
(877) 221-1252
7:00 a.m. - 7:00 p.m. CST

1-Year Warranty
Don't forget! Register your product at: www.acurite.com

COUNTY#/FIPS CODE RECORD

use this area to keep a record of the codes you enter into your radio

COUNTY - CODE - CHANNEL

PRODUCT REGISTRATION

To receive product updates and information, Go to

www.AcuRite.com

