

020-0900

## Remote Inside Release

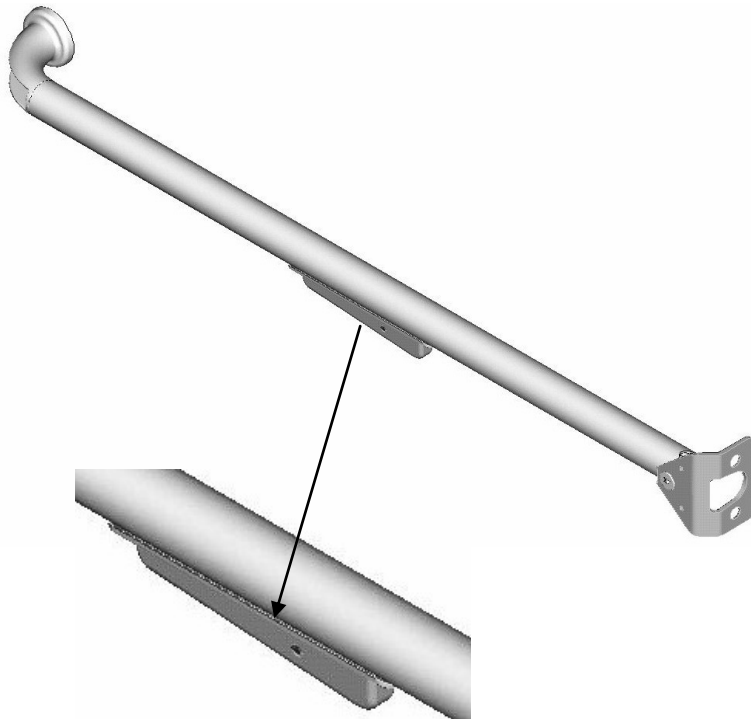

### **DESIGNED FOR:**

- Medium to heavy weight doors for off-highway vehicle applications
- Doors where it is desirable to have the inside release remotely located to the latch location

### **FEATURES/BENEFITS:**

- Robust designed remote inside release is incorporated into round tubing which gives additional door structure support and assistance for the opening and closing functions of the door
- Provides for greater ease of operation (ergonomics). The inside release can be positioned at any point along the tube for convenient location to suit the door/cab design over direct lever releases
- The inside release is connected by a rod to the latch and includes an integrated return spring
- The cam detail in the inside release is reversible allowing the inside release to be actuated in the opposite direction providing flexibility in the product application



[www.trimarkcorp.com](http://www.trimarkcorp.com)

### **TriMark Corporation**

500 Bailey Avenue  
P.O. Box 350  
New Hampton, Iowa 50659  
United States  
Tel: 641-394-3188  
Fax: 641-394-2392  
1-800-447-0343  
[www.trimarkcorp.com](http://www.trimarkcorp.com)

10002707 QM08 ISO 9001: 2008  
10002707 TS09 ISO/TS 16949: 2009



TriMark Corporation

### **TriMark Europe**

Cedar Court  
Walker road  
Bardon Hill  
Coalville LE67 1TU  
United Kingdom  
Tel: +44(0)1530 512460  
Fax: +44(0)1530 512461  
[www.trimarkeu.com](http://www.trimarkeu.com)

427961 QM08 ISO 9001 : 2008  
427961 UM ISO 14001 : 2004



TriMark Europe Ltd.

### AVAILABLE:

- As an inside release sub-assembly for installation into your door tube. (Note: Requires TriMark application assistance and approval.)
- In 25mm steel tubing diameters, painted black
- In different tubing lengths with various inside release positions and 90 degree mounting end
- Inside release with tube is adaptable to several different latch platforms
- Customization is available including formed tubing (please inquire)
- As a complete modular system including exterior handle, direct release latch, latch striker, inside release, gaskets, mounting brackets, latch cover, door tube and all necessary fasteners

### MATERIAL/FINISH:

- Inside release components: glass reinforced nylon
- Tubing: painted steel
- Mounting end: glass-reinforced nylon with brass threaded insert

### INSTALLATION:

- Easy to install - can be provided with tubing pre-fastened to latch that requires a single fastener at the mounting end to secure the assembly to the door or the inside release can be supplied as a sub-assembly that easily installs into your door tube
- Tubing assembly - installs with a single M6 X 1.0 bolt. Glass mounting is also possible with available mushroom window fixing designed for 5-6mm glass thickness. Recommended mounting fastener torque to be 3.3 - 4.5N-m (30-40 lbf-in)
- The inside release sub-assembly installs without tools into the pipe and includes a flange that covers the tubing cutout

Individual part dimensions are for reference only. Refer to individual part drawings for complete dimensions, specifications, and installation procedures. Engineering assistance and application drawings are available.

**CAUTION:** Inside release does not meet the locking requirements for FMVSS 206.

**U.S. Patent No. 7,198,308 and 7,111,879**

