

## VT27 VT40

### Torque up to 1.32Nm

- **Basic clutch to be insert into a hub**
- Protects equipment in case of excess torque
- Max. backlash 2°
- Max. sliding velocity: 1000 rpm
- The housing t° should be maintained below 80°C
- Power dissipation at 20°C :
  - 2 discs : 7 watts
  - 6 discs : 8.6 watts
- Materials:
  - Hubs + discs: treated steel
  - Casing + adjuster ring: aluminium



### Advantages

- Clutches interrupt rotation when load being transmitted exceeds preset limit.

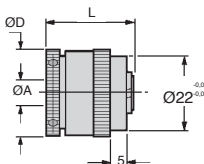

VT2 With set screw

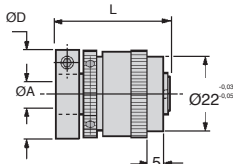

VT4 With clamp fixing

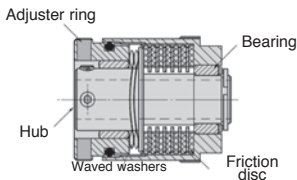

Pulley (Or gear, etc...) bonded to register. Press fits not permissible.

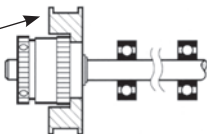

### DISCOUNTS

Qty	1+	5+	10+	15+	20+	25+
Disc.	List	-15%	-20%	-25%	-30%	On request

Part number	Std.	ØA <sup>+0.03</sup> <sub>-0.00</sub>	N° of friction discs	ØD	L	Screw	Heat dissipation at 20°C (Watts)	Max. frictional torque (Nm)	Moment of inertia (kgm <sup>2</sup> x 10 <sup>1</sup> )	Price each 1 to 4
<b>With set screw</b>										
VT2712-6	6	2	25,8	26,4	M3	7,0	0,53	242	✓	70,62 €
VT2712-8	8	2	25,8	26,4	M3	7,0	0,53	242	✓	70,62 €
VT2796-6	6	6	25,8	32,4	M3	8,6	1,32	312	✓	83,72 €
VT2796-8	8	6	25,8	32,4	M3	8,6	1,32	312	✓	83,72 €
<b>With locking jaw</b>										
VT4012-6	6	2	25,8	34,4	M3	7,0	0,53	317	✓	79,64 €
VT4012-8	8	2	25,8	34,4	M3	7,0	0,53	317	-	79,64 €
VT4096-6	6	6	25,8	40,7	M3	8,6	1,32	381	✓	91,56 €
VT4096-8	8	6	25,8	40,7	M3	8,6	1,32	381	✓	91,56 €

\*Depending on availability - Dimensions in mm

Torque up to 1.32Nm

VTA2  
VTA6

- Adjustable clutch coupling
- Max. backlash 2°
- Max. sliding velocity: 1000 rpm
- The housing t° should be maintained below 80°C
- Equipped with an Oldham coupling
- Materials:
  - Hub: Aluminium 6082
  - Disc: Black acetal

*Equipped with coupling*



## Uses

- 2 waved washers are fitted to these clutches
- These clutches are fitted with two washers. In some applications better torque control can be achieved by removing one of them.

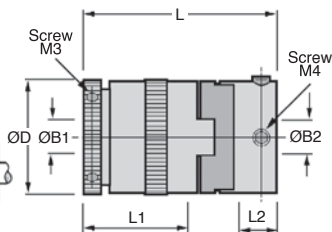
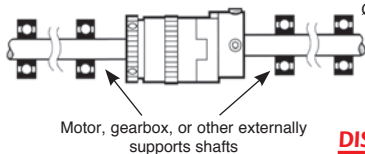

## DISCOUNTS

Qty	1+	5+	10+	15+	20+	25+
Disc.	List	-15%	-20%	-25%	-30%	On request

Part number	$\begin{matrix} +0.03 \\ -0.00 \end{matrix}$ ØB1	$\begin{matrix} +0.03 \\ -0.00 \end{matrix}$ ØB2	L	ØD	Max. shaft length L1	Max. shaft length L2	Heat dissipation at 20°C (Watts)	Max. frictional torque (Nm)	Stock*	Price each 1 to 4
<b>2 discs</b>										
VTA2-0606	6	6	46,50	25,8	25	8,60	7,0	0,53	✓	98,92 €
VTA2-0608	6	8	46,50	25,8	25	8,60	7,0	0,53	✓	98,92 €
VTA2-0610	6	10	46,50	25,8	25	8,60	7,0	0,53	-	98,92 €
VTA2-0806	8	6	46,50	25,8	25	8,60	7,0	0,53	-	98,92 €
VTA2-0808	8	8	46,50	25,8	25	8,60	7,0	0,53	✓	98,92 €
VTA2-0810	8	10	46,50	25,8	25	8,60	7,0	0,53	✓	98,92 €
<b>6 discs</b>										
VTA6-0606	6	6	53,40	25,8	31	8,60	8,6	1,32	-	112,09 €
VTA6-0608	6	8	53,40	25,8	31	8,60	8,6	1,32	-	112,09 €
VTA6-0610	6	10	53,40	25,8	31	8,60	8,6	1,32	-	112,09 €
VTA6-0806	8	6	53,40	25,8	31	8,60	8,6	1,32	-	112,09 €
VTA6-0808	8	8	53,40	25,8	31	8,60	8,6	1,32	✓	112,09 €
VTA6-0810	8	10	53,40	25,8	31	8,60	8,6	1,32	✓	112,09 €

\*Depending on availability - Dimensions in mm