

Jaw coupling, **economy range**



GET-AL Torque range from 2.6 to 380 Nm

- **Rigid in torsion**
- Especially suitable for transmitting torque
- Maintenance free
- Low wearing
- 3 part construction
- Absorbs vibration
- Constant velocity
- Electrically insulating
- Materials:
 - Hub: Aluminium
 - Spider: Polyamide 94 Shore A
- Working temp range: -30 to 140 °C



Economical range

Bores

- To be finished by the user

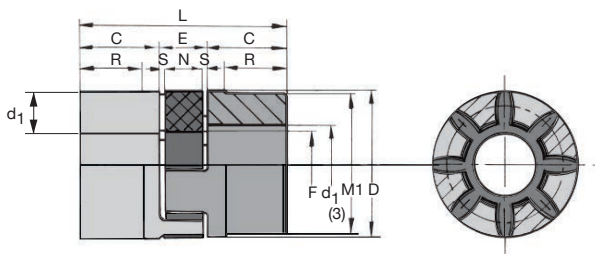

Part number	Pre-bore	Max bore d1	C	ØD	E	ØF	ØM1	N	R	S	L	Weight (kg)	
												Spider	Hub
GET-AL-24B	10	24	25	40	16	18	40	12	19	2	66	0,005	0,08
GET-AL-32B	14	32	30	55	18	27	55	14	24	2	78	0,014	0,18
GET-AL-38B	16	38	35	65	20	30	65	15	27,5	2,5	90	0,025	0,30
GET-AL-45B	20	45	45	80	24	38	78	18	36,5	3	114	0,042	0,55

Dimensions in mm

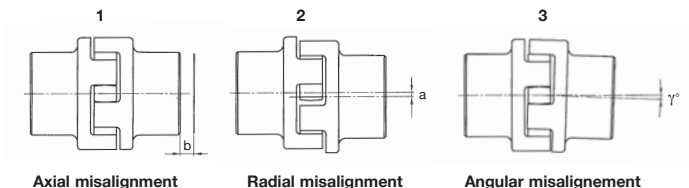

Part number	Torsional rigidity (kNm/rad)			
	1,0 Tk n	0,75 Tk n	0,5 Tk n	0,25 Tk n
GET-AL-24B	0,68	0,57	0,44	0,28
GET-AL-32B	2,19	1,82	1,40	0,90
GET-AL-38B	5,20	4,31	3,32	2,12
GET-AL-45B	10,00	8,30	6,39	4,08

DISCOUNTS

Qty	1+	5+	10+	25+
Disc.	List -6%	List -12%	On request	

Part number	Moment of inertia kg.cm ²	Max torque t/min	Torque (Nm)			Misalignment			Price each 1 to 4
			Nominal Tk n	Max Tk max	Alternating Tk w	axial b	radial a	angular γ°	
GET-AL-24B	0,4	14000	10	20	2,6	1,2	0,2	1,2	18,97 €
GET-AL-32B	1,0	10600	35	70	9	1,4	0,2	0,9	25,36 €
GET-AL-38B	3,0	8500	95	190	25	1,5	0,25	0,9	36,62 €
GET-AL-45B	8,0	7100	190	380	49	1,8	0,28	1,0	57,32 €

Dimensions in mm

Rotex® jaw coupling



RTE 

Torque: 2 to 4800Nm

- Maintenance free
- 3 part construction
- Max torsion angle 5°
- Materials:
 - Hub: Aluminium, steel or cast iron
 - Spider: Polyurethane (92 Shore A)
- Working temp. -40°C to +100°C
- Bore (tolerance H7) and keyway acc DIN6885/1-J59
- Axial plug-in assembly
- **Bores are not finished**

Absorbs shocks



Options

- Modification to bore sizes at additional cost (H7 tolerance and keyway acc DIN6885/1-J53)

Info.

- *Except for non-bored or pre-bored couplings

 **STANDARD BORES IN STOCK**

set screw and keyway fixing*

Part number	Material	Pre-bore ØA	Standard ØA	Optional ØA	ØD	ØG	K	E	S	b	L	M	ØB
RTE-A-14	Aluminium	Full	14	6 8 9 10 11 12 15	30	30	11	13	1,5	10	35	0	10
RTE-A-19	Aluminium	Full	14,19	10 11 12 15 16	32	41	25	16	2,0	12	66	20	18
			-	20 24	41	41	25	16	2,0	12	66	20	18
RTE-SL-19	Steel	Full	25	10 11 12 14 15 16 18 19 20 24	40	40	25	16	2,0	12	66	-	18
RTE-A-24	Aluminium	Full	15,19	14 15 16 18 19 20 24	40	56	30	18	2,0	14	78	24	27
			-	25 28	56	56	30	18	2,0	14	78	24	27
RTE-SL-24	Steel	Full	-	14 15 16 18 19 20 22 24 25 28	55	55	30	18	2,0	14	78	-	27
RTE-A-28	Aluminium	Full	20,25	14 16 18 19 22 24 28	48	67	35	20	2,5	15	90	28	30
			-	30 35 38	67	67	35	20	2,5	15	90	28	30
RTE-SL-28	Cast iron	Full	30	14 15 16 18 19 20 22 24 25 28 32 35 38	65	65	35	20	2,5	15	90	-	30
RTE-GG-38	Cast iron	Full	-	16 18 19 20 22 24 25 28 30 32 35 38	66	80	45	24	3,0	18	114	37	38
			-	40 42	78	80	45	24	3,0	18	114	37	38
RTE-GG-42		Full	-	30 32 35 38 40 42	75	95	50	26	3,0	20	126	40	46
RTE-GG-48		Full	-	25 30 32 35 38 40 42 45 48	85	105	56	28	3,5	21	140	45	51
RTE-GG-55	Cast iron	18	-	30 32 35 38 40 42 45 48 50 55	98	120	65	30	4,0	22	160	52	60
RTE-GG-65		20	-	40 45 48 50 55 60 65	115	135	75	35	4,5	26	185	47	68
RTE-GG-75		28	-	40 45 48 50 55 60 65 70 75	135	160	85	40	5,0	30	210	53	80
RTE-GG-90		38	-	50 55 60 65 70 75 80 85 90	160	200	100	45	5,5	34	245	62	100

Dimensions in mm

