

LANCASTER®

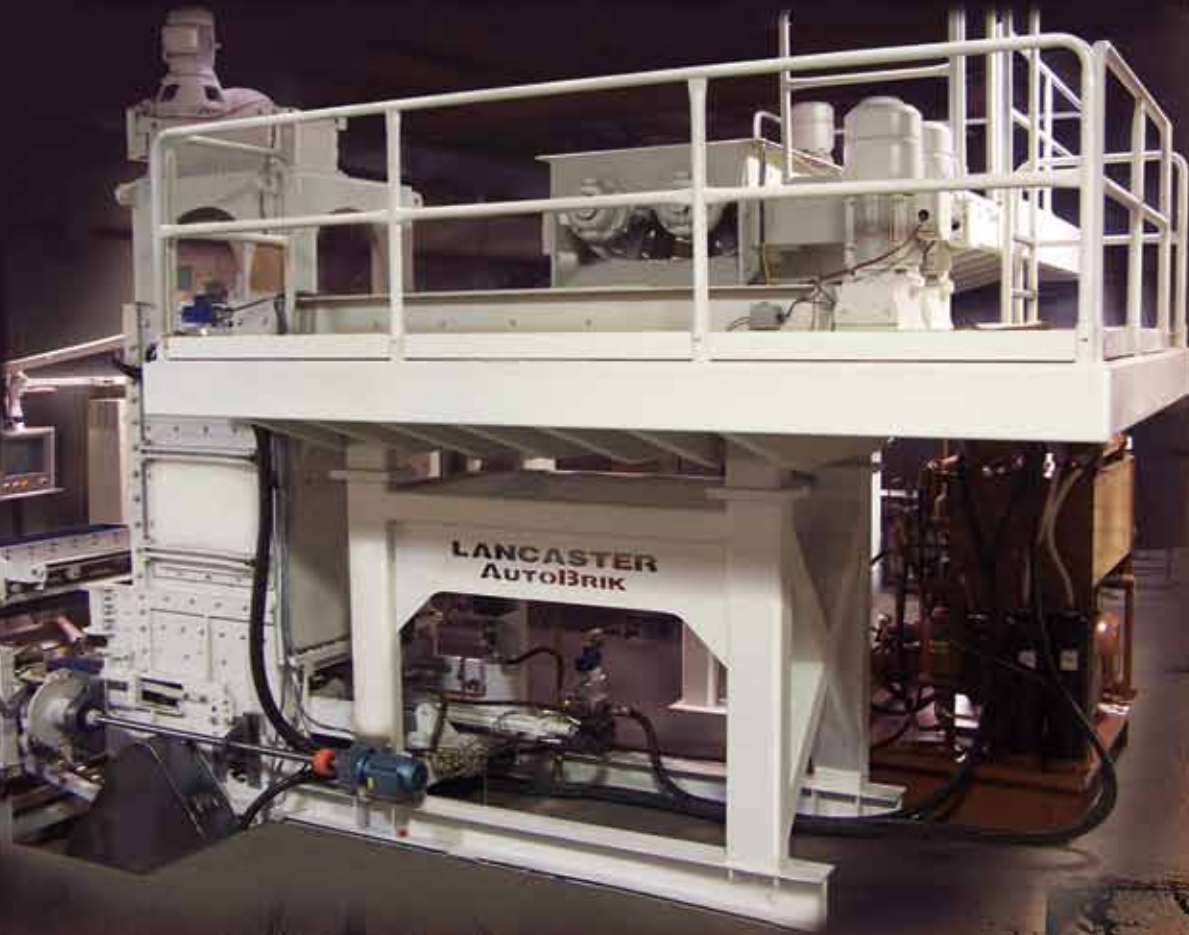

Lancaster AutoBrik Machines® are currently producing approximately 80% of the molded brick in the North American market of water-struck and sand molded brick.

Kercher Industries, Inc. is now producing the Lancaster AutoBrik Machine Model 46H Production System® for our standard soft mud brick production line. This new design has reduced the maintenance costs and improved the total operating efficiencies

of the Lancaster AutoBrik Machine Production System®. These improvements have been made while still maintaining the molded brick style that brick markets have come to appreciate and that brick producers have found so profitable for over 150 years.

The complete Lancaster AutoBrik Machine Production System® is under the control of an Allen Bradley/Siemens PLC based Lancaster Control System®. The new system has PLC controlled linear hydraulic action for the press, the pushout, and the demolding system. Individual VFD motor action have replaced the single source mechanical power of previous designs.

The Lancaster AutoBrik Machines® have come a long way since Henry Martin introduced the original design in Massachusetts in 1858. We at Kercher Industries, Inc. are very proud to continue this tradition. The new Lancaster AutoBrik Machine Production System® provides a world-class production system while still holding true to the old tradition of rugged equipment built to operate day in and day out under brick plant conditions, producing the world's finest molded brick.

LANCASTER® AUTOBRIK MACHINE MODEL 46H

LANCASTER® AUTOBRIK MACHINE MODEL 46H SYSTEM

- Fewer mechanical parts/improved design = lower costs.
- Varied range of brick styles produced via control recipes.
- Machine operational rates up to 18,000 bricks per hour
- Mold box size to 11.5"x 4.4"x 47.6", (29cm x 11cm x 121cm).
- 24 molds for production: 12 molds-producing, 12 molds-washing.
- Molds washed only every 0.5 to 4 hours of production.
- Integrated raw material, additives, and moisture control.
- SEW gear drives w/vfd controls, encoders, and over-force protection.
- Pistons have position sensing and over-force sensing.
- Oversized 1200 rpm hyd. pumps = lower noise levels/less pump wear.
- Triple mixing: 2-twin shaft pugmills, 1-single shaft vertical pugmill.
- Original "Posey" bumpers w/operator timing and force control.
- Integrated sand feeder.
- Automatic central lubrication system.
- User-friendly full process touch-screen control.
- Easy operator control adjustments = more production, higher quality.
- Total system weight = 70,000 pounds, (32,000 kg).

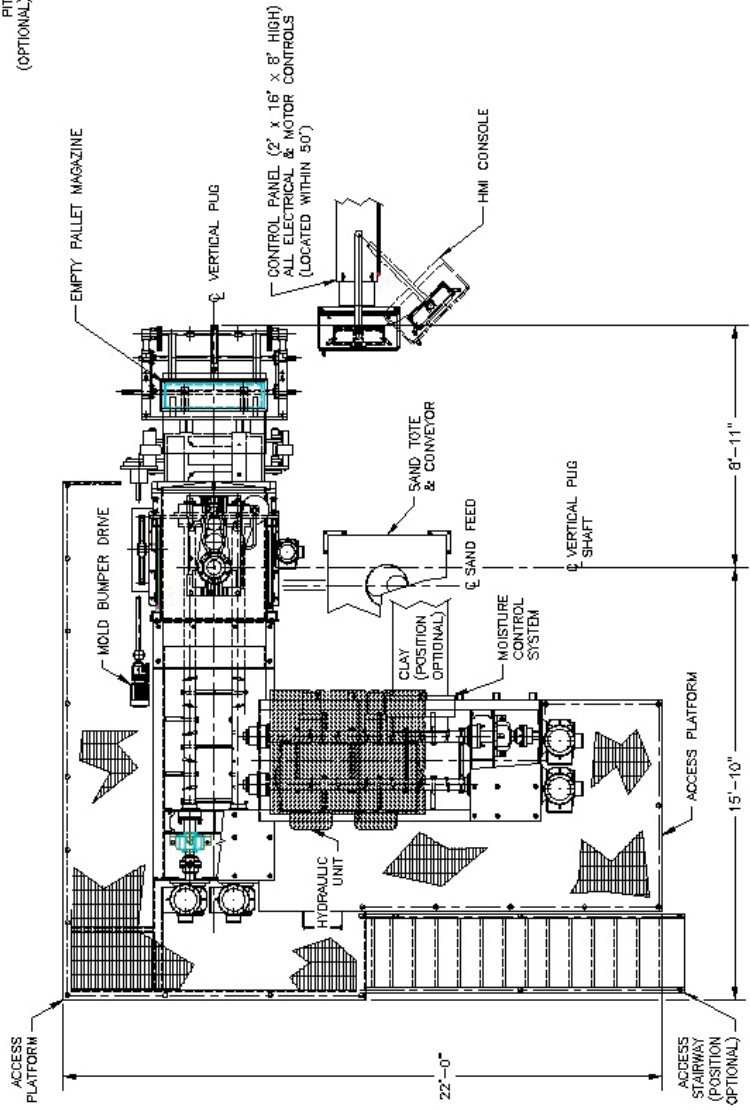
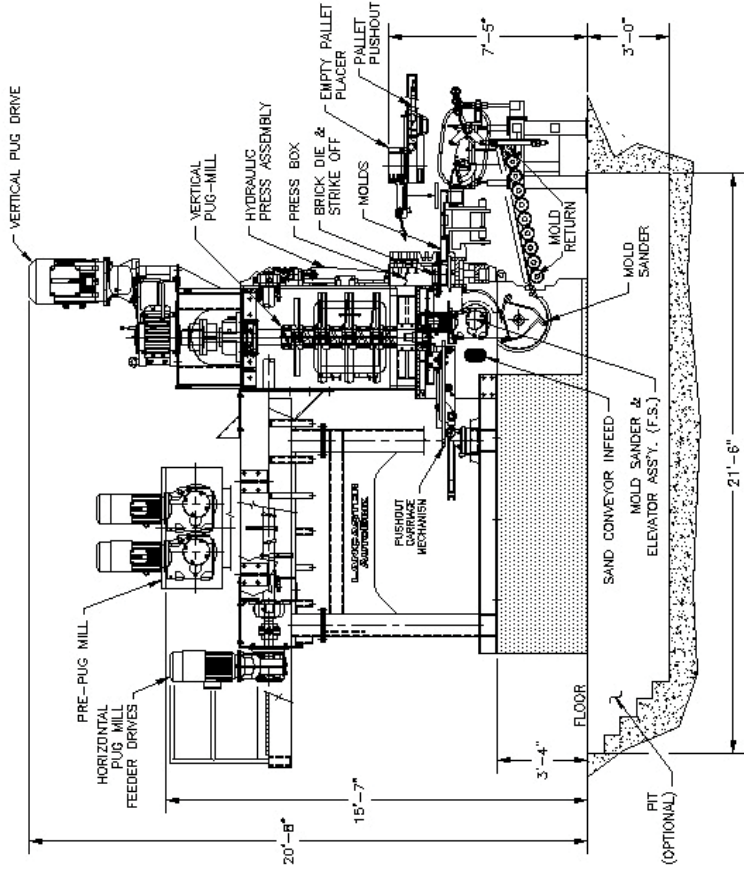

Also available for Quality Special Shapes and
Small Production Runs:
The Lancaster AutoBrik Machine Model 24H

LANCASTER®
PRODUCTS
“Built Brick Yard Tough!”

Mfd. by Kercher Industries, Inc.
920 Mechanic Street • Lebanon, PA 17046 USA
tel: 717-273-2111 fax: 717-273-2967
e-mail: info@lancasterprd.com www.lancasterprd.com