



BROKEN TOOL DETECTOR TYPE 202



APPLICATIONS

The broken tool detectors type 202 are used to detect a break of tool or a parts presence or absence.

Each cycle, the detector needle contacts the tool to sense its presence.



TECHNICAL CHARACTERISTICS

-Technology	Pneumatic - linear
-Stroke	90°
-Min. diameter tool	0,8 mm
-Max. distance / tool axis	80 mm
-Response time	50 ms
-Pressure required	4 bars minimum
-Operating temperature	+10°C - +60°C

ACCESSORIES

- Short fixing screw..... >REF: **0102VFTCX1**
- Long fixing screw..... >REF: **0102VFTLX1**
- Hard chromium plated needles..... >REF: **202TPGCHD**

DIMENSIONS

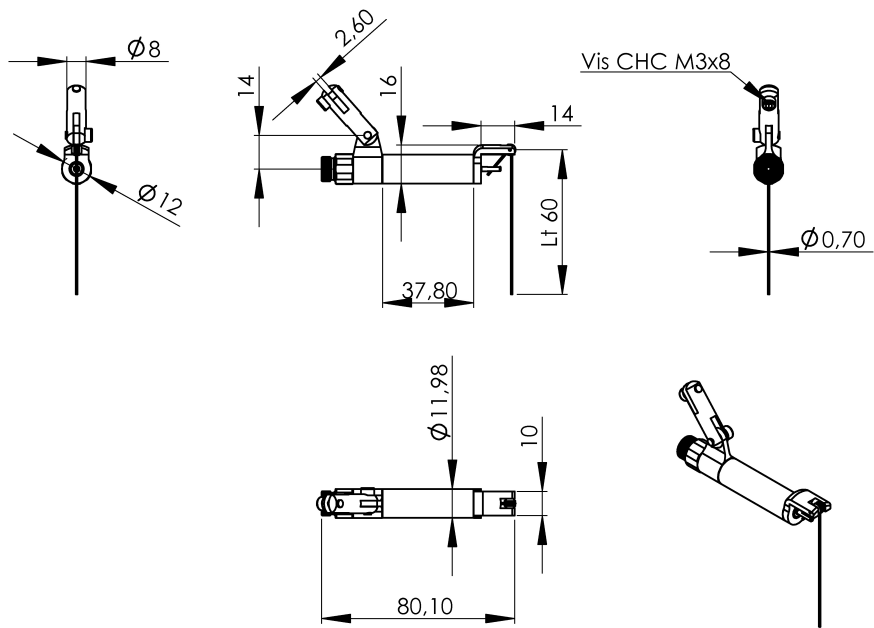

APPLICATIONS

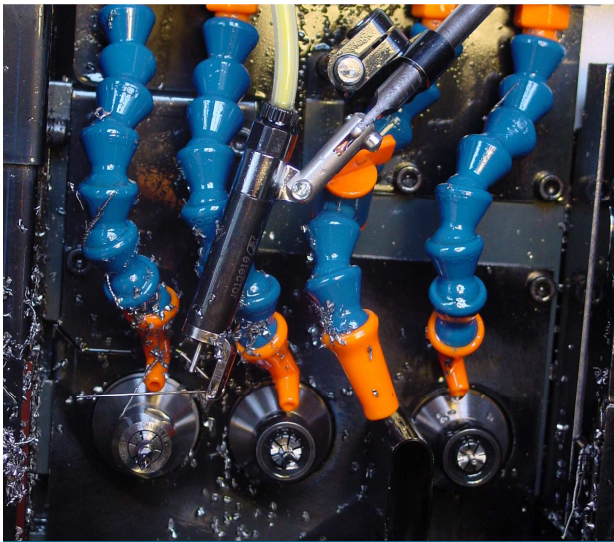

202 - Esco Newmac

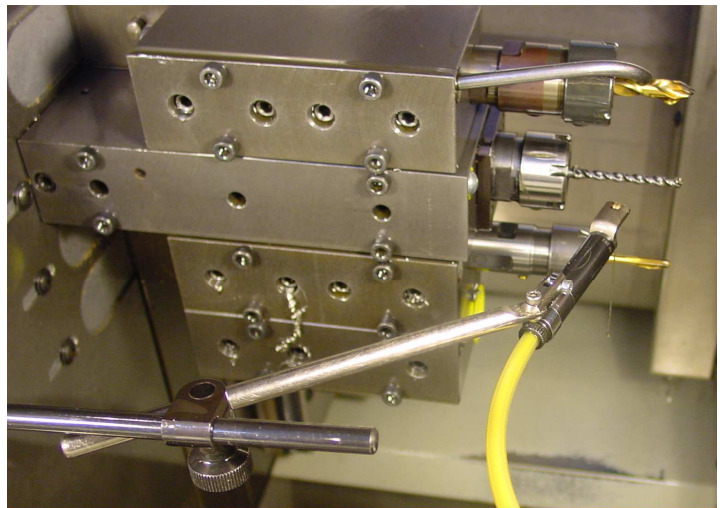

202 - Tornos DECO2000