

PARTS LIST

CP-607-PL

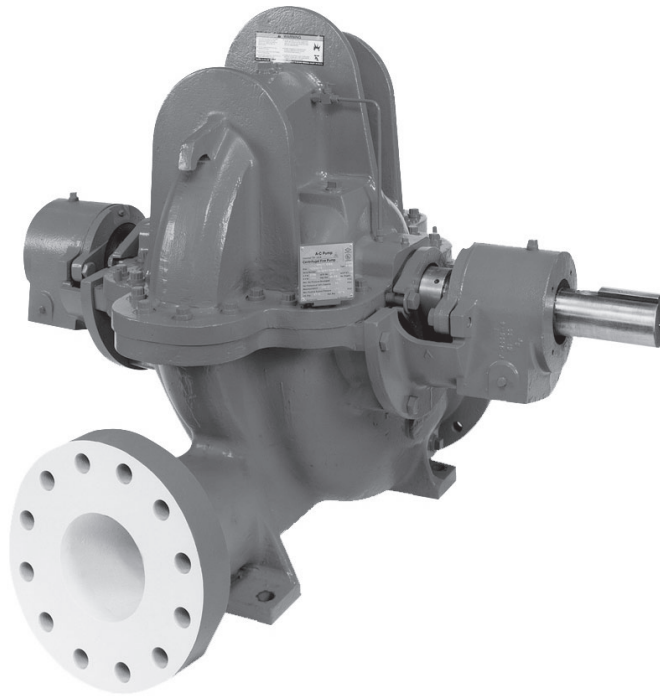

Series 9100

Replacement Parts for 9100 Series Fire Pumps

AC FIRE
PUMP
a xylem brand



INDEX

PAGE	DESCRIPTION
3	Cross Section
4	Parts List

SERIES 9100 CROSS SECTION

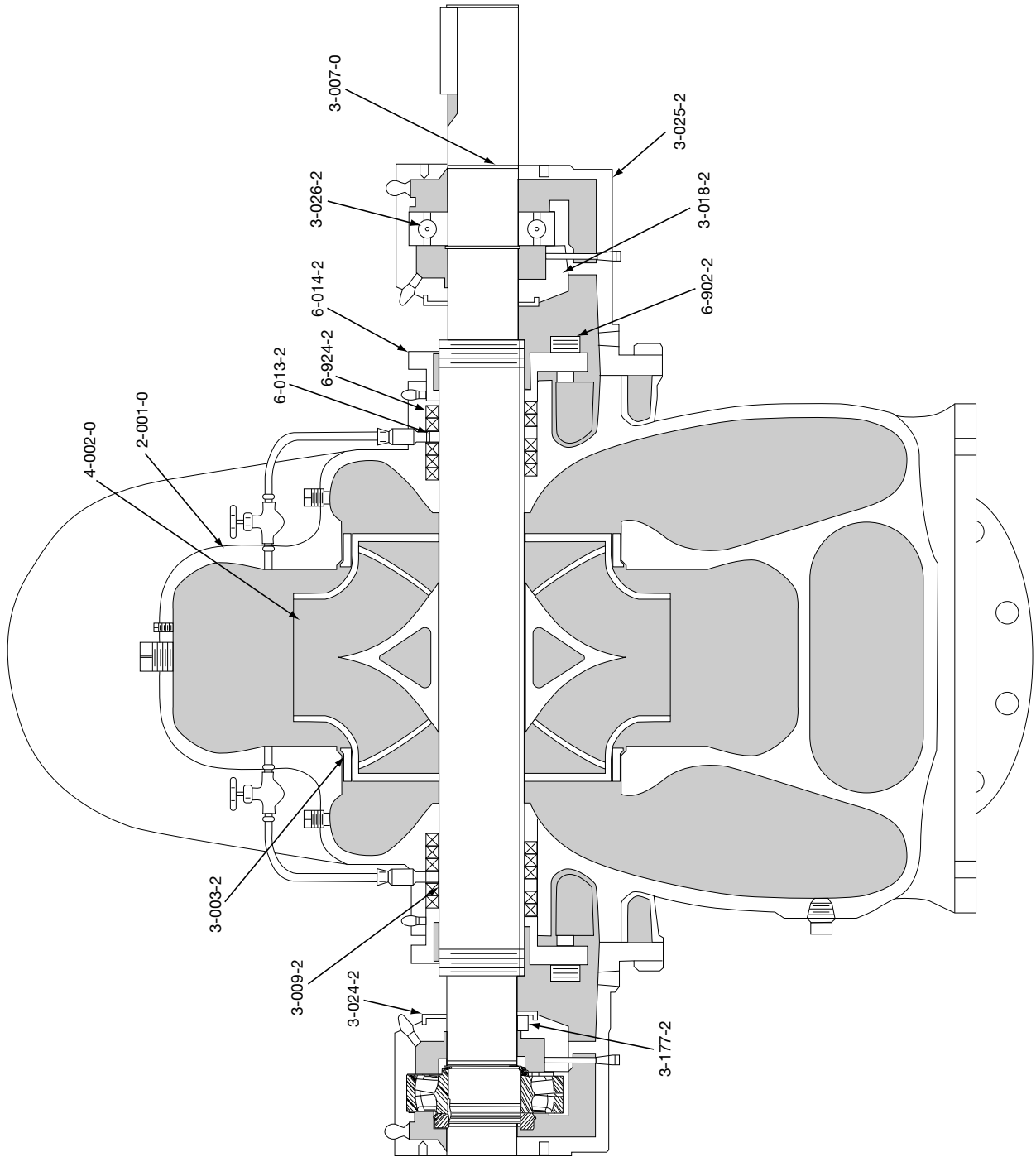

Series 9100 Parts List

Item No.	Part Description	Qty.	Material	Part Number				
				12x8x21F	12x8x22F-M	14x10x20F-S	14x10x20F-L	16x12x23F
2-001-0	Casing Assembly	1	Cast Iron	52-129-475-501	08-112-783-501	08-111-626-501	52-127-860-501	08-111-627-501
2-001-0	Casing Assembly	1	Ductile Iron	52-129-475-520	08-112-783-520	08-111-626-520	52-127-860-520	08-111-627-520
4-002-0	Impeller w/o Rings	1	Silicon Brass	52-460-826-000	52-231-707-002	08-217-813-002	52-161-304-001	08-217-814-002
4-002-0	Impeller w/ Rings	1	Silicon Brass	CF	52-231-709-502	52-229-512-502	52-261-376-501	52-229-524-502
3-003-2	Casing Wear Ring	2	Bronze	52-127-508-001	08-111-671-001	08-111-672-001	52-127-508-001	08-111-673-001
-	Impeller Wear Ring	2	Bronze	CF	52-120-557-009	52-120-560-001	52-127-847-001	52-120-561-001
-	Impeller Key	1	316 Stn. Stl.	49568-328	→	→	→	→
-	Gasket, Discharge (CI Casing)	1	Vellumoid	08-217-566-005	08-217-566-005	08-217-568-005	→	08-217-570-005
-	Gasket, Discharge (DI Casing)	1	Vellumoid	52-327-410-005	→	52-237-035-005	→	52-430-162-005
-	Gasket, Suction (CI Casing)	1	Vellumoid	08-217-565-005	→	08-217-567-005	→	08-217-569-005
-	Gasket, Suction (DI Casing)	1	Vellumoid	52-327-090-005	52-327-409-005	52-237-034-005	→	52-430-161-005
-	Anti-Rotation Pin	2	302 Stn. Stl.	CP-671-181-371	→	→	→	→
-	Nut, Shaft Sleeve	2	Bronze	52-128-684-001	→	→	52-128-682-001	52-128-684-001
3-009-2	Shaft Sleeve	2	Bronze	52-239-611-001	52-239-612-001	52-239-611-001	52-128-717-001	52-239-612-001
-	Set Screw, Sleeve Nut	2	316 Stn. Stl.	49514-204	→	→	→	→
-	Key, Sleeve	2	316 Stn. Stl.	52-119-854-005	→	→	→	→
-	O-Ring, Shaft Sleeve	2	Buna-N	C02495A-152	→	→	C02495A-155	C02495A-152
-	Flush Piping	1	Copper	52-127-293-502	→	→	→	→
6-013-2	Lantern Ring	2	Teflon	52-430-298-025	→	→	52-430-298-026	52-430-298-025
6-924-2	Packing Ring	12	Grade 'A'	52-328-740-371	→	→	52-328-740-381	52-328-740-371
6-014-2	Gland (CI Casing)	2	Bronze	52-260-520-001	→	→	08-217-583-504	52-260-520-001
6-014-2	Gland (DI Casing)	2	Bronze	52-260-520-001	→	→	52-235-606-001	52-260-520-001
6-902-2	Screw, Gland	4/8*	316 Stn. Stl.	49511-309	→	→	→	→
-	Washer, Gland Screw	4/8*	316 Stn. Stl.	49519-60	→	→	→	→
3-007-0	Shaft	1	Steel	52-329-572-001	52-329-573-001	52-329-572-001	52-329-574-001	52-329-573-001
-	Key, Coupling	1	Steel	49568-459	→	→	→	→
3-018-2	End Cover, Inboard Thrust	1	Cast Iron	52-229-646-001	→	→	→	→
-	End Cap, Bearing Housing	1	Bronze	52-260-478-001	→	→	→	→
3-018-2	End Cover, Inboard Coupling	1	Cast Iron	52-229-647-001	→	→	→	→
3-029-2	Deflector	2	Rubber/Steel	52-108-475-005	→	→	→	→
3-025-2	Bearing Housing	2	Cast Iron	52-429-114-001	→	→	→	→
-	Locknut, Bearing	1	Steel	8601-3016	→	→	→	→
3-026-2	Ball Bearing, Radial	1	Steel	8050-31660	→	→	→	→
-	Grease Fitting, Straight Drive	2	Steel	9008-01610	→	→	→	→
-	Retaining Ring, Thrust	1	Steel	A06941A-315	→	→	→	→
3-177-2	Lip Seal, Outboard	1	Rubber/Steel	CP-753-383-034	→	→	→	→
3-177-2	Lip Seal, Inboard	2	Rubber/Steel	CP-753-383-034	→	→	→	→
-	Pipe Plug, Oil Fill	2	Steel	63122-4	→	→	→	→
-	Pipe Plug, Drain	4	Steel	63122-2	→	→	→	→
-	Gasket, End Cover	2	Vellumoid	52-116-178-029	→	→	→	→
-	Screw, End Cover	4	Steel	49511-304	→	→	→	→
-	Screw, Casing	8	Steel	49511-304	→	→	→	→
-	Lockwasher, Bearing	1	Steel	8910-0016	→	→	→	→
3-026-2	Ball Bearing, Thrust	1	Steel	52-119-728-001	→	→	→	→
-	O-Ring, End Cap	1	Buna-N	C02495A-239	→	→	→	→
-	Washer, Ball Bearing	1	Cast Iron	52-126-224-001	→	→	→	→

Bold Face - Factory recommended spare parts

CF - Consult Factory

* Qty. 8 required for Ductile Iron Casing



Xylem Inc.
8200 N. Austin Avenue
Morton Grove, Illinois 60053
Phone: (847) 966-3700
Fax: (847) 965-8379
www.xylem.com/brands/acfirepump