

PARTS LIST

CP-602B-PL



Series 1580

Replacement Parts for 1580 Series In-Line Fire Pumps

AC FIRE PUMP
a xylem brand

Index

Exploded View	3
1.5x1.5x7F Pump Parts.....	4
2.5x2.5x7F Pump Parts.....	4
2.5x2.5x9.5F Pump Parts.....	4
3x3x7F Pump Parts.....	4
3x3x9.5F Pump Parts.....	4
4x4x7F Pump Parts.....	4
4x4x9.5F Pump Parts.....	5
6x6x9.5F-L Pump Parts.....	5
6x6x11F-S & -L Pump Parts.....	6
8x8x9.5F Pump Parts.....	7
8x8x13.5F Pump Parts.....	7
8x8x18F Pump Parts.....	7
Repair Kits for 1.5x1.5x7F Through 4x4x7F Pumps.....	8
Repair Kits for 4x4x9.5F Through 8x8x18F Pumps.....	9

Series 1580 Pump

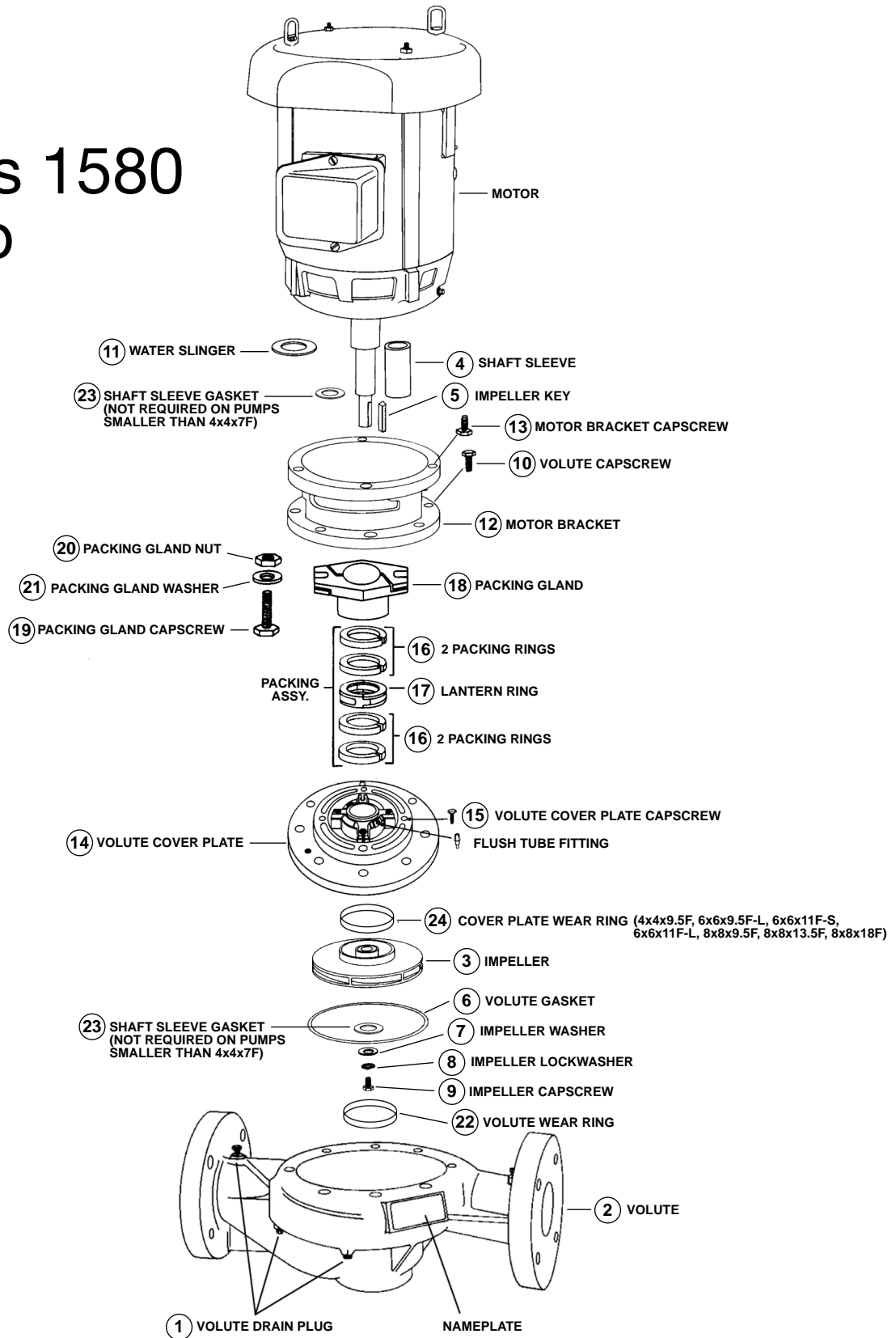

Item No.	Description	Qty.	1 1/4" Shaft Diameter @ Seal			1 5/8" Shaft Diameter @ Seal					
			1.5x1.5x7F	2.5x2.5x7F	3x3x7F	1.5x1.5x7F	2.5x2.5x7F	2.5x2.5x9.5F	3x3x7F	3x3x9.5F	4x4x7F
			143JP-184JP	143JP-184JP	143JP-184JP	213JP-215JP	213JP-215JP	254JP-326JP	213JP-256JP	284JP-326JP	213JP-326JP
2	Volute	1	P85600*	P85604*	P85608*	P85600*	P85604*	P85606*	P85608*	P85610*	AC8507*
2	Volute (High Pressure)	1	NONE	NONE	NONE	NONE	NONE	NONE	NONE	NONE	AC8508*
22	Volute Wear Ring	1	P46700	P49145	P85399	P46700	P49145	P49130	P85399	P49870	P49142
6	Volute Gasket	1	P57700	→	→	→	→	P48690	P57700	P48690	P57700
10	Volute Capscrew		CP-611-271-465 (8 REQ'D)	→	→	CP-611-271-466 (8 REQ'D)	DJ0081 (8 REQ'D)	CP-611-271-505 (12 REQ'D)	DJ0081 (8 REQ'D)	CP-611-271-505 (12 REQ'D)	DJ0081 (8 REQ'D)
1	Volute Drain Plug (1/4")	5	AC0532	→	→	→	→	→	→	→	P39050 (3)
1	Volute Drain Plug (1/2")		NONE	NONE	NONE	NONE	NONE	NONE	NONE	NONE	CP-711-527-004 (3)
14	Volute Coverplate	1	P85027	→	→	P85035	→	P85039	P85035	P85039	P85035
15	Coverplate Capscrew		CP-611-271-465 (4 REQ'D)	→	→	CP-611-271-466 (8 REQ'D)	CP-611-271-466 (8 REQ'D)	CP-611-271-466 (8 REQ'D)	CP-611-271-466 (8 REQ'D)	CP-611-271-466 (8 REQ'D)	CP-611-271-466 (8 REQ'D)
3	Impeller	1	P85518	P85520	P85522	52-433-358-515	P85532	P85533	P85534	P85535	AC8521
9	Impeller Capscrew	1	CP-611-325-467	→	→	→	CP-611-325-548	→	→	→	P13800
8	Impeller Lockwasher	1	J23874	→	→	→	CP-655-019-036	→	→	→	J23875
7	Impeller Washer	1	P46390	→	→	P51250	→	→	→	→	→
5	Impeller Key	1	52-123-677-015	→	→	52-123-677-014	→	→	→	→	→
4	Shaft Sleeve	1	P85075	→	→	185022	→	→	→	→	185021
23	Shaft Sleeve Gasket	2	NONE	NONE	NONE	NONE	NONE	NONE	NONE	NONE	52-122-982-003
16	Packing Ring Set	1	P82070	→	→	P82072	→	→	→	→	P82072
17	Lantern Ring Set	1	P84985	→	→	P84986	→	→	→	→	→
18	Packing Gland Halves	2	P85048	→	→	P85050	→	→	→	→	→
19	Packing Gland Capscrew	2	J92052	→	→	→	→	→	→	→	→
20	Packing Gland Nut	2	J91659	→	→	→	→	→	→	→	→
21	Packing Gland Washer	2	52-128-437-004	→	→	→	→	→	→	→	J91649
12	Motor Bracket - Motor Frames: 182JP & 184JP	1	P85023	→	→	NONE	NONE	NONE	NONE	NONE	NONE
13	Motor Bracket Capscrew for above	4	CP-611-271-466	→	→	NONE	NONE	NONE	NONE	NONE	NONE
12	Motor Bracket - Motor Frames: 213JP - 256JP	1	NONE	NONE	NONE	P85025	→	→	→	NONE	P85025
13	Motor Bracket Capscrew for above	4	NONE	NONE	NONE	K03600	CP-611-271-544	→	→	NONE	K03600
12	Motor Bracket - Motor Frames: 284JP - 326JP	1	NONE	NONE	NONE	NONE	NONE	P85099	NONE	P85099	→
13	Motor Bracket Capscrew for above	4	NONE	NONE	NONE	NONE	NONE	P19490	NONE	P19490	→
11	Water Slinger	1	P53550	→	→	P77320	→	→	→	→	→

* Includes Wear Ring

→ Factory recommended spare parts.

Item No.	Description	Qty.	4x4x9.5F		6x6x9.5F-L		
			254JP-256JP	284JP-326JP	254JP-256JP	284JP-326JP	364JP-405JP
2	Volute	1	AC8504*	→	P85514*	→	→
2	Volute (High Pressure)	1	AC8505*	→	NONE	NONE	NONE
22	Volute Wear Ring	1	P49142	→	P49143	→	→
6	Volute Gasket	1	P48690	→	→	→	→
10	Volute Capscrew		P03470 (12 REQ'D)	→	→	→	→
1	Volute Drain Plug (1/4")	6	P39050 (3)	P39050 (3)	CP-711-523-002	→	→
1	Volute Drain plug (1/2")		CP-711-527-004 (3)	CP-711-527-004 (3)	NONE	NONE	NONE
14	Volute Coverplate	1	P82937	→	→	→	P58644
24	Coverplate Wear Ring	1	P82935	P82935	P82935	P82935	P82935
15	Coverplate Capscrew	8	P52320	DJ0071	P52320	DJ0071	→
3	Impeller	1	AC8502	→	P58648	→	P58649
9	Impeller Capscrew	1	P13800	→	AC2509	→	→
8	Impeller Lockwasher	1	J23875	→	→	→	→
7	Impeller Washer	1	P51250	→	→	→	AC2506
5	Impeller Key	1	52-123-677-014	→	AC2520	→	AC2519
4	Shaft Sleeve	1	185021	→	→	→	AC0601
23	Shaft Sleeve Gasket	2	52-122-982-003	→	→	→	P58646
16	Packing Ring Set	1	P82072	→	→	→	AC0942 (5 REQ'D)
	Packing Ring Backing	1	NONE	NONE	NONE	NONE	AC0592
17	Lantern Ring Set	1	P84986	→	→	→	AC0803
18	Packing Gland	2	P85050	→	→	→	AC0664 (1 REQ'D)
19	Packing Gland Capscrew	2	J92052	→	→	→	CP-611-327-480
20	Packing Gland Nut	2	J91659	→	→	→	→
21	Packing Gland Washer	2	J91649	→	→	→	→
12	Motor Bracket	1	P85025	P85099	P85025	P85099	→
13	Motor Bracket Capscrew	4	K03600	P19490	K03600	P19490	→
11	Water Slinger	1	P77320	→	→	→	52-108-475-011

* Includes Wear Ring

- Factory recommended spare parts.

Item No.	Description	Qty.	6x6x11F-S		6x6x11F-L	
			254JP-256JP	284JP-326JP	284JP-326JP	364JP-405JP
2	Volute	1	P85641*	→	→	→
2	Volute (High Pressure)	1	P58658*	→	→	→
22	Volute Wear Ring	1	P51390	→	→	→
6	Volute Gasket	1	P80765	→	→	→
10	Volute Capscrew	16	P13780	→	→	→
1	Volute Drain Plug	6	CP-711-523-002	→	CP-711-523-002	→
14	Volute Coverplate	1	P82936	→	P82936	P58642
24	Coverplate Wear Ring	1	P49138	P49138	P49138	P49138
15	Coverplate Capscrew	8	P52320	DJ0071	→	→
3	Impeller	1	P50872	→	P58652	P58653
9	Impeller Capscrew	1	P13800	→	→	→
8	Impeller Lockwasher	1	J23875	→	→	→
7	Impeller Washer	1	P51250	→	P51250	AC2506
5	Impeller Key	1	P49372	→	P49372	AC2508
4	Shaft Sleeve	1	185021	→	185021	AC0601
23	Shaft Sleeve Gasket	2	52-122-982-003 & 52-122-982-001 (1 EA)	→	52-122-982-003	P58646
16	Packing Ring Set	1	P82072	→	P82072	AC0942 (5 REQ'D)
	Packing Ring Backing	1	NONE	NONE	NONE	AC0592
17	Lantern Ring Set	1	P84986	→	P84986	AC0803
18	Packing Gland	2	P85050	→	P85050	AC0664 (1 REQ'D)
19	Packing Gland Capscrew	2	J92271	→	J92271	CP-611-327-480
20	Packing Gland Nut	2	J91659	→	→	→
21	Packing Gland Washer	2	J91649	→	→	→
12	Motor Bracket	1	P85025	P85099	→	→
13	Motor Bracket Capscrew	4	K03600	P19490	→	→
11	Water Slinger	1	P77320	→	P77320	52-108-475-011

* Includes Wear Ring

- Factory recommended spare parts.

Item No.	Description	Qty.	8x8x9.5F		8x8x13.5F	8x8x18F
			284JP-326JP	364JP-405JP	364JP-405JP	364JP-405JP
2	Volute	1	P85516*	→	AC8646*	AC8648*
2	Volute (High Pressure)	1	AC2445*	→	AC8647*	AC8649*
22	Volute Wear Ring	1	P49144	→	P49138	AC8640
6	Volute Gasket	1	P48690	→	P80767	AC8641
10	Volute Capscrew		P03470 (12 REQ'D)	→	K04500 (16 REQ'D)	J92292** (18 REQ'D)
1	Volute Drain Plug (1/4")	3	P39050	→	→	→
1	Volute Drain Plug (1/2")	3	CP-711-523-004	→	→	→
14	Volute Coverplate	1	P82937	P58644	NONE	NONE
24	Coverplate Wear Ring	1	P82935	→	P59543	AC8640
15	Coverplate Capscrew	8	DJ0071	→	NONE	NONE
3	Impeller	1	AC8479	AC8480	P59537	AC8631
9	Impeller Capscrew	1	AC2443	AC2444	AC8629	→
8	Impeller Lockwasher	1	J23875	→	J23875	→
7	Impeller Washer	1	P51250	AC2506	AC2506	AC8642
5	Impeller Key	1	AC2442	AC2441	AC8628	AC8643
4	Shaft Sleeve	1	185021	AC0601	→	→
23	Shaft Sleeve Gasket	2	52-122-982-003	P58646	→	P58646 & AC8644 (1 EA)
16	Packing Ring Set	1	P82072	AC0942 (5 REQ'D)	→	→
	Packing Ring Backing	1	NONE	AC0592	→	→
17	Lantern Ring Set	1	P84986	AC0803	→	→
18	Packing Gland	2	P85050	AC0664 (1 REQ'D)	→	→
19	Packing Gland Capscrew	2	J92052	AC8669	→	→
20	Packing Gland Nut	2	J91659	→	→	→
21	Packing Gland Washer	2	J91649	→	→	→
12	Motor Bracket	1	P85099	→	P59541	AC8638
13	Motor Bracket Capscrew	4	P19490	→	→	→
	Saddle	1	NONE	NONE	AC8668	AC8668
	Saddle Capscrew	4	NONE	NONE	J92298	→
11	Water Slinger	1	P77320	AC8670	→	→

* Includes Wear Ring

**18 washers, CP-651-001-371, also required.

█ - Factory recommended spare parts.

REPAIR KITS FOR SIZES 1.5x1.5x7F THROUGH 4x4x7F

		Minor Repair Kit for 1 1/4" Shaft at Impeller	Minor Repair Kit for 1 5/8" Shaft at Impeller
ASSEMBLY NO.		1DN041	1DN042
PART NAME	QTY.		
Volute Gasket	1	P57700	P57700
Volute Gasket	1	N/A	P48690
Water Slinger	1	P53550	P77320
Packing (Set of 4)	1	P82070	P82072
Lantern Ring Set	1	P84985	P84986
Capscrew (Gland)	2	J92052	J92052
Nut (Gland)	2	J91659	J91659
Washer (Gland)	2	J91649	J91649

		Major Repair Kit for 1.5x1.5x7F (1-1/4" Shaft at Impeller)	Major Repair Kit for 2.5x2.5x7F (1-1/4" Shaft at Impeller)	Major Repair Kit for 3x3x7F (1-1/4" Shaft at Impeller)	Major Repair Kit for 1.5x1.5x7F (1-5/8" Shaft at Impeller)	Major Repair Kit for 2.5x2.5x7F (1-5/8" Shaft at Impeller)	Major Repair Kit for 2.5x2.5x9.5F (1-5/8" Shaft at Impeller)	Major Repair Kit for 3x3x7F (1-5/8" Shaft at Impeller)	Major Repair Kit for 3x3x9.5F (1-5/8" Shaft at Impeller)	Major Repair Kit for 4x4x7F (1-5/8" Shaft at Impeller)
ASSEMBLY NO.		1DN043	1DN044	1DN045	1DN070	1DN047	1DN046	1DN048	1DN049	1DN071
PART NAME	QTY.									
Volute Gasket	1	P57700	P57700	P57700	P57700	P57700	N/A	P57700	N/A	P57700
Volute Gasket	1	N/A	N/A	N/A	N/A	N/A	P48690	N/A	P48690	N/A
Water Slinger	1	P53550	P53550	P53550	P77320	P77320	P77320	P77320	P77320	P77320
Packing (Set of 4)	1	P82070	P82070	P82070	P82072	P82072	P82072	P82072	P82072	P82072
Lantern Ring Set	1	P84985	P84985	P84985	P84986	P84986	P84986	P84986	P84986	P84986
Capscrew (Gland)	2	J92052	J92052	J92052	J92052	J92052	J92052	J92052	J92052	J92052
Nut (Gland)	2	J91659	J91659	J91659	J91659	J91659	J91659	J91659	J91659	J91659
Washer (Gland)	2	J91649	J91649	J91649	52-128-437-004	J91649	J91649	J91649	J91649	J91649
Volute Wear Ring	1	P46700	P49145	P85399	P46700	P49145	P49130	P85399	P49870	P49142
Shaft Sleeve	1	P85075	P85075	P85075	185022	185022	185022	185022	185022	185021

REPAIR KITS FOR SIZES 4x4x9.5F THROUGH 8x8x18F

		Minor Repair Kit for 4x4x9.5F (254JP-326JP Frame)	Minor Repair Kit for 6x6x9.5F-L (254JP-326JP Frame)	Minor Repair Kit for 8x8x9.5F (284JP-326JP Frame)	Minor Repair Kit for 6x6x9.5F-L (364JP-405JP Frame)	Minor Repair Kit for 8x8x9.5F (364JP-405JP Frame)	Minor Repair Kit for 6x6x11F-S&-L (254JP-326JP Frame)	Minor Repair Kit for 6x6x11F-L (364JP-405JP Frame)	Minor Repair Kit for 8x8x13.5F (364JP-405JP Frame)	Minor Repair Kit for 8x8x18F (364JP-405JP Frame)
ASSEMBLY NO.		1DN051			1DN053	1DN074	1DN055	1DN057	1DN068	1DN076
PART NAME	QTY.									
Volute Gasket	1	P48690			P48690	P48690	P80765	P80765	P80767	AC8641
Shaft Sleeve Gasket	1	52-122-982-003			P58646	P58646	52-122-982-003 (2)	P58646	P58646	P58646
Shaft Sleeve Gasket	1	52-122-982-003			P58646	P58646	52-122-982-001 (1)	P58646	P58646	P58646
Water Slinger	1	P77320		52-108-475-011	AC8670	P77320	52-108-475-011	AC8670	AC8670	
Packing Ring Set	1	P82072		AC0942 (5)	AC0942 (5)	P82072	AC0942 (5)	AC0942 (5)	AC0942 (5)	
Packing Ring Backing	1	NONE			AC0592	AC0592	NONE	AC0592	AC0592	AC0592
Lantern Ring Set	1	P84986			AC0803	AC0803	P84986	AC0803	AC0803	AC0803
Capscrew (Gland)	2	J92052			CP-611-327-480	AC8669	J92271	CP-611-327-480	AC8669	AC8669
Nut (Gland)	2	J91659			J91659	J91659	J91659	J91659	J91659	J91659
Washer (Gland)	2	J91649			J91649	J91649	J91649	J91649	J91649	J91649
Washer (Seal)	1	AC2507			AC2507	AC2507	AC2507	AC2507	AC2507	AC2507

		Major Repair Kit for 4x4x9.5F (254JP-326JP Frame)	Major Repair Kit for 6x6x9.5F-L (254JP-326JP Frame)	Major Repair Kit for 8x8x9.5F (284JP-326JP Frame)	Major Repair Kit for 6x6x9.5F-L (364JP-405JP Frame)	Major Repair Kit for 8x8x9.5F (364JP-405JP Frame)	Major Repair Kit for 6x6x11F-S&-L (254JP-326JP Frame)	Major Repair Kit for 6x6x11F-L (364JP-405JP Frame)	Major Repair Kit for 8x8x13.5F (364JP-405JP Frame)	Major Repair Kit for 8x8x18F (364JP-405JP Frame)
ASSEMBLY NO.		1DN072	1DN052	1DN073	1DN054	1DN075	1DN056	1DN058	1DN069	1DN077
PART NAME	QTY.									
Volute Gasket	1	P48690	P48690	P48690	P48690	P48690	P80765	P80765	P80767	AC8641
Shaft Sleeve Gasket	1	52-122-982-003	52-122-982-003	52-122-982-003	P58646	P58646	52-122-982-003 (2)	P58646	P58646	P58646
Shaft Sleeve Gasket	1	52-122-982-003	52-122-982-003	52-122-982-003	P58646	P58646	52-122-982-001 (1)	P58646	P58646	P58646
Water Slinger	1	P77320	P77320	P77320	52-108-475-011	AC8670	P77320	52-108-475-011	AC8670	AC8670
Packing Ring Set	1	P82072	P82072	P82072	AC0942 (5)	AC0942 (5)	P82072	AC0942 (5)	AC0942 (5)	AC0942 (5)
Packing Ring Backing	1	NONE	NONE	NONE	AC0592	AC0592	N/A	AC0592	AC0592	AC0592
Lantern Ring Set	1	P84986	P84986	P84986	AC0803	AC0803	P84986	AC0803	AC0803	AC0803
Capscrew (Gland)	2	J92052	J92052	J92052	CP-611-327-480	AC8669	J92271	CP-611-327-480	AC8669	AC8669
Nut (Gland)	2	J91659	J91659	J91659	J91659	J91659	J91659	J91659	J91659	J91659
Washer (Gland)	2	J91649	J91649	J91649	J91649	J91649	J91649	J91649	J91649	J91649
Washer (Seal)	1	AC2507	AC2507	AC2507	AC2507	AC2507	AC2507	AC2507	AC2507	AC2507
Volute Wear Ring	1	P49142	P49143	P49144	P49143	P49144	P51390	P51390	P49138	AC8640
Shaft Sleeve	1	185021	P78737	185021	AC0601	AC0601	P78737	AC0601	AC0601	AC0601

Xylem |'zīləm|

- 1) The tissue in plants that brings water upward from the roots;
- 2) a leading global water technology company.

We're 12,500 people unified in a common purpose: creating innovative solutions to meet our world's water needs. Developing new technologies that will improve the way water is used, conserved, and re-used in the future is central to our work. We move, treat, analyze, and return water to the environment, and we help people use water efficiently, in their homes, buildings, factories and farms. In more than 150 countries, we have strong, long-standing relationships with customers who know us for our powerful combination of leading product brands and applications expertise, backed by a legacy of innovation.

For more information on how Xylem can help you, go to www.xyleminc.com



Xylem Inc.
8200 N. Austin Avenue
Morton Grove, Illinois 60053
Phone: (847) 966-3700
Fax: (847) 965-8379
www.xyleminc.com/brands/acfirepump