

The series of single-phase hopper loaders VLM allows conveying plastic granules to processing machines, drying hoppers and dosing units.

Single-phase hopper loaders are equipped with a built-in suction unit.

Suction capacity up to 600 Kg/h of material, at a distance of 30 m.

A microprocessor board and a keypad allow the operator to easily program and control the machine.



#### TECHNICAL SPECIFICATIONS:

- 900 W double-stage blower (model VLM25 equipped with a 1800 W brushless blower).
- Automatic filter cleaning with compressed air.
- Inspection door with a stainless steel filter for venting.
- Control with a keyboard, and a digital display showing operating status and alarms.
- A built-in double cover divides the motor from the blower guaranteeing a better operation.
- Aluminium fixing ring for a 360° installation.
- Suction probe and pipe included.

#### ACCESSORIES:

- Proportional valve PVN with percentage setting.
- Acoustic alarm.
- Pyrex mini-hoppers for direct installations on machines.

#### ADDED VALUE:

- EASY TO USE.
- LOW MAINTENANCE.
- SAFE AND RELIABLE.
- QUICK INSTALLATION.

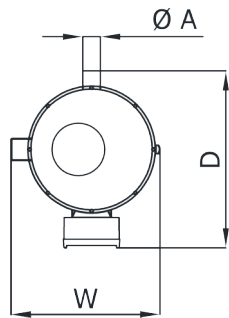
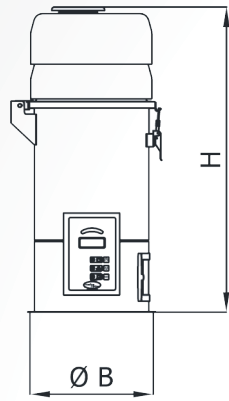

Double-stage blower



Easy maintenance

TECHNICAL DATA		VLM2	VLM4	VLM5	VLM10	VLM25
Suction capacity	kg/h	40	60	80	120	600
Receiver volume	l	2	4	5	10	25
Depression	KPa	18	18	21	21	21
Noise level	dB(A)	<80	<80	<80	<80	<80
Motor power	kW	0.85	0.85	0.9	0.9	1.8
Voltage/Frequency	V/Hz	230/50-60	230/50-60	230/50-60	230/50-60	230/50-60
Material inlet A	mm	40	40	40	40	50/60
Fiqing diameter	mm	210	210	280	280	280
Dimensions WxDxH	mm	210x330x430	210x330x530	280x405x550	280x408x700	280x404.5x911
Weight	Kg	7	8	10	12	30

Compressed-air feeder for small throughputs up to 20-30 kg/h. Entirely made of anodized aluminium and Pyrex stub pipe with adjustable level sensor, the VLV feeder is equipped with a high-efficiency suction probe. It can be directly installed on a machine or a small maintenance hopper.



TECHNICAL DATA		VLV	VLV-PF
Capacity	dm <sup>3</sup>	1	1
Suction capacity	Kg/h	30	30
Material inlet	mm	32	32
Voltage/Frequency	V/Hz	230/50-60	230/50-60
Dimensions WxDxH	mm	190x294x330	246x202x322
Weight	Kg	5	5