

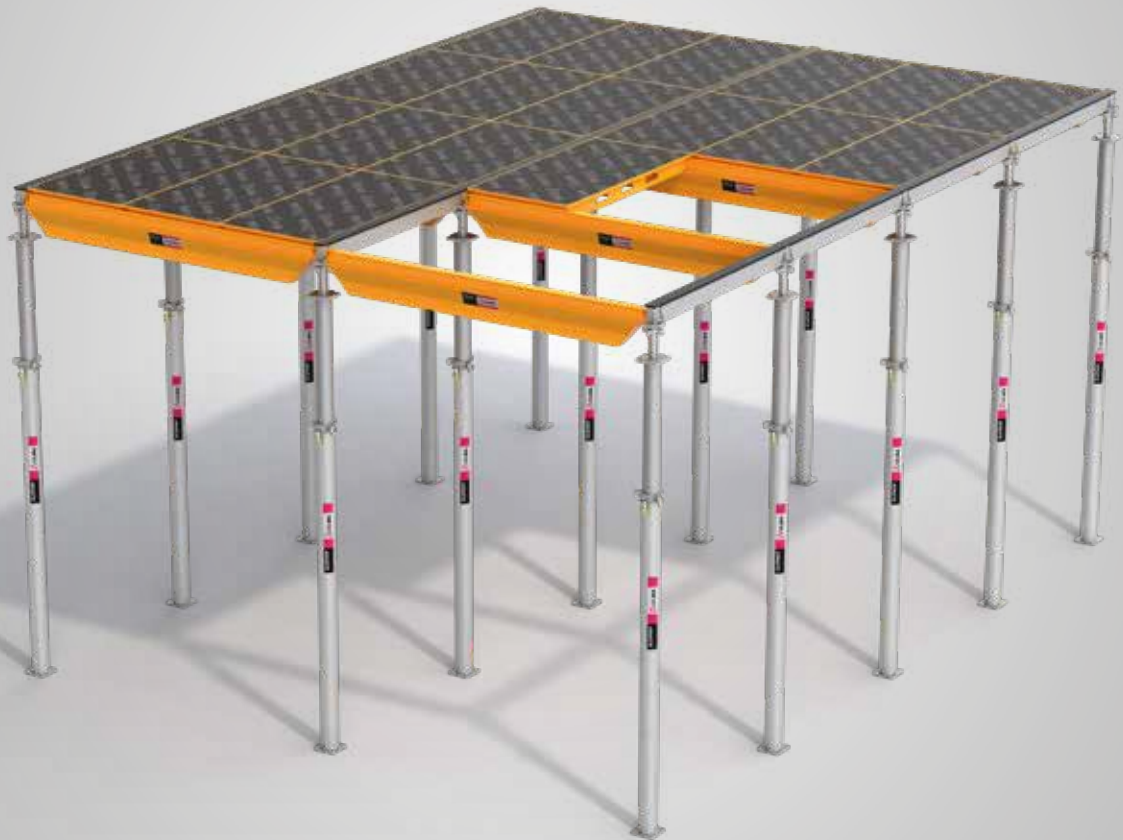

CC-4

ALUMINIUM MODULAR FORMWORK

Ideal solution for
large slabs







CC-4 is a **modular formwork** with aluminium components, mainly geared towards the construction of **large slab areas** or **projects with short lead times**.

There are two types within its range:

CC-4 PANEL: consisting of aluminium framed panels and integrated board. Suitable for high performance.

CC-4 PLY: consisting of beams and plywood. Suitable for slabs with high concrete finish requirements and/or irregular geometries.



High-performance formwork helps reduce the construction cycle

Saving time

The reduced weight of its aluminium components together with the simplicity of the assembly, systematic and intuitive, speed up the assembly and disassembly process. In addition, the drophead allows early recovery of the material (beams, transversals and panels) within 3 days so that it can be used in the next slab to be built, thus speeding up the construction cycle.

Maximum security

The system is assembled from below and enables the pre-assembly of the grid, guaranteeing the stability of the system from the first grid. In addition, all elements can be hung and then lifted without great effort. This feature, in addition to the drophead which allows safe dismantling without any element falling to the ground, places this system at the forefront of safety.

2 en 1: modular + flexible

Although the system is modular, some system components are designed to improve flexibility. Thus, both advantages are combined: the modular system enables high performance and its flexibility allows the system to be adapted to different geometries.

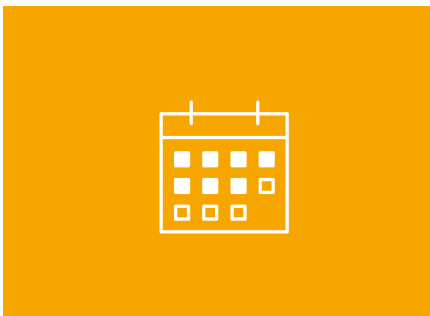



Simple and systematic assembly means fast and safe assembly.

CC-4 PANEL

Basic grid. 2.32 m x 1.5 m.

Different grids can be configured by combining different beams and transversals according to the user's needs.



Maximum slab thickness. Up to 90 cm.

System suitable for both solid and lightened slabs.

Impact of props. 0.29 props/m²

The **Beam CC** is supported by the Drophead CC and then lifts up, making it possible for one worker to assemble the beam.

Determines the length of the grid:
2.32 m / 1.57 m.

The **Transversal CC TE ALU** determines the width of the grid:
1.5 m / 0.75 m.

This is an aluminium profile with a plastic and rubber top cover that ensures the **water-tightness** with the panel that **prevents possible concrete leaks**.

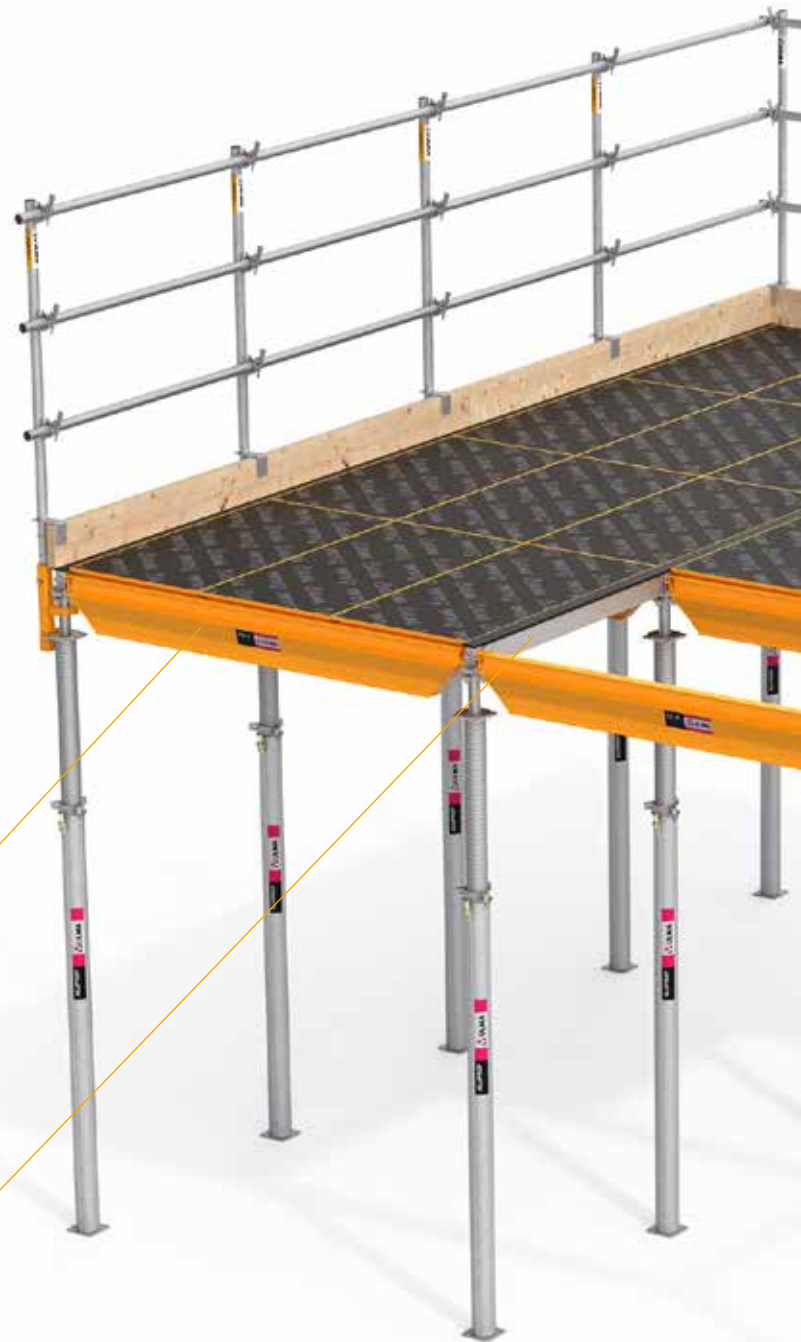
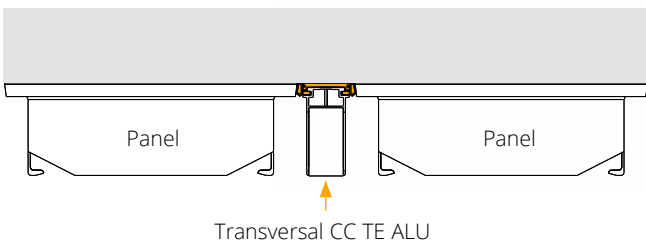

The drophead (**Head CC**) allows early recovery of beams, transversals and panels after 3 days, reuse on the next pour.

Striking sequence.

Simple and safe striking. The elements are lowered by 15 cm due to the drophead.



CC-4 PLY

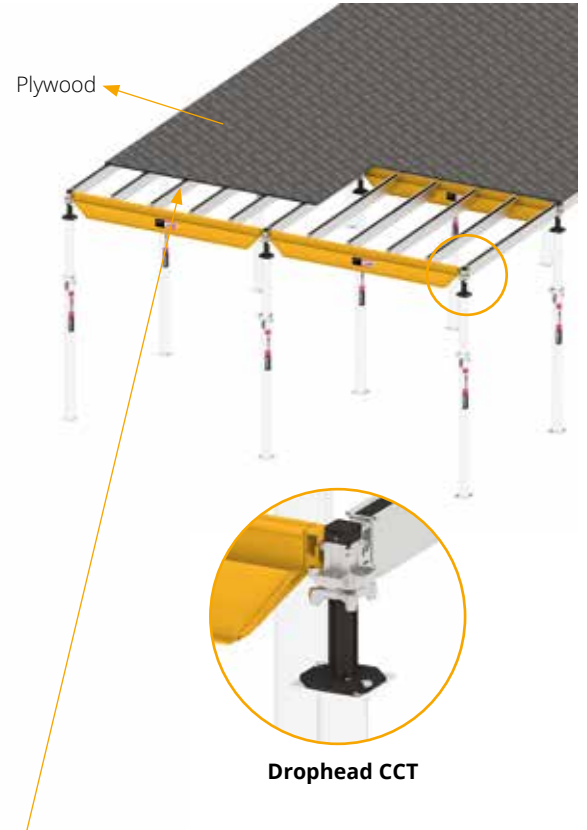

Plywood

Drophead CCT

The **Transversal CC TR** determines the width of the grid: 2.075 m / 1.5 m / 0.75 m. It is an aluminium profile that incorporates a plastic nailing strip to facilitate the fixing of the plywood.

Pouring position

Striking position



Hitting the wedge

Turn of the wedge

Drop of the wedge

Drop of the formwork



Fast assembly and early stripping means time savings. In short, cost-effectiveness

High performance with maximum safety

Drophead system

Quick and tidy stripping thanks to the drophead which allows the formwork to be lowered by 15 cm without falling to the ground.

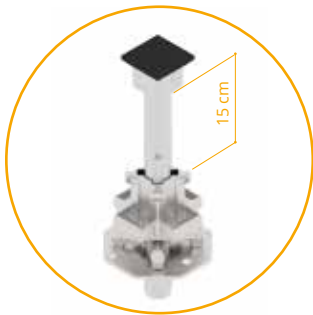

Collective safety

The assembly is carried out from the bottom, and enables the pre-assembly of the grid, guaranteeing the stability of the system from the first grid.



Ergonomics

The low weight of the aluminium components makes it easier to handle the system components.

In addition, all elements can be hung and then erected without much effort.





Cleaner work area

Once the system has been stripped using the drophead, the material is stacked directly onto its pallet. This results in a tidier working area and also facilitates the transfer of the material on site.



Modular and flexible

Flexible system

Although the system is modular, some elements are designed to improve flexibility and increase the efficiency of the infillings, perimeter protection and safety.





Guaranteed profitability

High performance for large surfaces

As it is a modular system, its assembly and disassembly are systematic and intuitive, in short, it is a quick formwork that requires minimal training in its use.

Early reuse of material

Thanks to the early material recovery after 3 days, the material can be reused for the next section, so less material is needed on site. The props and their heads are the only remaining elements.



Increased durability of the material

The drophead allows material to be recovered without it falling to the floor, directly from the deck to the pallet.

It is also a system that requires less replacement material than other similar systems.





90° Assembly

Possibility of a change of direction to adapt to different geometries and simplify infilling.



Infilling on column

Different configurations for the infilling around the column, for columns of any size and in any position on the slab.

/ CC-4 PANEL



/ CC-4 PLY





| Infilling on wall

Different possibilities for wall finishing.

/ With Universal Head CC



/ With edge beams and plywood



| Perimeter protection

Safe solutions thanks to the perimeter beam or the perimeter clamp.



| Column heads

Simple column head solution with CC-4.





Drophead CC	1870060	4.9

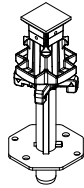

Universal Head CC	1870500	3.8
-------------------	---------	-----

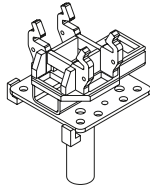

Drophead CCT	1870155	4.6
--------------	---------	-----

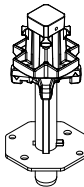

Panel CC 1.5x0.75	1870090	15.5
Panel CC 0.75x0.75	1870096	8.4
Panel CC 1.5x0.375	1870165	9.1
Panel CC 0.75x0.375	1870265	4.7

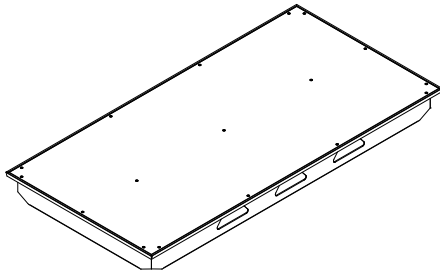

Beam CC 2.32	1870029	16
Beam CC 1.57	1870031	10.6

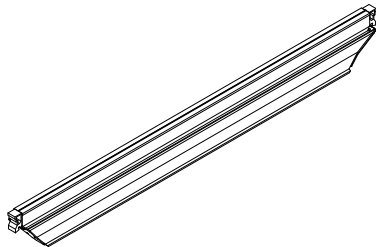

Transversal CC TE 1.5 ALU	1870400	5.3
Transversal CC TE 0.75 ALU	1870405	2.7
Transversal CC TE 0375 ALU	1870407	1.4

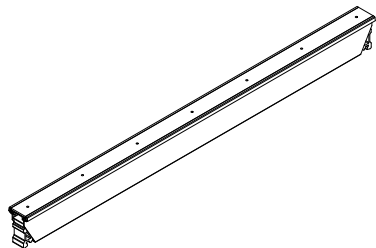

Beam CC W 2.075	1870230	12.4
Beam CC W 1.5	1870105	89
Beam CC W 0.75	1870150	4.4
Beam CC W 0.375	1870375	2.1

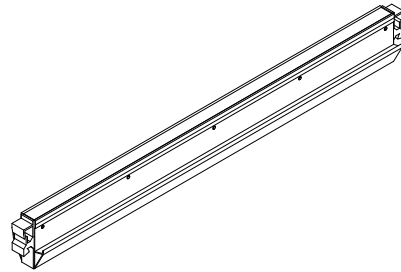

Transversal CC TR 2.075	1870225	8.7
Transversal CC TR 1.5	1870045	6.3
Transversal CC TR 0.75	1870050	3.2

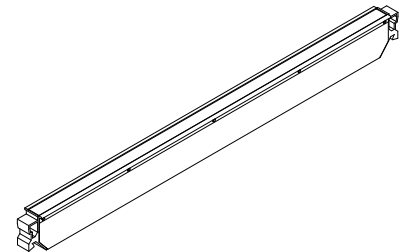

Edge beam 2.32	1870464	8.9
Edge beam 1.57	1870465	5.8

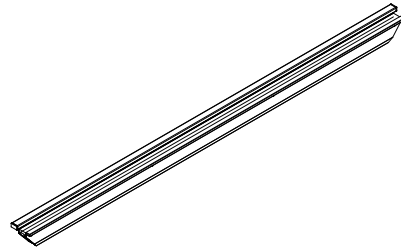

Maxi pallet CC panels	1870300	79
-----------------------	---------	----

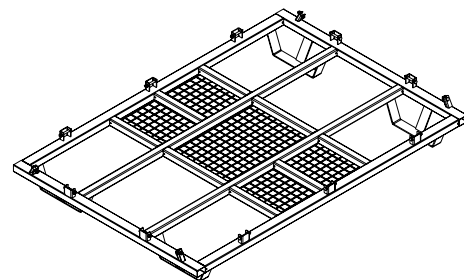

Steel sling maxi pallet	1870285	1.8
-------------------------	---------	-----

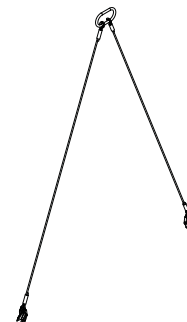



It's **all** about **trust**

www.ulmaconstruction.com

ULMA C y E, S. Coop.

Ps. Otadui, 3 - P.O. Box 13
20560 Oñati, Spain
T. +34 943 034 900
F. +34 943 034 920



IMPORTANT:

Any security provisions as directed by the appropriate government or professional agencies of each country must be observed. The pictures in this document are snapshots of situations in different stages of assembly, and therefore are not complete images. For the purpose of security, they should not be deemed as definitive. All indications regarding security and operations contained in this document, along with the data on stress and loads, should be respected. Any changes or unique assembly shall require a special calculation or solution. The weights appearing in this document, related to the basic items of the product, are approximate. Our equipment is designed to work exclusively with accessories and items produced by our company. Combining this equipment with other brands without having made all corresponding verifications is dangerous. The company reserves the right to introduce any modifications deemed necessary for the technical development of the product. All rights reserved. This document may not be reproduced or transmitted, in whole or in part, by any electronic or mechanical means, including photocopying, magnetic recording or any other information storage and recovery system without prior written permission.
© Copyright by ULMA C and E, S. Coop.

05G354ENM