

DETAIL DRAWINGS

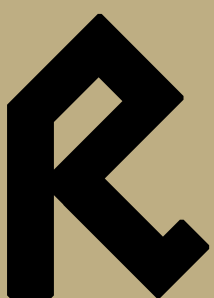

RIVERCLACK

SHAPING ROOFS

DETAIL DRAWINGS

GENERAL NOTES

The technical data provided in this communication is for information purposes only.

The following detail drawings represent suggestions for standard roof structure design and must be adapted by the addressee according to actual construction conditions.

The design of these types of roof structure requires careful planning and calculation based on the actual conditions.

The choice and use of proper fixed points and screws must be made in accordance with the static calculations.

ISCOM SPA provides this information based on its experience and knowledge and accepts no liability for any loss, damage, costs or expense incurred in relation to or arising from any person relying on the suggestions and information rendered.

All information issued by ISCOM SPA is subject to continuous development without notification. The information/details contained in this communication are correct at the date of issue. It is the addressee's responsibility to ascertain from ISCOM SPA that the information contained in this communication has not changed at the time of use by the addressee.

DUO PITCH RIDGE	05
MONO PITCH RIDGE	11
VERGE DETAILS	19
EAVES DETAILS	25
EXPANSION JOINTS	35
ROOF PENETRATION	39
SKYLIGHTS	41
OVERLAP DETAILS	49
CURVED ROOF RIDGE	53
DIAGONAL ROOF RIDGE	55

DUO PITCH RIDGE STEEL STRUCTURE

DETAIL 01.02.S

TECHNICAL SITUATION / SCALE 1:5

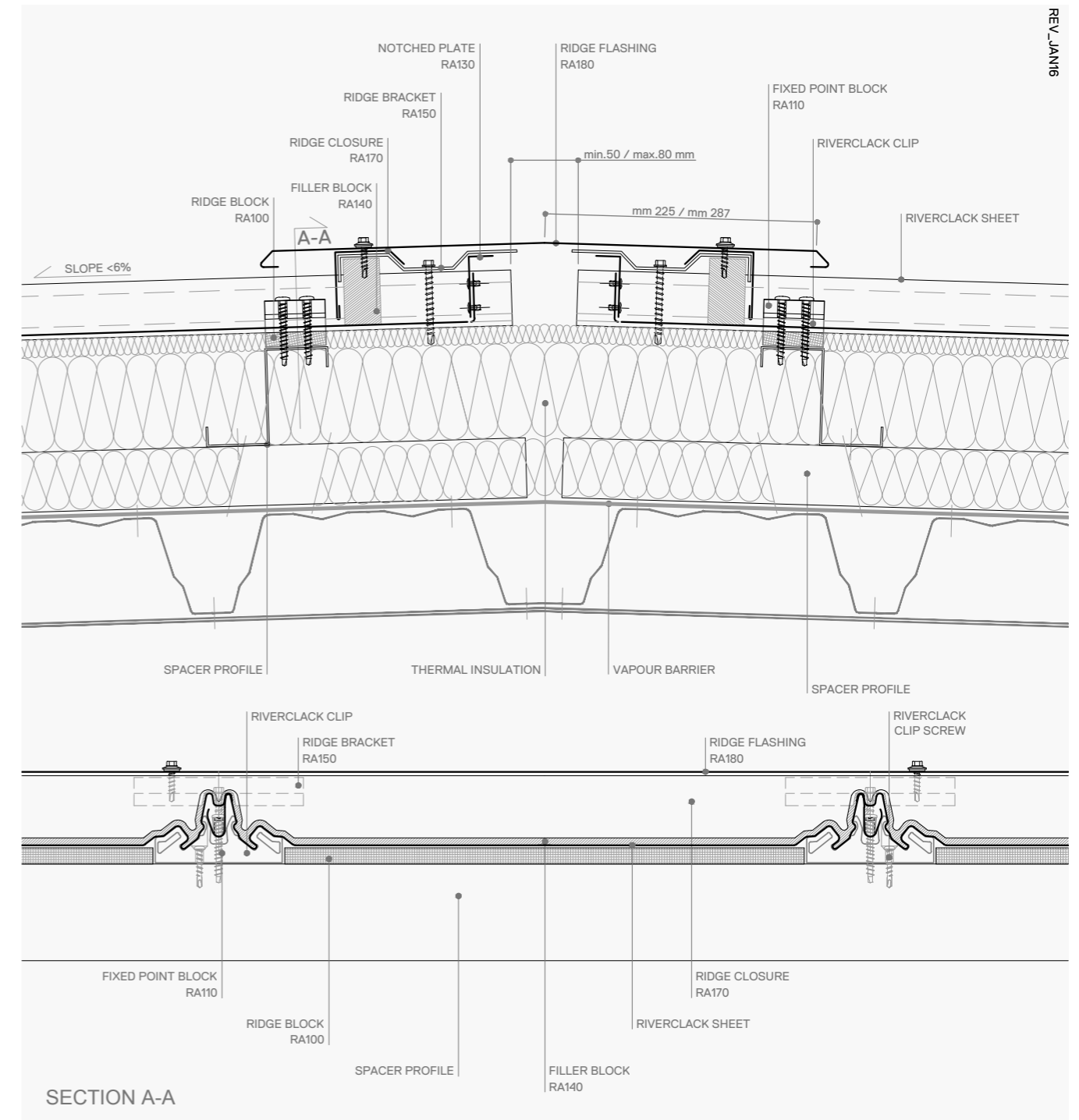

- NOTES**
- Slope <math>< 6\%</math>
 - If length of sheet > 20m use item RA120 as fixed point according to instructions or use two RA110 (up to max length 40m) according to instructions

For further enquiries please contact Iscom's technical department or your local representative.

WWW.RIVERCLACK.COM

DUO PITCH RIDGE STEEL STRUCTURE

DETAIL 01.03.S

TECHNICAL SITUATION / SCALE 1:5

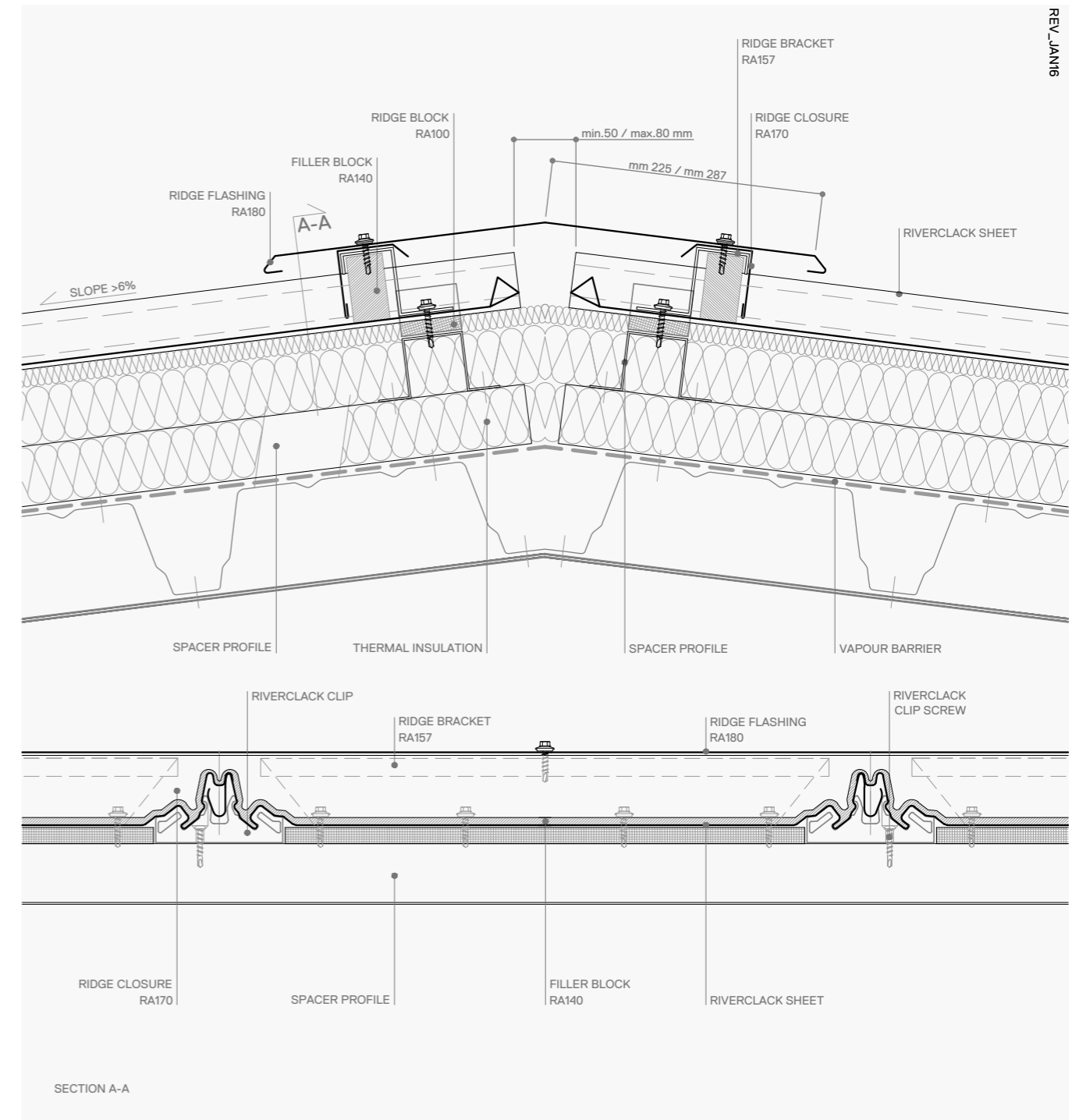

- NOTES
- Slope > 6%
 - As ridge bracket RA157 is also a fixed point use it according to instructions

For further enquiries please contact Iscom's technical department or your local representative.

WWW.RIVERCLACK.COM

DIAGONAL ROOF RIDGE STEEL STRUCTURE

DETAIL 01.04.S

TECHNICAL SITUATION / SCALE 1:5

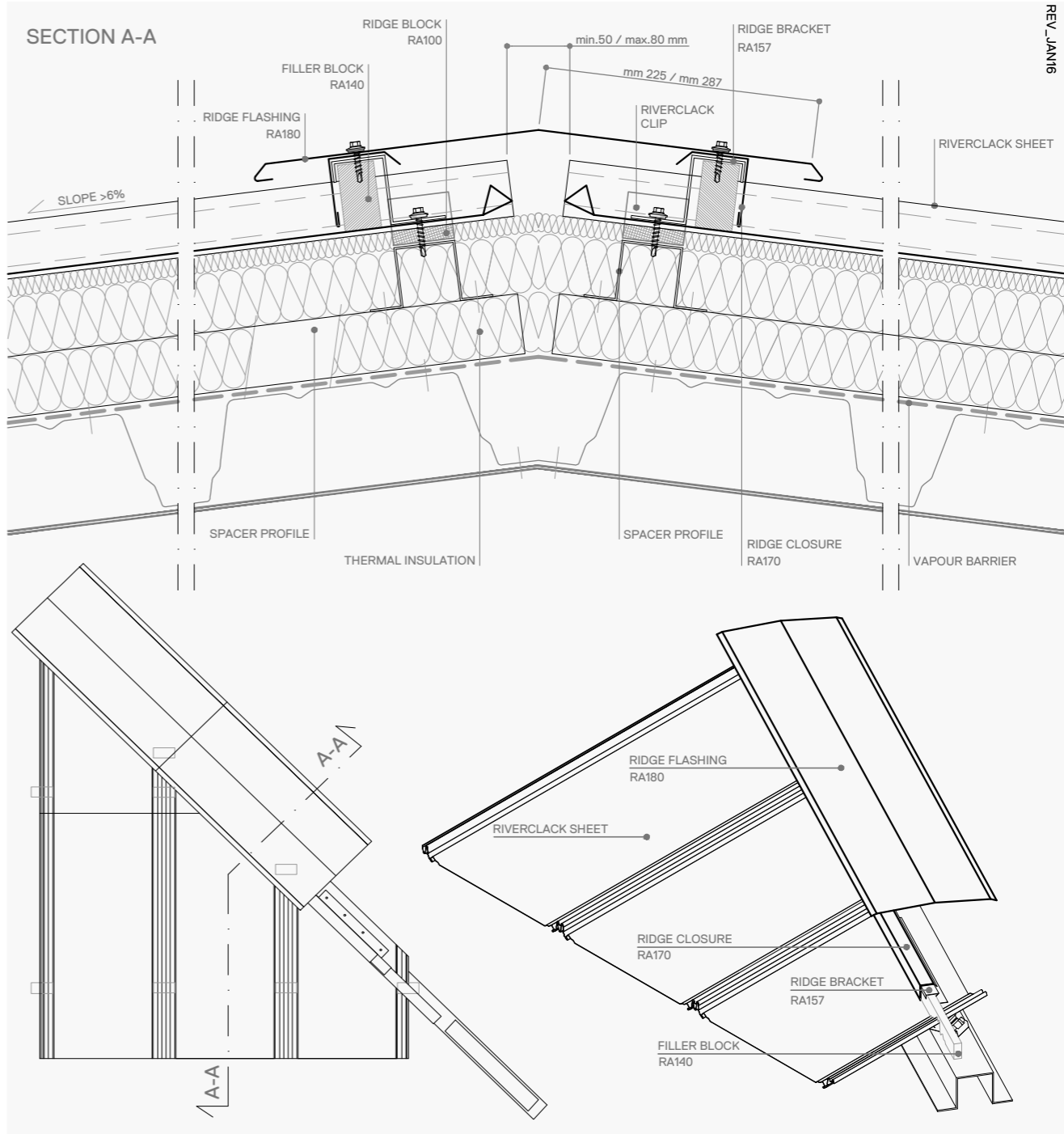

REV. JAN16

NOTES

For further enquiries please contact Iscom's technical department or your local representative.

WWW.RIVERCLACK.COM

MONO PITCH RIDGE STEEL STRUCTURE

DETAIL 02.01.S

TECHNICAL SITUATION / SCALE 1:5

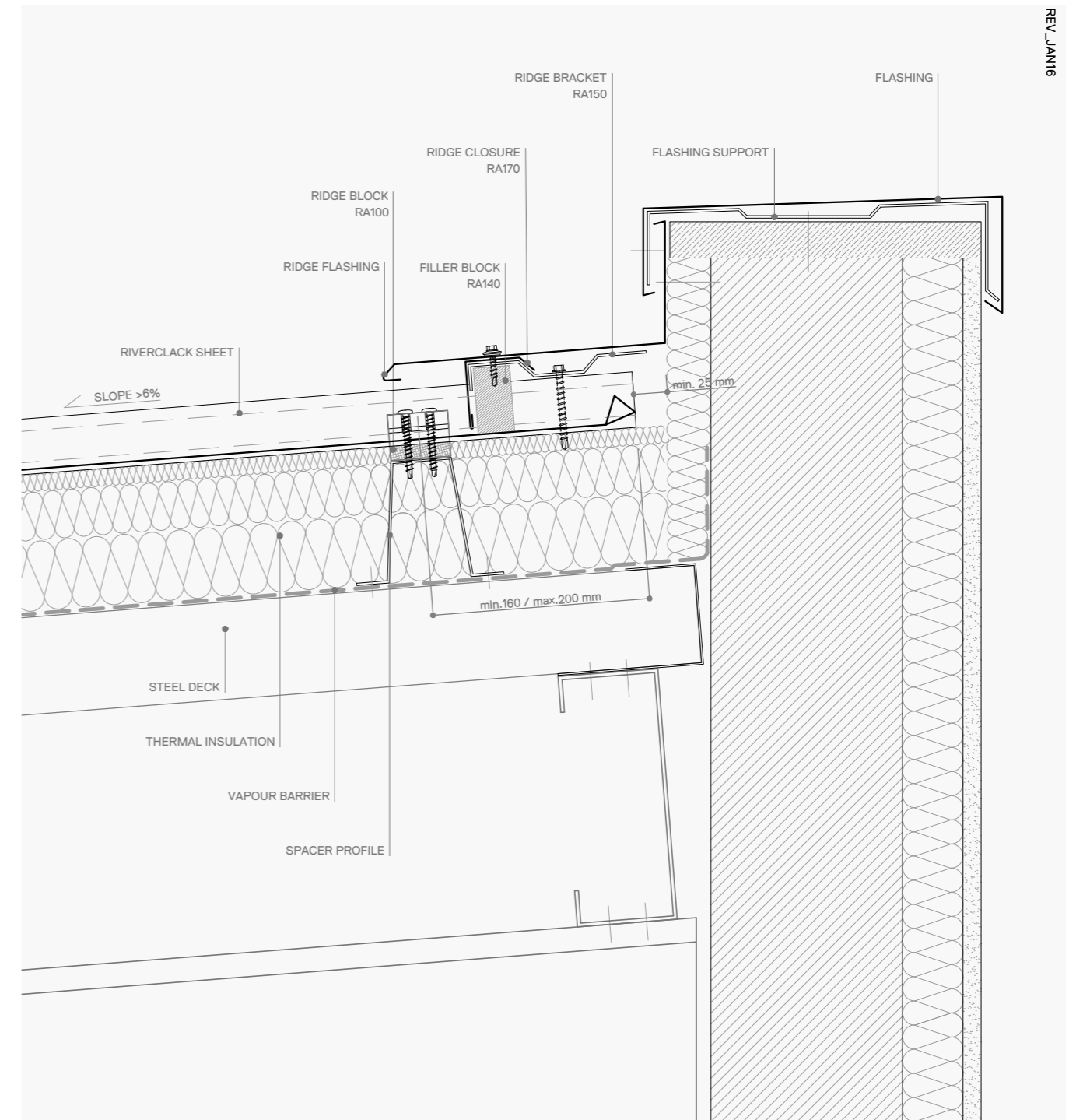

NOTES

- Slope > 6%
- If length of sheet > 20m use item RA120 as fixed point according to instructions or use two RA110 (up to max length 40m) according to instructions

For further enquiries please contact Iscom's technical department or your local representative.

WWW.RIVERCLACK.COM

MONO PITCH RIDGE STEEL STRUCTURE

DETAIL 02.02.S

TECHNICAL SITUATION / SCALE 1:5

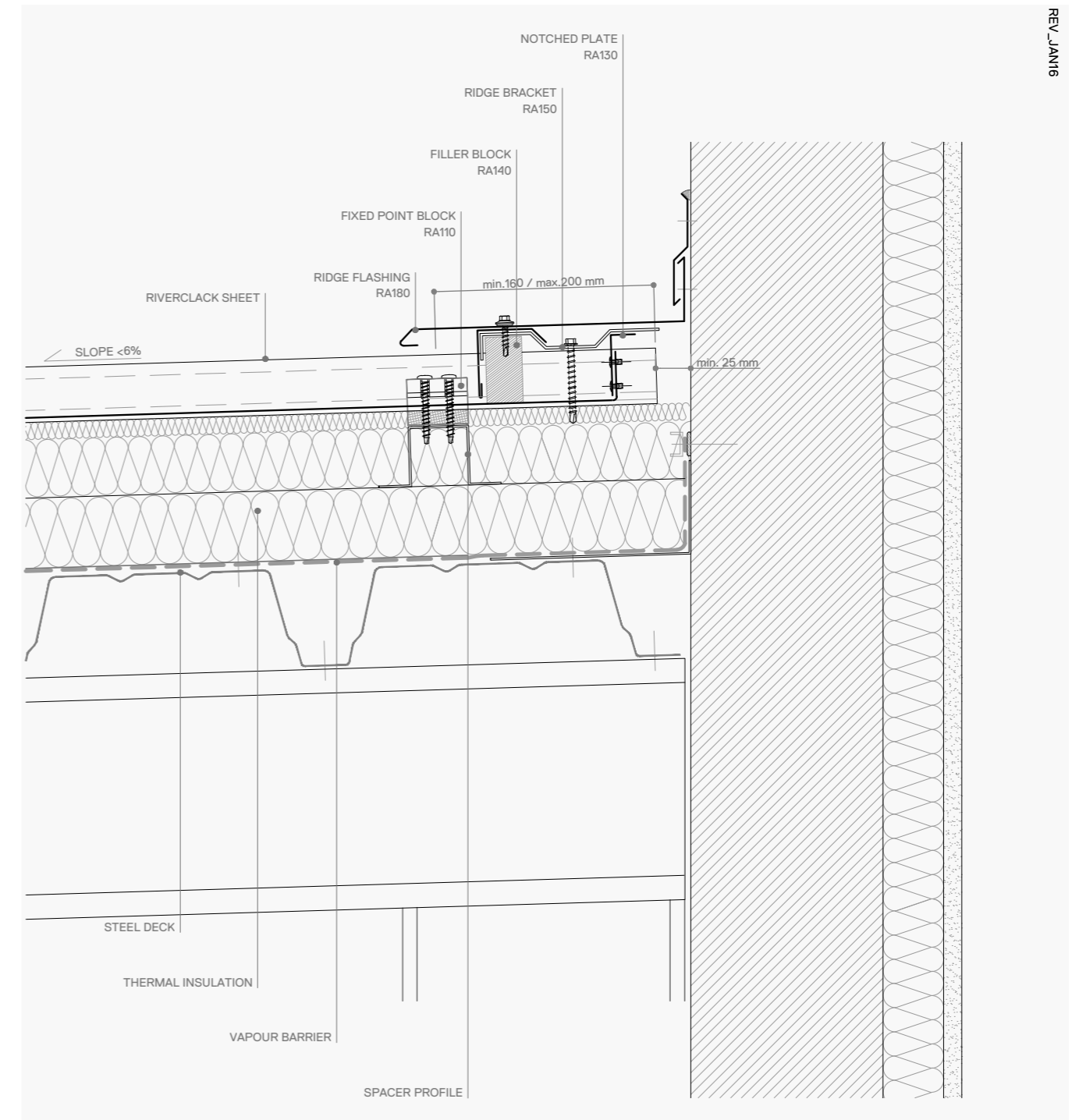

NOTES

- Slope <math>< 6\%</math>
- If length of sheet > 20m use item RA120 as fixed point according to instructions or use two RA110 (up to max length 40m) according to instructions

For further enquiries please contact Iscom's technical department or your local representative.

WWW.RIVERCLACK.COM

MONO PITCH RIDGE STEEL STRUCTURE

DETAIL 02.03.S

TECHNICAL SITUATION / SCALE 1:5

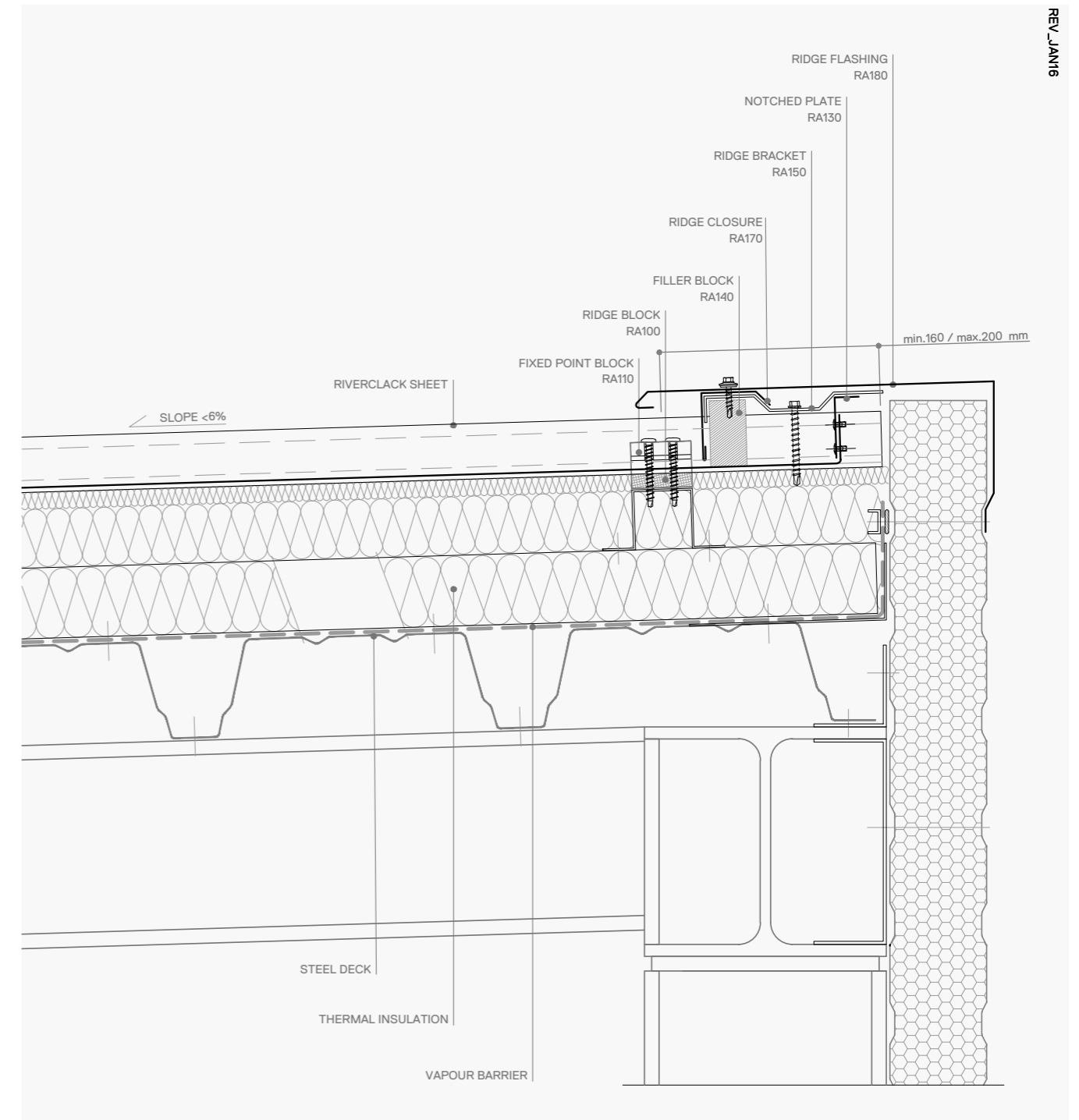

REV. JAM16

- NOTES
- Slope < 6%
 - If length of sheet > 20m use item RA120 as fixed point according to instructions or use two RA110 (up to max length 40m) according to instructions

For further enquiries please contact Iscom's technical department or your local representative.

WWW.RIVERCLACK.COM

MONO PITCH RIDGE STEEL STRUCTURE

DETAIL 02.04.S

TECHNICAL SITUATION / SCALE 1:5

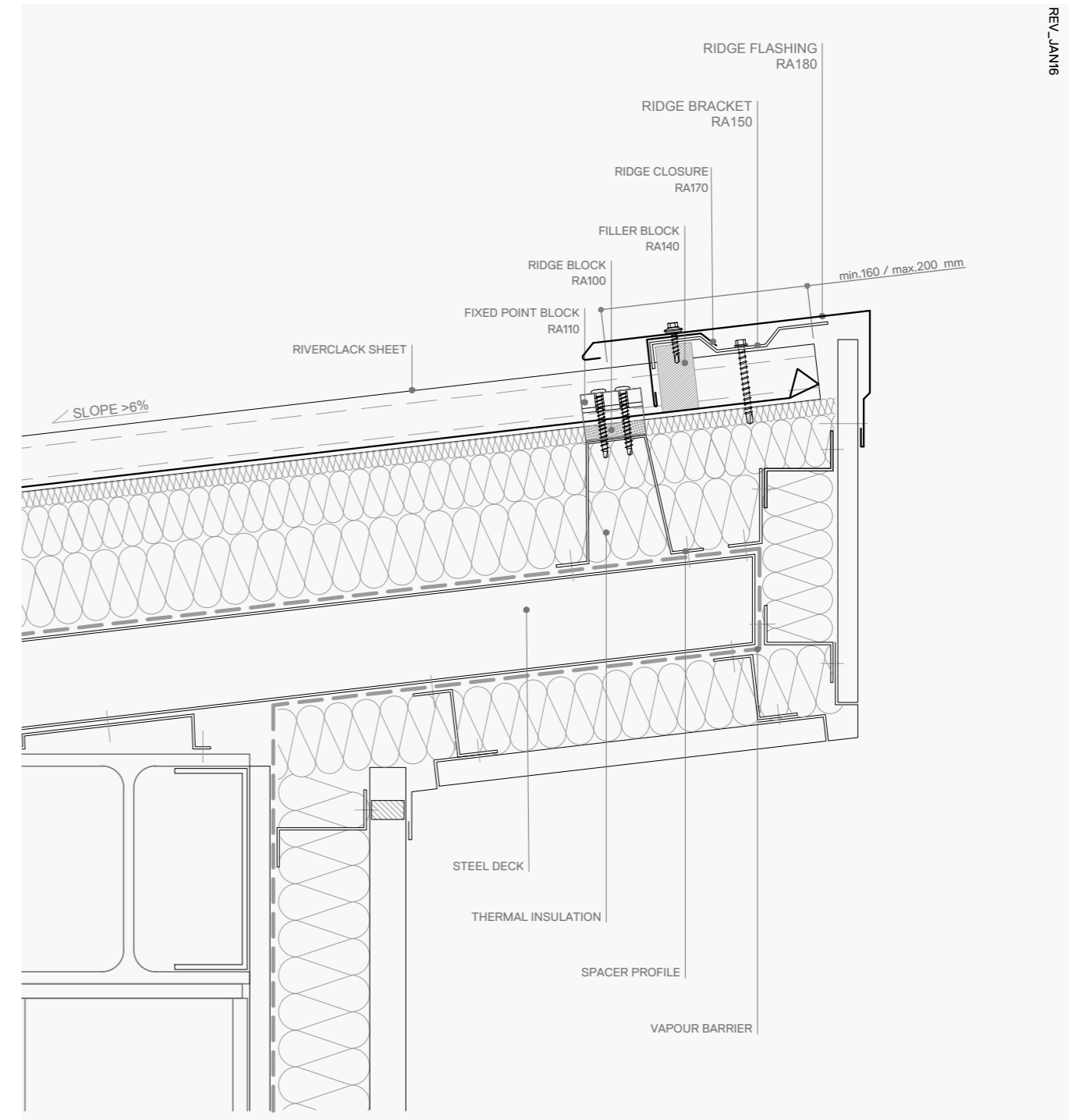

NOTES

- Slope > 6%
- If length of sheet > 20m use item RA120 as fixed point according to instructions or use two RA110 (up to max length 40m) according to instructions

For further enquiries please contact Iscom's technical department or your local representative.

WWW.RIVERCLACK.COM

PARAPET VERGE STEEL STRUCTURE

DETAIL 03.01.S

TECHNICAL SITUATION / SCALE 1:5

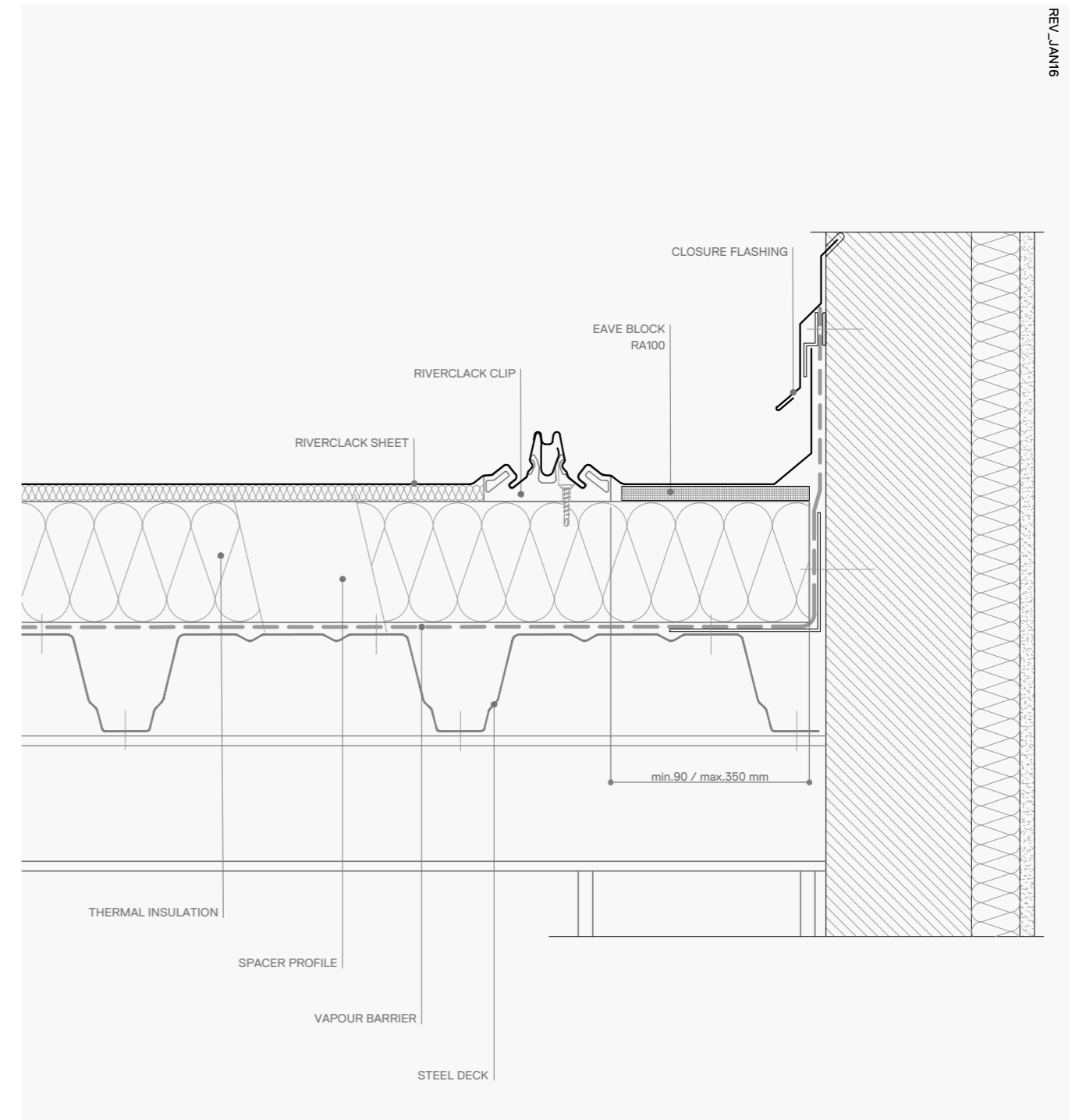

NOTES

For further enquiries please contact Iscom's technical department or your local representative.

WWW.RIVERCLACK.COM

PARAPET VERGE STEEL STRUCTURE

DETAIL 03.02.S

TECHNICAL SITUATION / SCALE 1:5

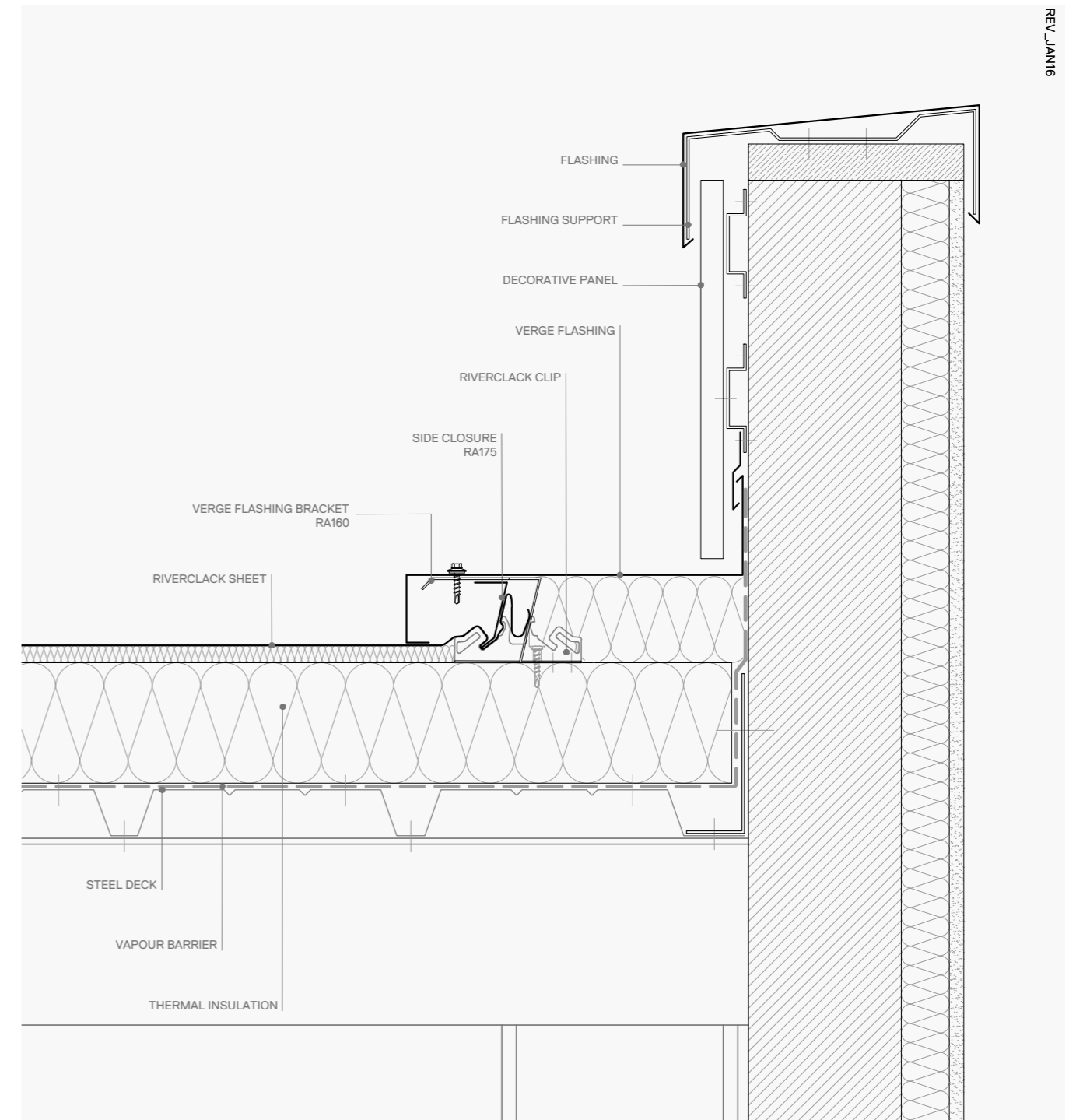

REV_JAM16

NOTES

For further enquiries please contact Iscom's technical department or your local representative.

WWW.RIVERCLACK.COM

OVERHANGING VERGE STEEL STRUCTURE

DETAIL 03.03.S

TECHNICAL SITUATION / SCALE 1:5

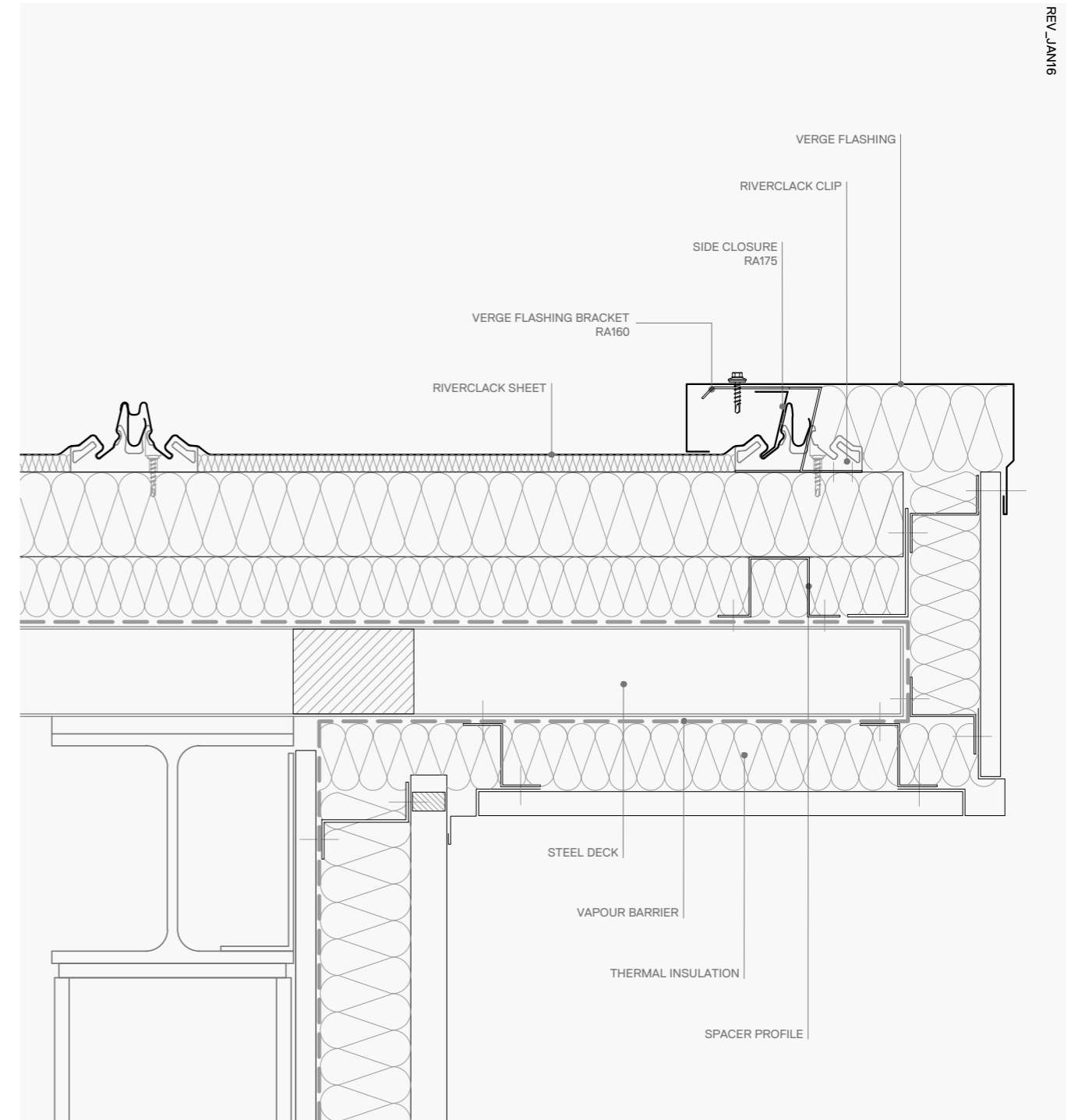

REV_JAM16

NOTES

For further enquiries please contact Iscom's technical department or your local representative.

WWW.RIVERCLACK.COM

EAVES GUTTER STEEL STRUCTURE

DETAIL 04.01.S

TECHNICAL SITUATION / SCALE 1:5

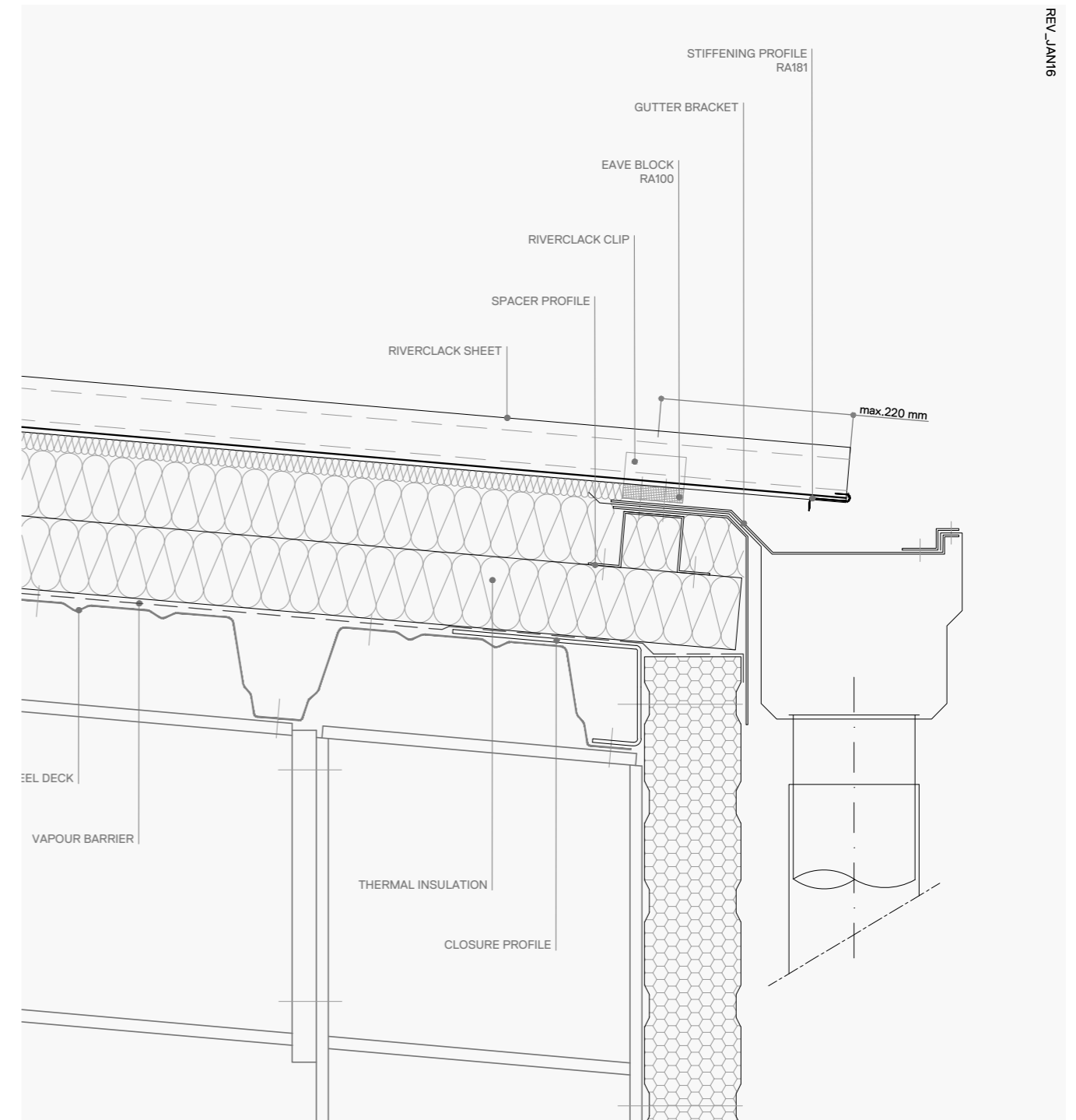

REV_JAM16

NOTES

For further enquiries please contact Iscom's technical department or your local representative.

WWW.RIVERCLACK.COM

PARAPET EAVES GUTTER STEEL STRUCTURE

DETAIL 04.02.S

TECHNICAL SITUATION / SCALE 1:5

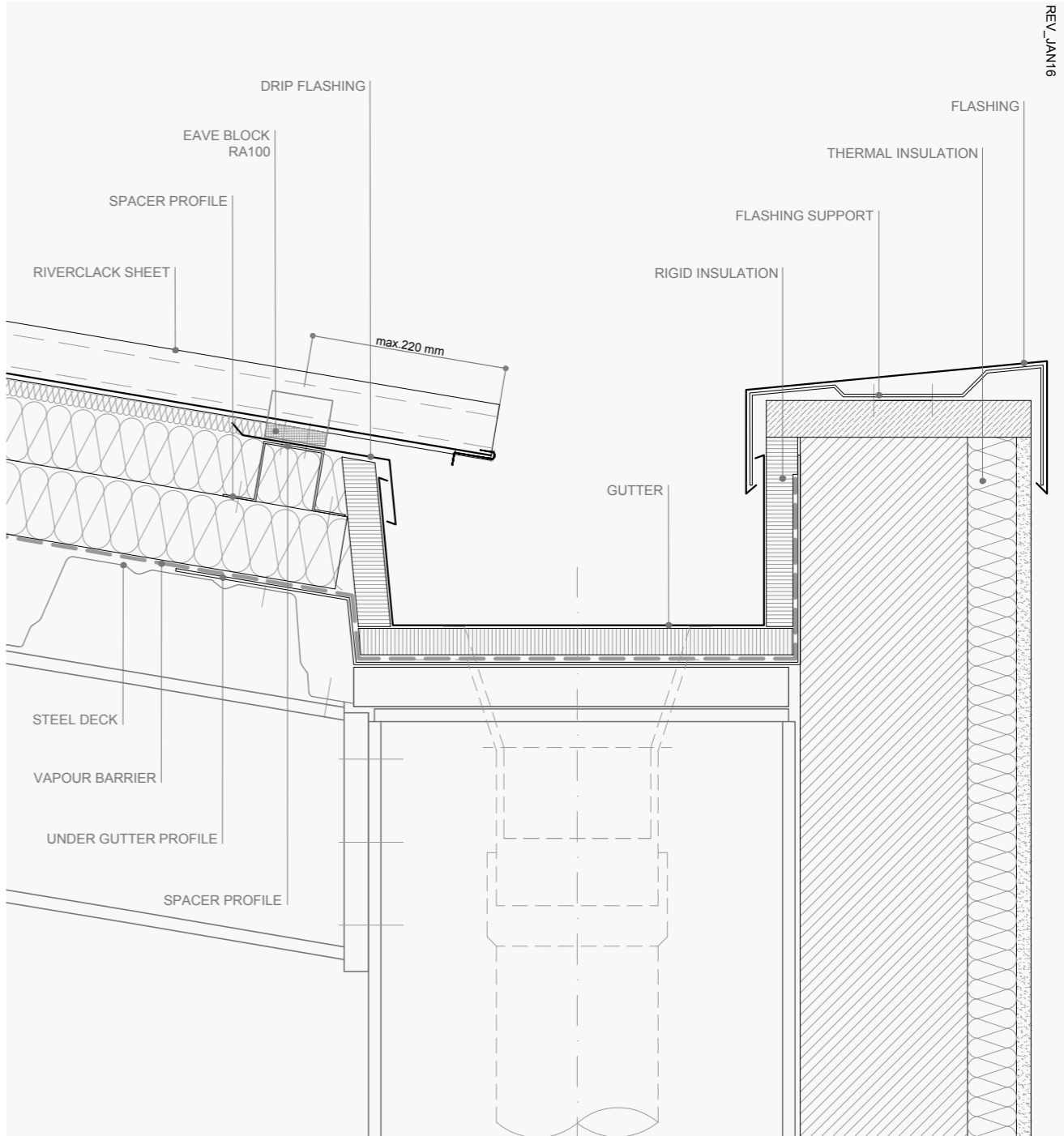

NOTES
 For further enquiries please contact Iscom's technical department
 or your local representative.
WWW.RIVERCLACK.COM

VALLEY GUTTER STEEL STRUCTURE

DETAIL 04.03.S

TECHNICAL SITUATION / SCALE 1:5

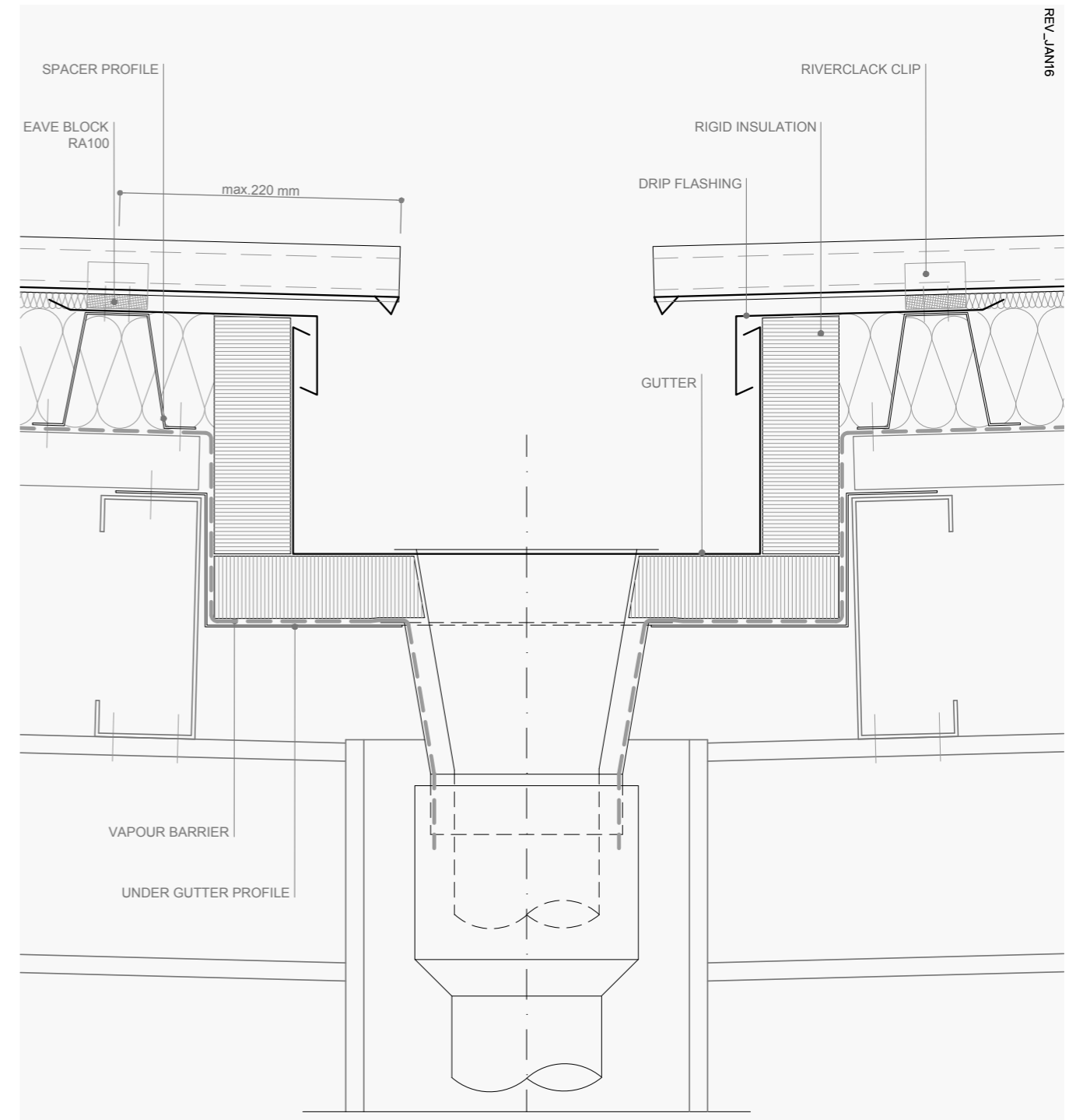

NOTES

For further enquiries please contact Iscom's technical department or your local representative.

WWW.RIVERCLACK.COM

INTERMEDIATE GUTTER STEEL STRUCTURE

DETAIL 04.04.S

TECHNICAL SITUATION / SCALE 1:5

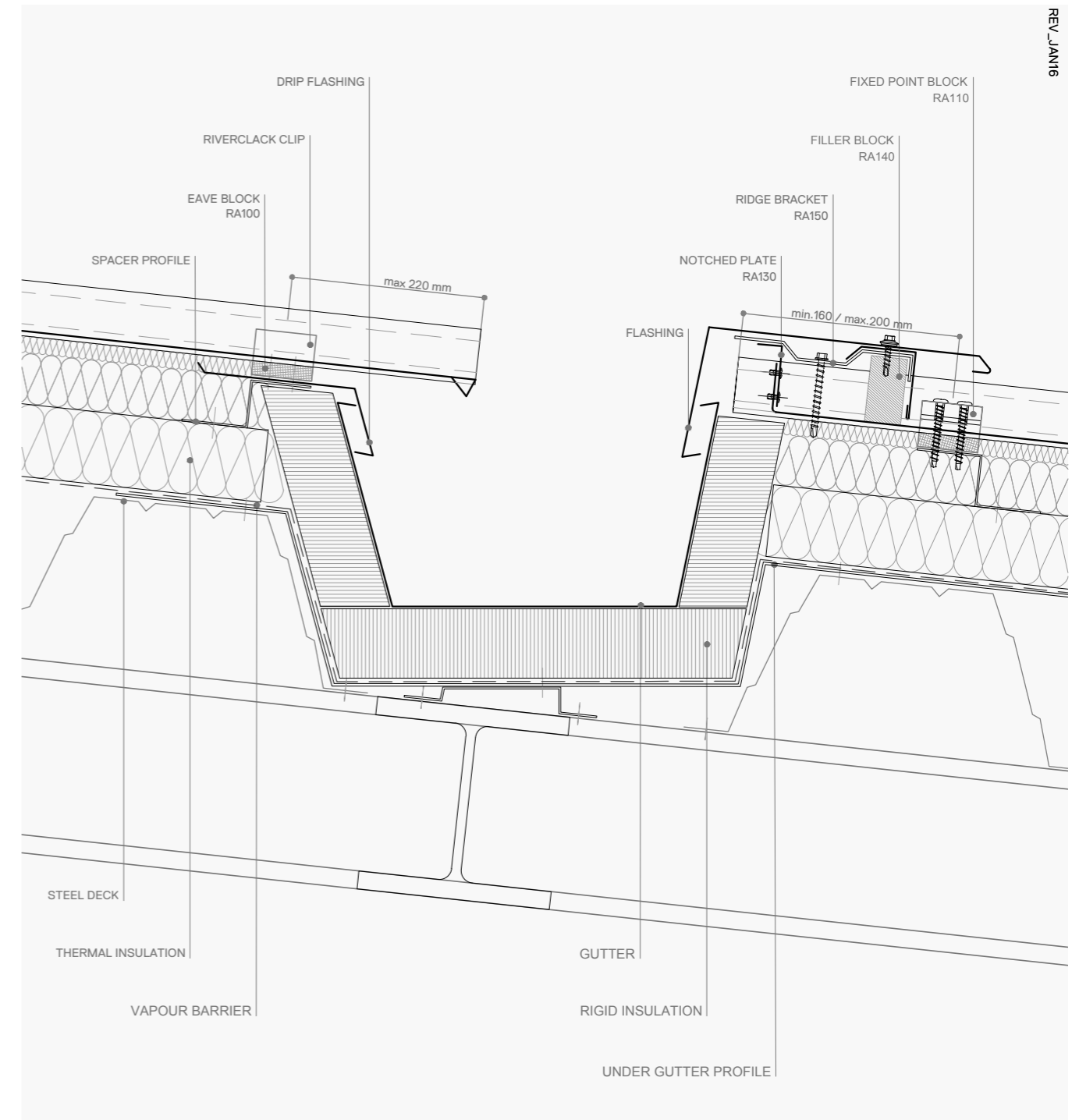

REV_JAM16

NOTES
 - Mono ridge type considered on this sheet is one of the available options. Please consider proper type according to actual slope.

For further enquiries please contact Iscom's technical department or your local representative.

WWW.RIVERCLACK.COM

BULLNOSE STEEL STRUCTURE

DETAIL 04.05.S

TECHNICAL SITUATION / SCALE 1:5

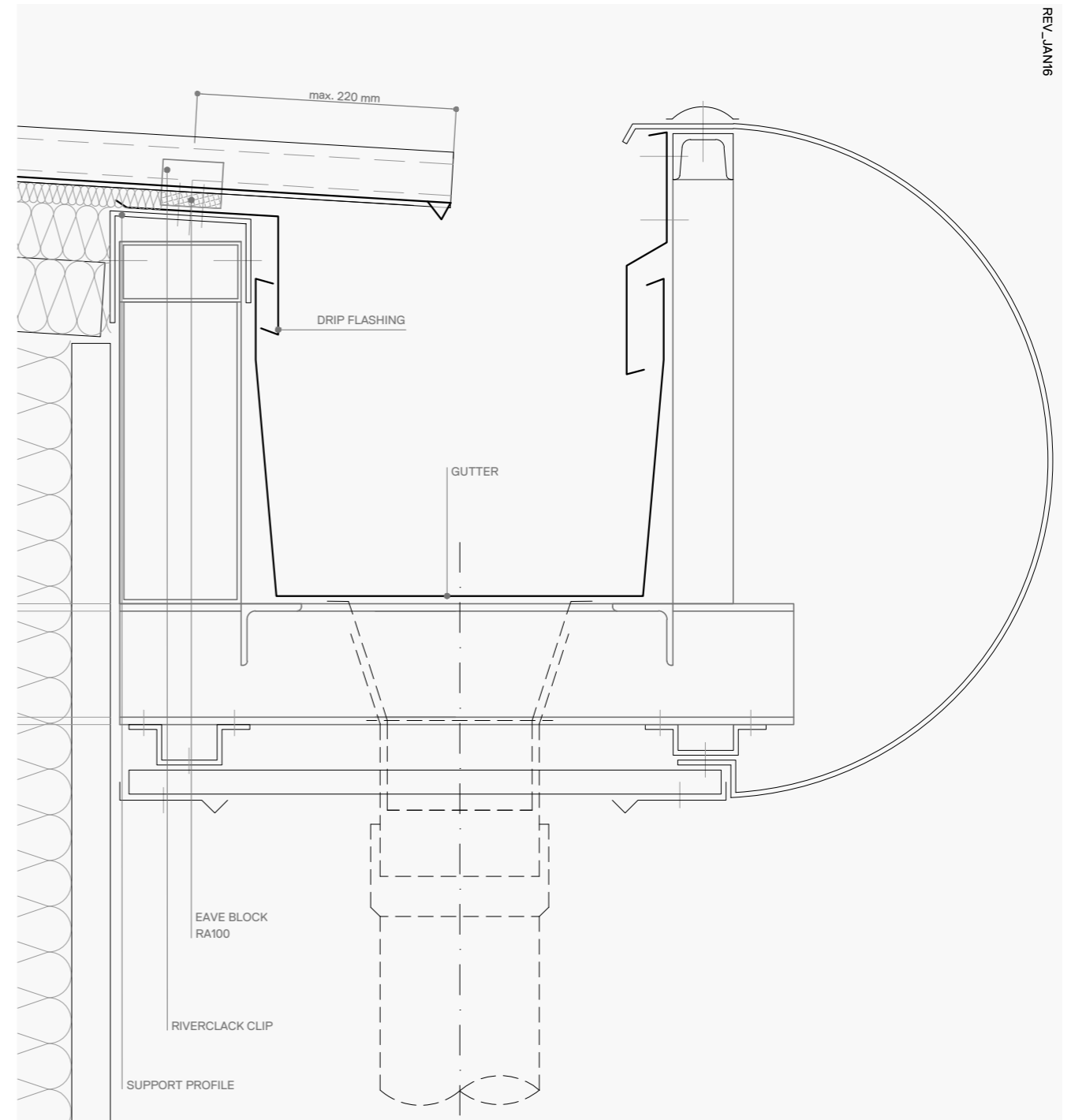

REV. JAN16

NOTES

For further enquiries please contact Iscom's technical department or your local representative.

WWW.RIVERCLACK.COM

EXPANSION JOINT STEEL STRUCTURE

DETAIL 05.01.S

TECHNICAL SITUATION / SCALE 1:5

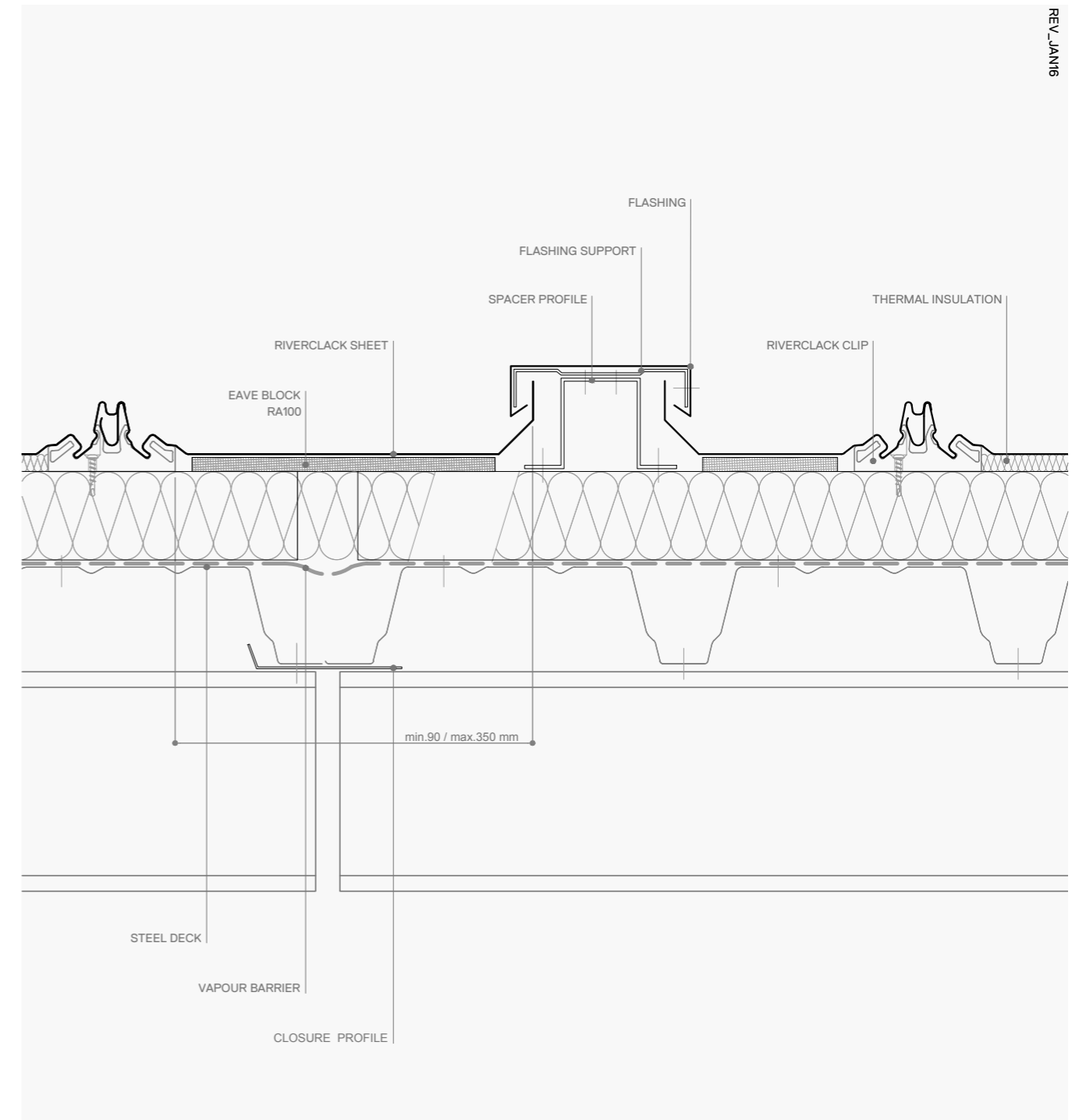

NOTES

- Expansion joint has to be calculated according to actual thermal movement

For further enquiries please contact Iscom's technical department or your local representative.

WWW.RIVERCLACK.COM

EXPANSION JOINT STEEL STRUCTURE

DETAIL 05.02.S

TECHNICAL SITUATION / SCALE 1:5

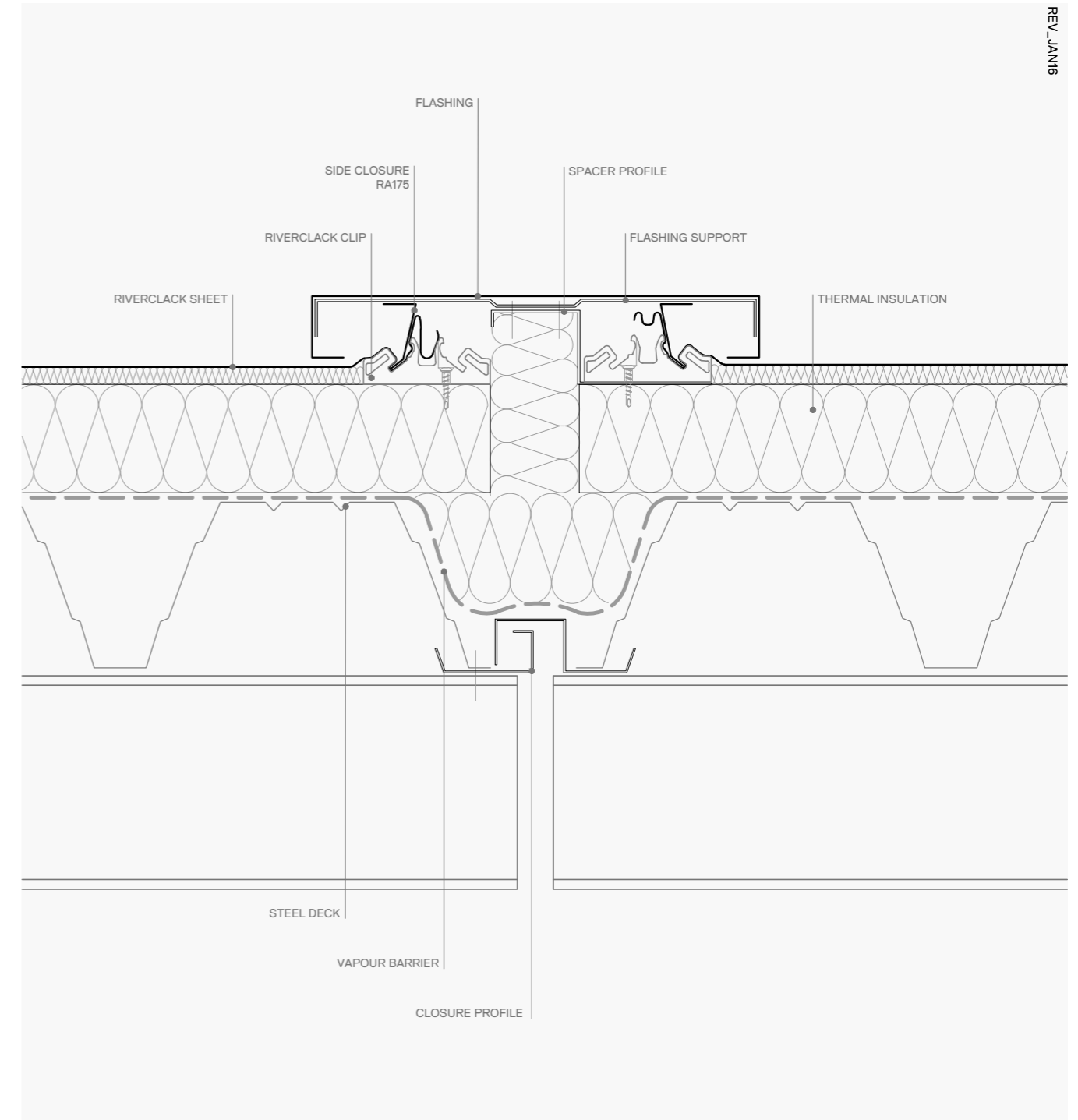

NOTES
- Expansion joint has to be calculated according to actual thermal movement

For further enquiries please contact Iscom's technical department or your local representative.

WWW.RIVERCLACK.COM

PIPE PENETRATION STEEL STRUCTURE

DETAIL 06.01.S

TECHNICAL SITUATION / SCALE 1:5

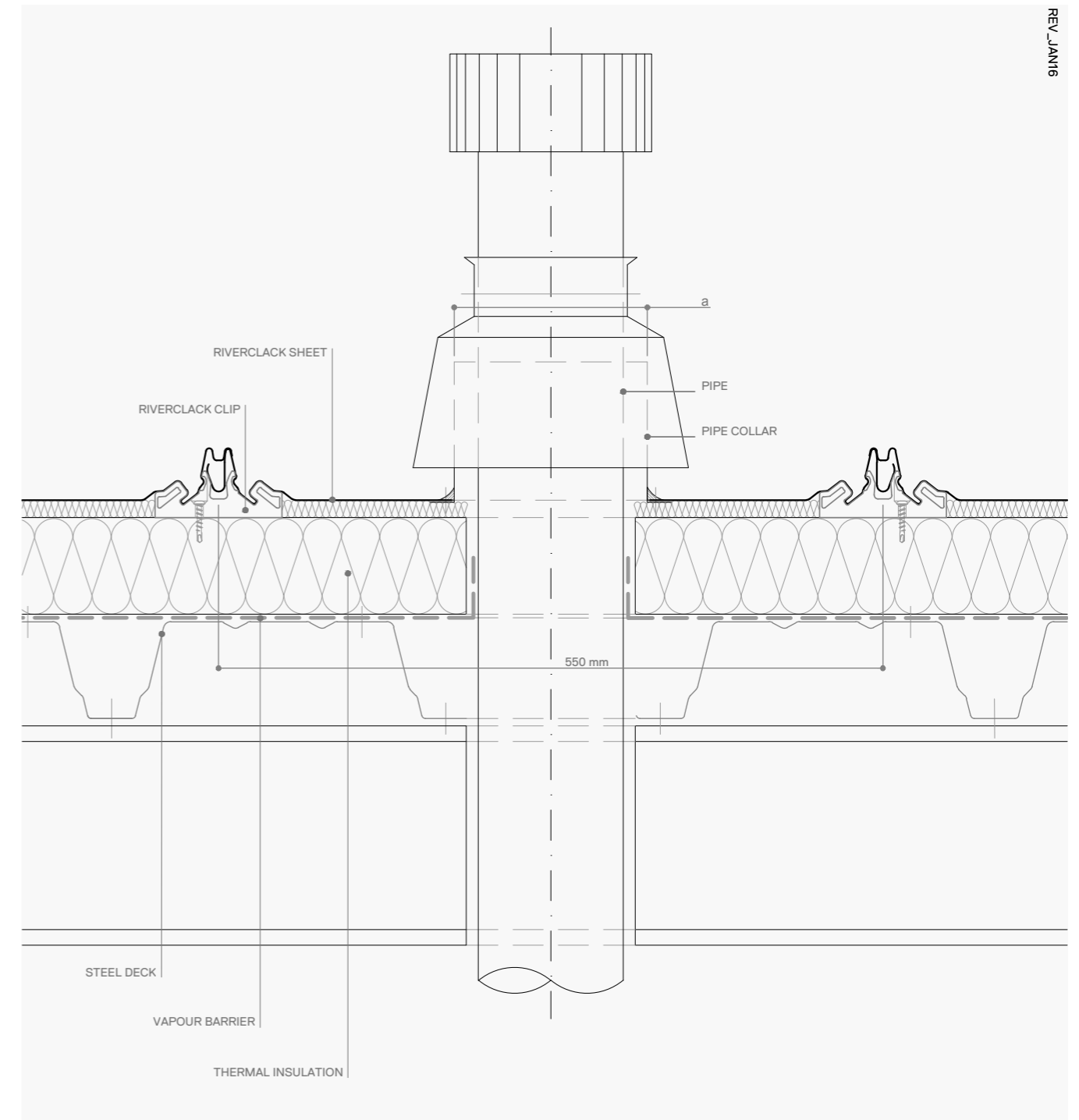

NOTES

- Dimension "a" has to be calculated according to actual thermal movement

For further enquiries please contact Iscom's technical department or your local representative.

WWW.RIVERCLACK.COM

RIDGE SKYLIGHT STEEL STRUCTURE

DETAIL 07.01.S_AA

TECHNICAL SITUATION / SCALE 1:5

REV. JAN16

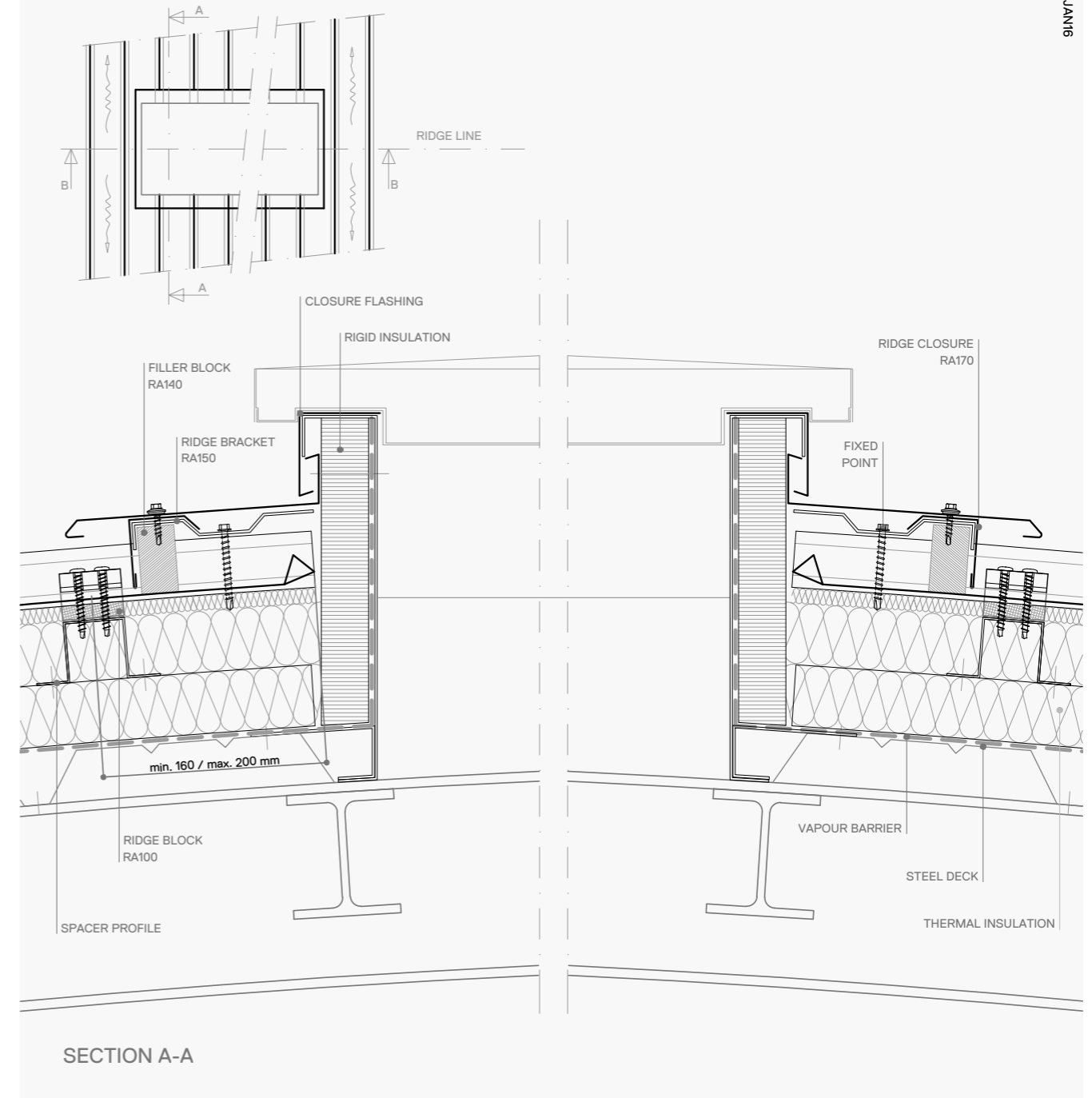

- NOTES
- Slope > 6%
 - If slope < 6% please use relevant detail
 - Mono ridge type considered on this sheet is one of the available options. Please consider proper type according to actual slope.

For further enquiries please contact Iscom's technical department or your local representative.

WWW.RIVERCLACK.COM

RIDGE SKYLIGHT STEEL STRUCTURE

DETAIL 07.01.S_BB

TECHNICAL SITUATION / SCALE 1:5

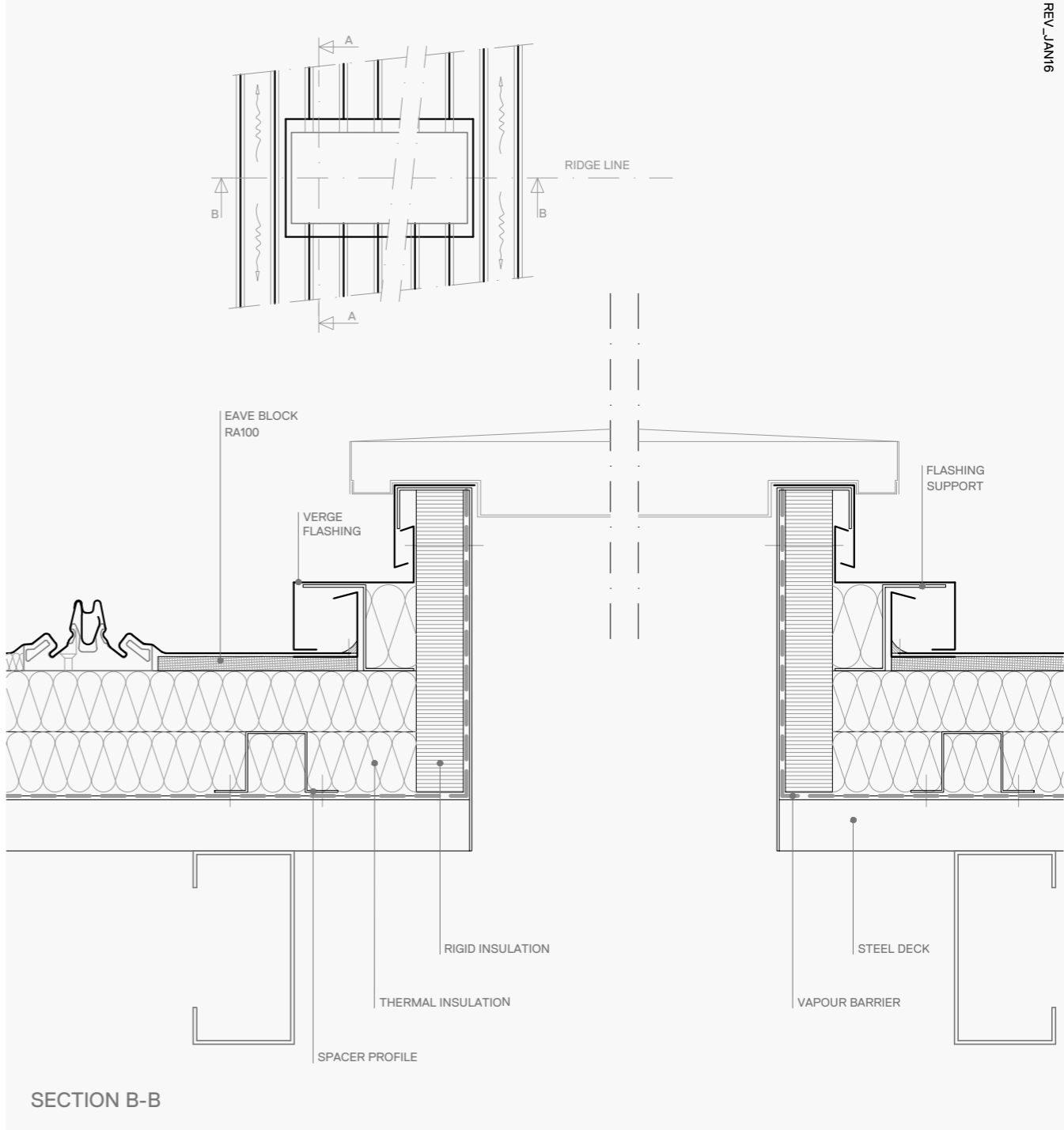

NOTES
- Verge type is just one of the possible options. Please see in chapter 03 for alternatives.

For further enquiries please contact Iscom's technical department or your local representative.

WWW.RIVERCLACK.COM

WELDED ROOFLIGHT STEEL STRUCTURE

DETAIL 07.02.S_AA

TECHNICAL SITUATION / SCALE 1:5

REV_JAM16

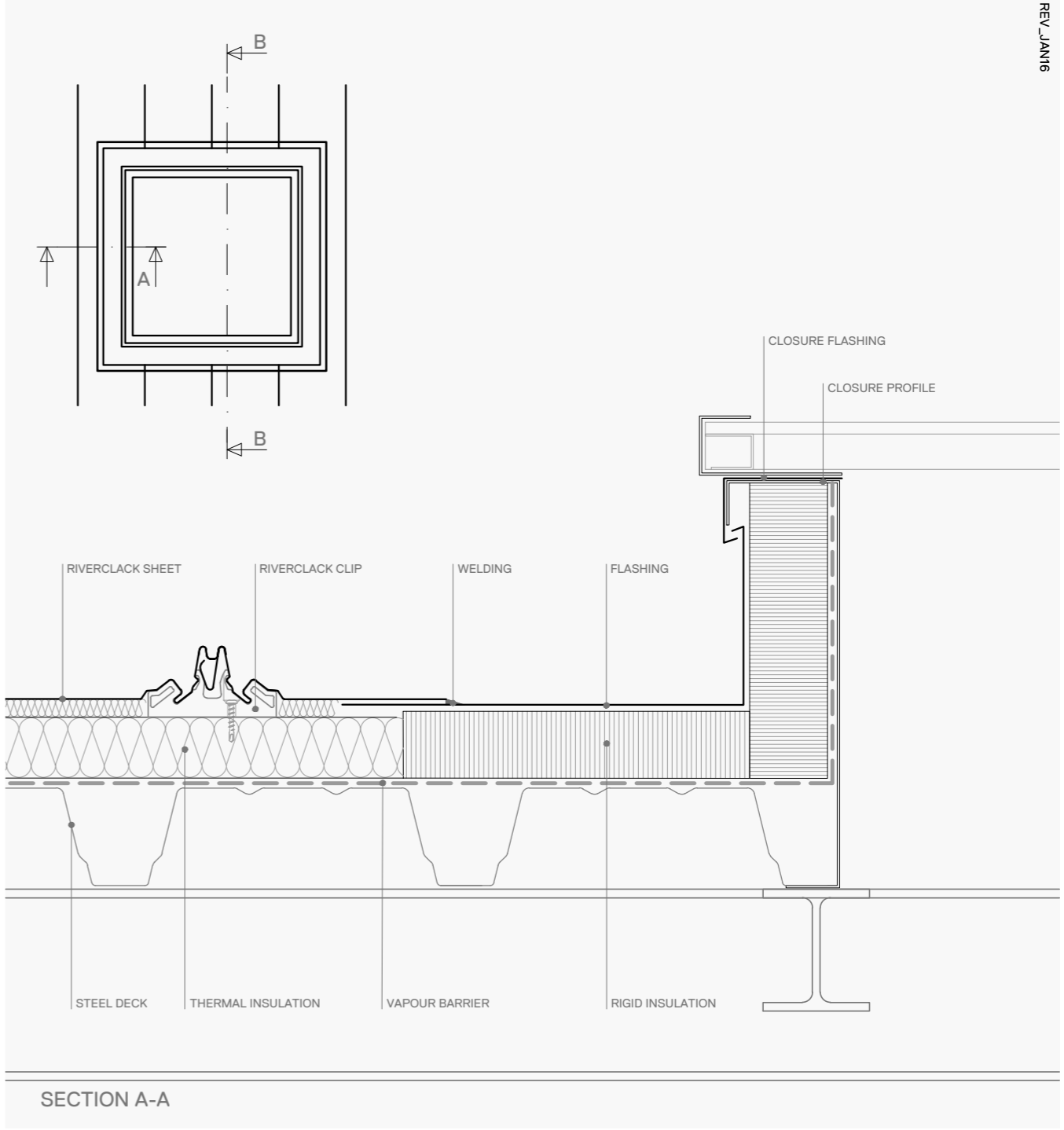

SECTION A-A

NOTES

For further enquiries please contact Iscom's technical department or your local representative.

WWW.RIVERCLACK.COM

WELDED ROOFLIGHT STEEL STRUCTURE

DETAIL 07.02.S_BB

TECHNICAL SITUATION / SCALE 1:5

REV. JAN16

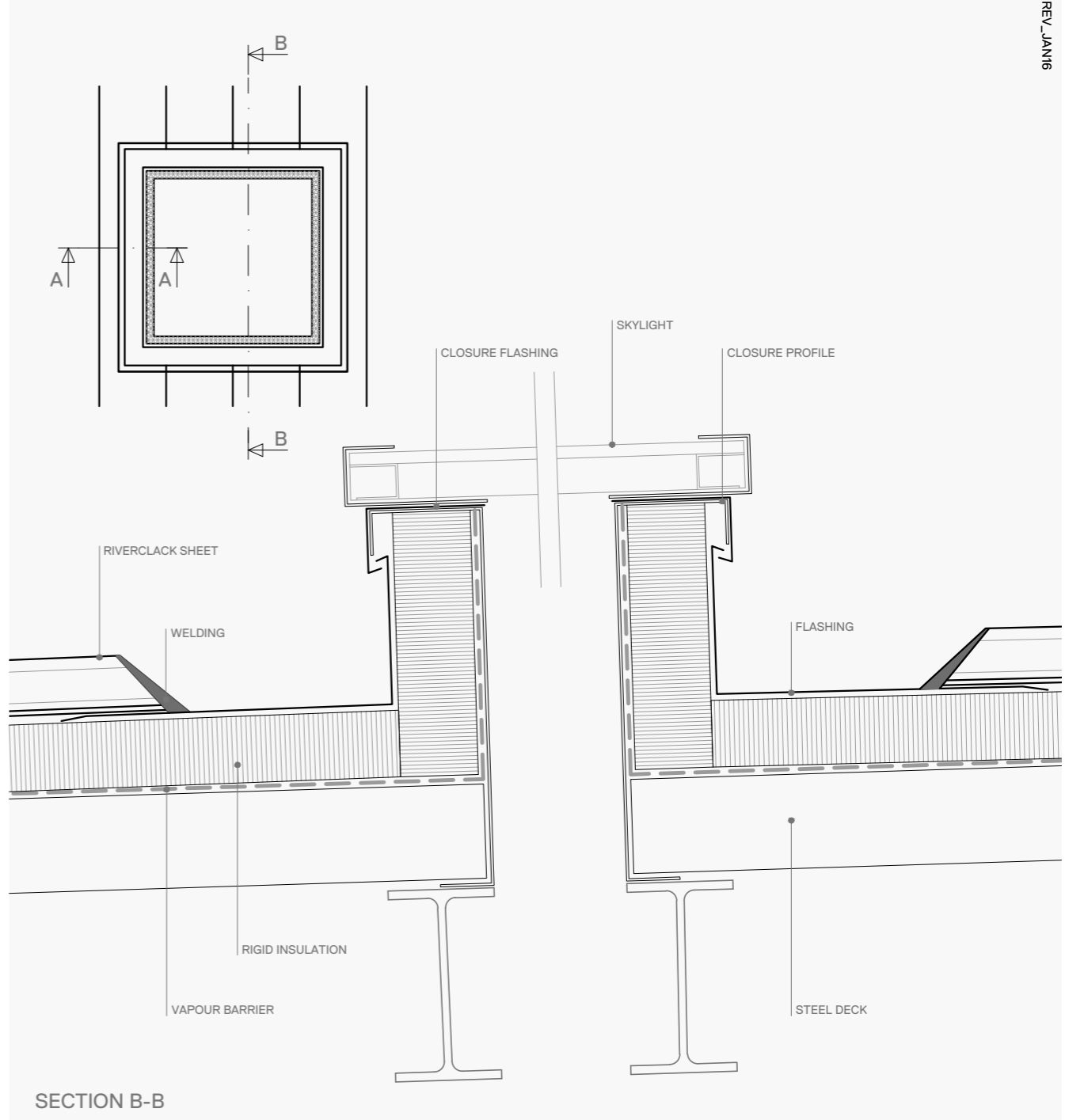

SECTION B-B

NOTES
 For further enquiries please contact Iscom's technical department
 or your local representative.
WWW.RIVERCLACK.COM

OVERLAP DETAIL STEEL STRUCTURE

DETAIL 08.01.S

TECHNICAL SITUATION / SCALE 1:5

REV. JANIS

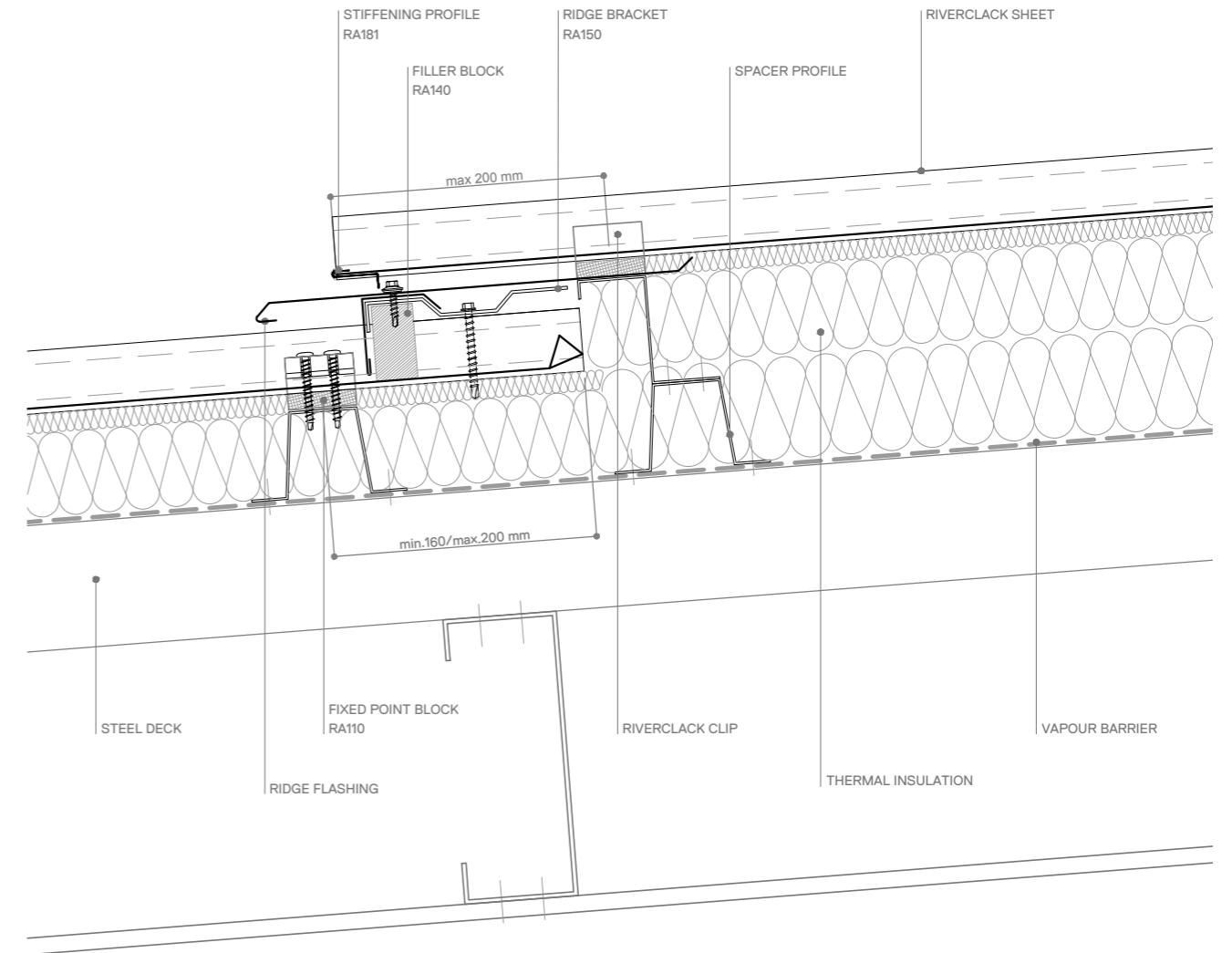

NOTES

- Walkability is not allowed on overlapping areas
- Mono ridge considered on this sheet is one of the available options. Please consider proper type according actual slope.

For further enquiries please contact Iscom's technical department or your local representative.

WWW.RIVERCLACK.COM

OVERLAP DETAIL STEEL STRUCTURE

DETAIL 08.02.S

TECHNICAL SITUATION / SCALE 1:5

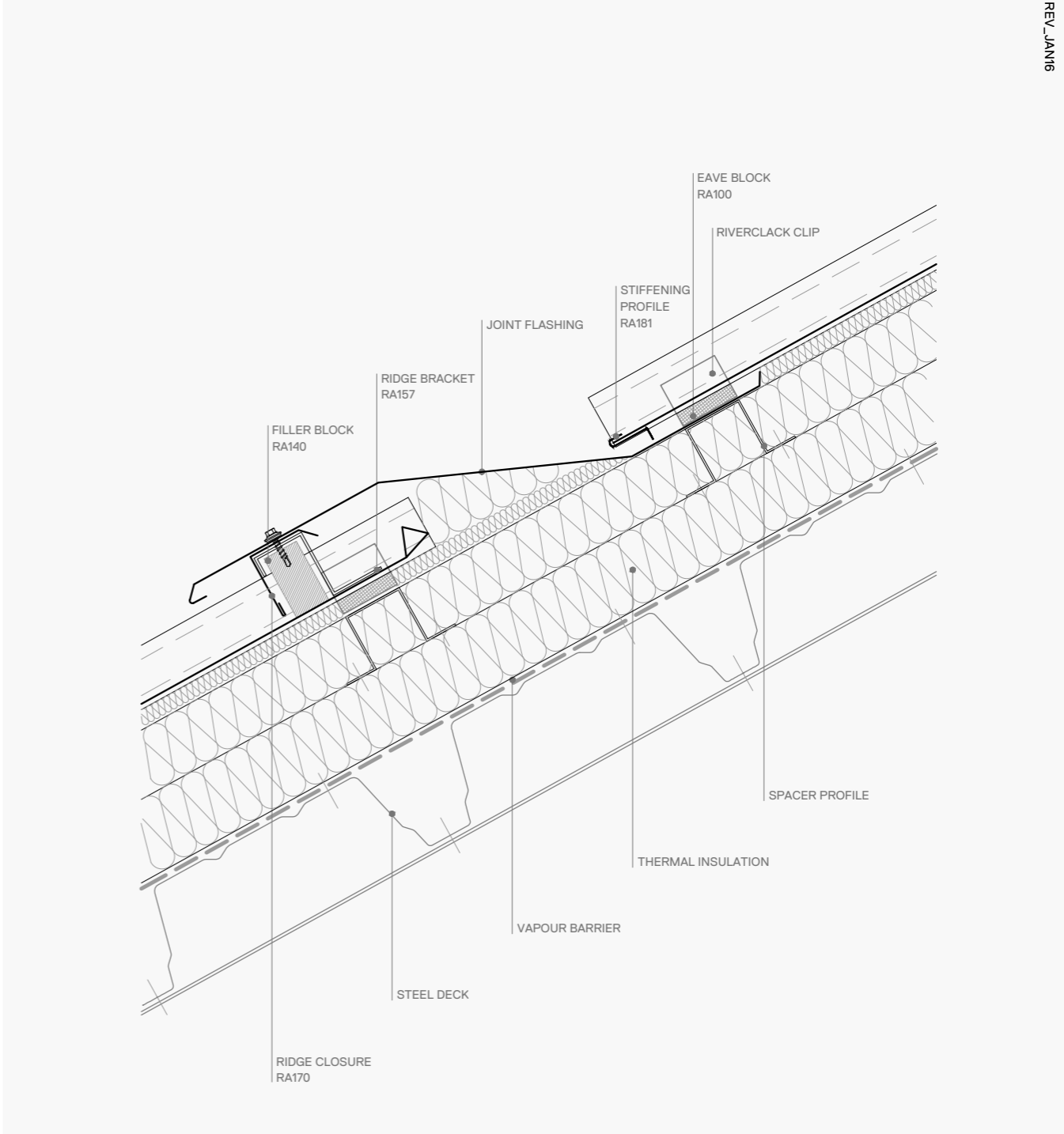

REV_JAN16

NOTES

For further enquiries please contact Iscom's technical department or your local representative.

WWW.RIVERCLACK.COM

CURVED ROOF RIDGE STEEL STRUCTURE

DETAIL 09.01.S

TECHNICAL SITUATION / SCALE 1:5

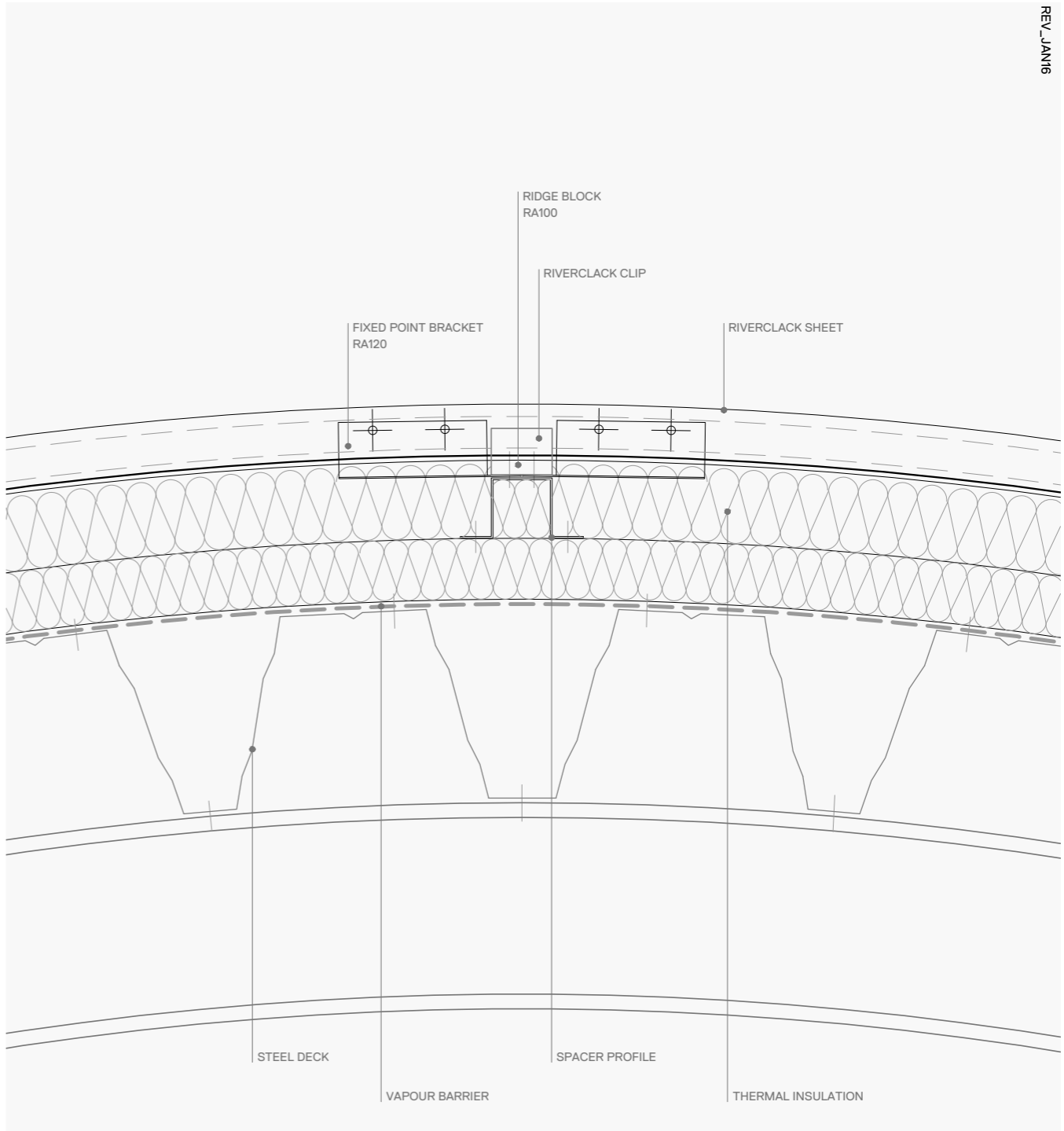

REV_JAN16

NOTES
- Slope > 6%
- RA120 item to be used according to technical datasheet

For further enquiries please contact Iscom's technical department or your local representative.

WWW.RIVERCLACK.COM

EN_2

ISCOM SPA
VIA BELVEDERE, 78
37026 PESCANTINA
ITALY

WWW.ISCOM.IT
INFO@ISCOM.IT
T +39 045 773 2177
F +39 045 773 2970

