

N1 ROLL FORMING LINE mod. PRHS 18/550
for highway barrier 2 corrugations

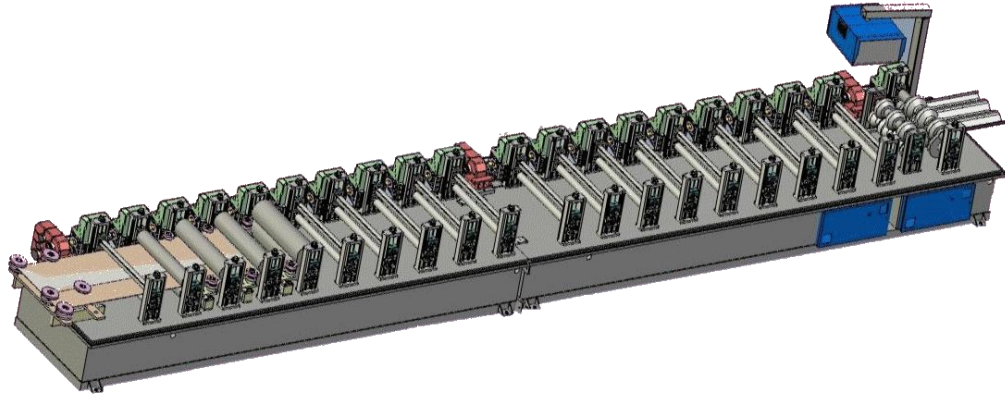

MAINS FEATURES

. Material to be processed	:	Coils
- Type	:	Mild / galvanised steel
- Max weight	Kg	: according to decoiler
- Maximum thickness	mm	: 35/10 ^e
- Max. production speed	m/1'	: 20
. Electrical supply	V	: 400
	Hz	: 50
. Going sense	:	left/right
. Total installed power	a.c. HP	: 20+20 (brushless + control / inverter)
	a.c. HP	: 17,5



DESCRIPTION

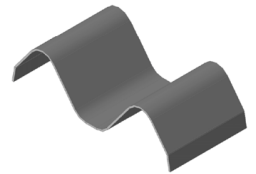
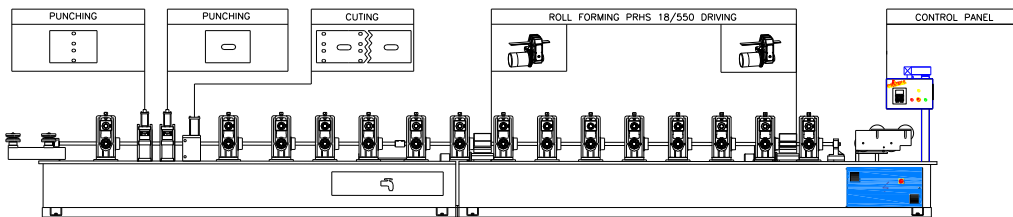

① ROLL FORMING MACHINE PRHS 18/550

. Maximum width between stands	mm	:	550
. Maximum width over stands	mm	:	0
. Diameter of shafts	mm	:	85
. Number of forming stations	N	:	15 (frame allowed for 18)
. Motor	HP	:	20+20

- **one piece table**, from planed steel with lining up grooves for the transmission uprights
- N2+13 stations with special **cast-iron stands**, housing large bearings of the best domestic and foreign brands.
- Steel roller shafts, entirely ground with 10 mm slots.
- **Upper roller shafts adjustable** according to the thickness to be worked, with graded vernier scale for setting.
- **Adjustable** introducing **guides** to line up the strips on the different sets of rolls

- Group of straighteners lined up on each set of rollers
- Geared motor (a.c. with electronic control), **HP 20+20** with **direct connection** to the powering's shaft
- **One piece** transmission shaft \varnothing mm 40 from the motor **to the different stations** with conical gears
- Start up directly from the main electrical panel, or from a **remote control** box with forward and backward.

* *special plant with punching + cutting before roll forming :*

- *n2 first stations for introduction / straightening / centering*
- *electronic driving control + coupling gear to the n13 forming stations for a smooth & continuous process*

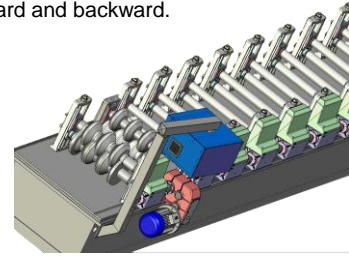

② ELECTRICAL EQUIPMENT AND HANGING UP ADJUSTABLE CONTROL PANEL

- industrial **P.C.** mod **SNAP** :
 - **graphical** l.c.d. **touch screen**
 - **windows XP** operation
 - **P.C.** office **connection**
- independent **CNC control** of :
 - punching
 - cutting
 - synchronisation control for introducing / punching – cutting / roll forming



③ HYDRAULIC PLANT

. Tank	L	:	250
. Hydraulic unit motor pump	HP	:	17,5

- Adjustable frame after the rolling machine, for the right positioning and lining up of the different cutting units with the suited sets of rolls.



④ SETS OF ROLL FORMERS in special tempered and rectified steel as drawings attached

N1 complete set of roll formers + straightener for **highway barrier 2 corrugations** :

- n2 couples of rolls for introduction / straightening / centering / with coupling gear and synchronisation control
- n13 couples of forming rolls

