

Roof installations

ALNOR reserves the right to modify technical specifications
in line with the policy of continuous product improvement.

System description

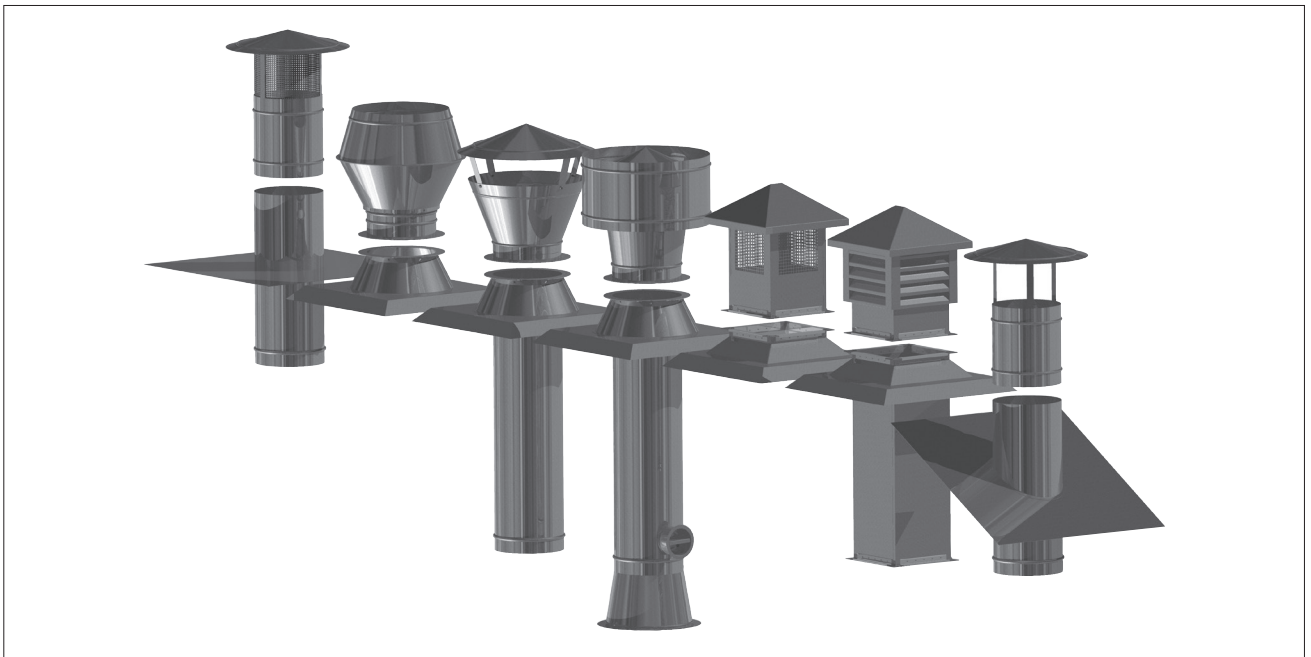

System description

Roof installations such as air intake units, roof exhaust vents and roof bases, combined with ducts and fittings, provide a complete ventilation system. The wide range of various types and versions allow adapting roof ventilators to virtually any design requirements.

Dimensions

All round roof installations are available with diameters matching those of SPIRAL® system round fittings and steel flanges. Square roof installations need to be adjusted to the dimensions of the existing ductwork and fittings.

Marking

ALNOR products carry the Polish conformity mark B for construction products and product codes as shown in the technical specifications listed in this catalogue.



Application advantages

Roof installations enable air intake and exhaust to and through the building roof, while providing a water-, heat- and air-tight seal at the roof penetration. The aesthetic finish and the available sizes help achieve a perfect match for a specific ductwork design, required air flow ratings, and the final appearance of the roof.

Installation instructions

Roof ventilators are fastened to the roof bases with screws for joining the mating steel flanges. The roof bases are fastened to roof ventilator units in the same way as when they are fastened to standard air intake units or roof exhaust vents. Depending on the bottom part, the roof base is fastened to the connected ductwork with self-drilling screws or flanges with steel screws.

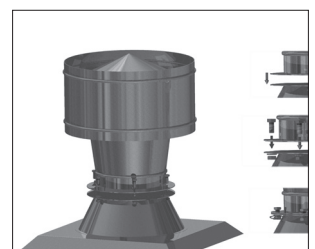
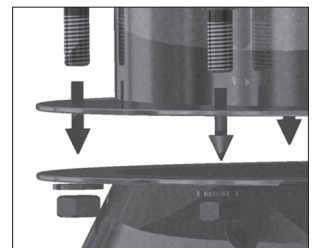
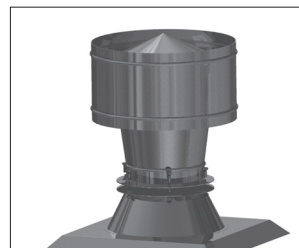

Roof base for round ductwork systems

PD-B1



Description

The type B1 lightweight roof bases are suitable for round ductwork systems. The standard version is made from galvanized steel sheet and designed for flat roofs. The top part of the roof base comes with a FLS steel flange in the standard version. The roof base is available on request with a male connector or a connector provided with an EPDM rubber gasket. Other versions available on request include roof bases designed for sloping roofs or made from stainless steel sheet or aluminium sheet. The roof base is a perfect match for roof intakes, roof exhaust vents, and roof ventilators (fans).

Available materials — Product code examples

- PD-B1-...-... - galvanized steel sheet
- PD-B1-K-...-... - 1.4301/304 stainless steel sheet
- PD-B1-A-...-... - aluminium sheet

Product code example

Product code: **PD-B1 - aaa - bbb**

type			
Ød			
installation*			

* GALA - EPDM gasket

* NS - male connection w/o gaskets

Dimensions

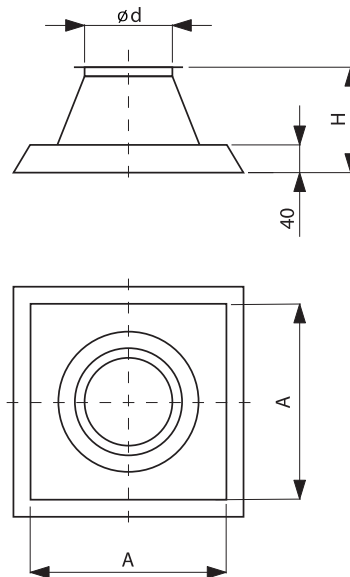

$\varnothing d_{nom}$ [mm]	A [mm]	H [mm]	Weight [kg]
100	280	180	2.10
125	300	180	2.22
140	360	180	2.79
150	380	180	2.78
160	400	180	2.90
200	440	180	3.32
250	470	200	4.10
300	510	200	4.68
315	530	200	4.93
355	610	200	5.72
400	630	200	6.06
450	720	200	6.97
500	740	200	7.31
560	800	240	9.36
630	900	240	10.80
710	1020	240	12.83
800	1100	280	14.76
1000	1270	280	18.29

Roof base with duct for spiral ductwork systems

PD-B2**Description**

The type B2 roof bases are designed for flat roofs. Versions available on request can be installed on roof slopes up to 30 degrees. The top part of the product has a FLS steel flange for installation of a roof air intake, a roof exhaust vent, a silencer, or a roof ventilator (fan). The steel flange provides a sturdy joint which can easily withstand vibration generated by fan units. Versions available on request can also have a male connection which can be provided with an EPDM gasket for female-connection air intake units/exhaust vents in ventilation systems not exposed to high vibration levels or strong gusts of wind. The bottom of the roof base is designed for direct fastening to spiral ducts, female connectors and fittings. The product can be made from stainless steel or aluminium sheet on request (aluminium roof bases are available with a male connection only).

Available materials — Product code examples

PD-B2-...-... - galvanized steel sheet

PD-B2-K-...-... - 1.4301/304 stainless steel sheet

PD-B2-A-...-... - aluminium sheet

Product code example

Product code: **PD-B2 - aaa - bbb**

type _____
 Ød _____
 installation* _____

* GALA - EPDM gasket

* NS - male connection w/o gaskets

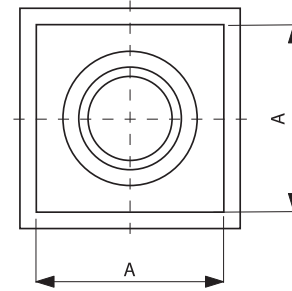
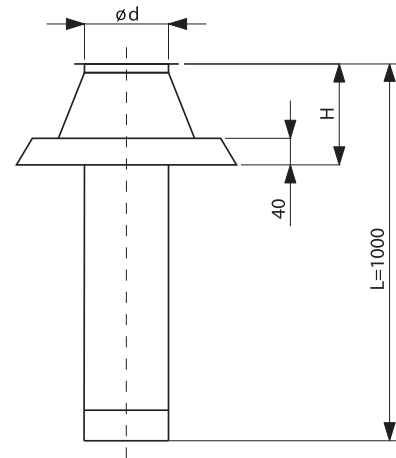
Dimensions

$\varnothing d_{nom}$ [mm]	A [mm]	H [mm]	Weight [kg]
100	280	180	3.38
125	300	180	3.81
140	360	180	4.56
150	380	180	4.67
160	400	180	4.92
200	440	180	5.83
250	470	200	7.14
300	510	200	8.43
315	530	200	8.86
355	610	200	11.03
400	630	200	12.04
450	720	200	15.37
500	740	200	16.64
560	800	240	19.80
630	900	240	22.54
710	1020	240	28.70
800	1100	280	32.63
1000	1270	280	40.72

PD-B2 roof base drip tray

PD-DRIP-T



Description

PD-DRIP-T drip trays drain condensed water away from a roof base. Water (or condensate) flows down the inner walls of the roof base duct to the bottom of the drip tray, from which it slowly evaporates. All surfaces in contact with the pooling water are thoroughly protected against corrosion.



The centre of the drip tray has a wire mesh to stop large debris. The wire mesh allows free air circulation. The top-end diameter has a female connection size for mounting the roof base duct. This product is recommended for PD-B2 roof bases. PD-

DRIP-T-200 drip trays are suitable for PD-B2-200 roof bases.

Available materials — Product code examples

PD-DRIP-T... - galvanized steel sheet

Product code example

Product code: **PD-DRIP-T - aaa**

type _____
 Ød _____

Dimensions

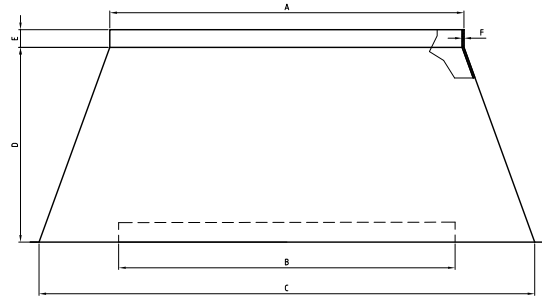

Product code	A [mm]	B [mm]	C [mm]	D [mm]	E [mm]	F [mm]
PD-DRIP-T-125	125	110	200	120	10	0.7
PD-DRIP-T-160	160	150	240	120	10	0.7
PD-DRIP-T-180	180	170	260	120	10	0.7
PD-DRIP-T-200	200	190	280	120	10	0.7
PD-DRIP-T-224	224	210	300	120	10	0.7

Roof base with damper

PD-B3



Description

The type B3 roof bases are made from galvanized sheet in the standard version and designed for installation on flat roofs. The top and bottom parts are provided with FLS steel flanges by default. The roof base can be ordered with an EPDM gasket at one or both ends. Other versions available on request include roof bases designed for sloping roofs and made from stainless steel sheet or aluminium sheet. The standard version of this roof base comes with a DAS shutoff damper; a DAT damper (air tightness class 4) can be used on request. The roof base can be installed as a standalone ventilation unit, e.g. in production buildings. The bottom part of the roof base can work as a roof air intake or a roof exhaust vent; if a roof fan or an air intake / exhaust is mounted to the FLS steel flange of the roof base, the assembly can work as a typical roof vent. An Alnor, Belimo or Siemens actuator can be added to the roof base's damper for remote control of the unit.

Available materials — Product code examples
 PD-B3-...-...- galvanized steel sheet

Product code example

Product code: **PD-B3 - aaa - bbb**

type _____
 $\varnothing d$ _____
 installation* _____

* GALA - EPDM gasket

* NS - male connection w/o gaskets

Dimensions

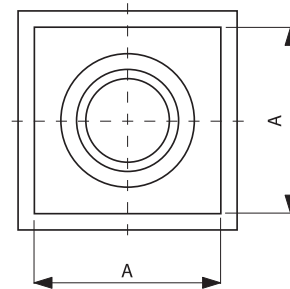
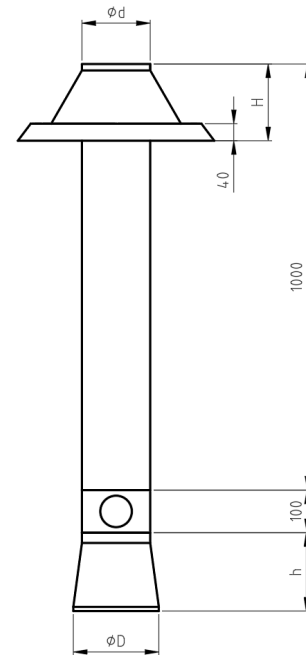

$\varnothing d$ [mm]	$\varnothing D$ [mm]	A [mm]	H [mm]	h [mm]	Weight [kg]
100	125	280	180	145	2.8
125	160	300	180	145	3.3
140	160	360	180	145	3.8
150	200	380	180	195	4.3
160	200	400	180	195	4.5
200	250	440	180	195	5.5
250	315	470	200	245	7.1
300	355	510	200	245	8.3
315	355	530	200	245	8.7
355	400	610	200	245	10.1
400	450	630	200	245	11.1
450	500	720	200	245	12.9
500	560	740	200	295	14.4
560	630	800	240	295	19.6
630	710	900	240	345	23.1
710	800	1020	240	395	29.7
800	1000	1100	280	495	36.6

Sloping roof base

TAGF



Dimensions

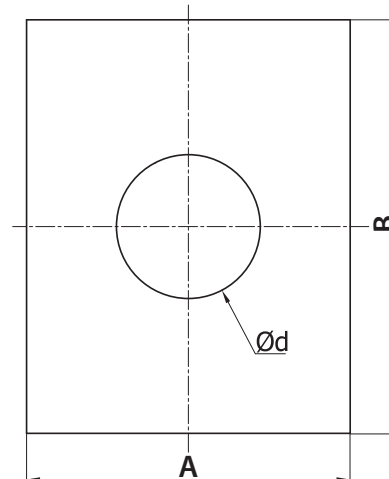
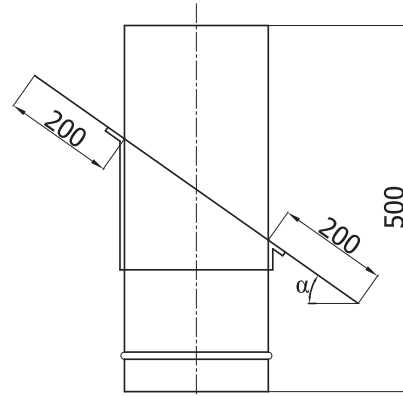

Description

TAGF roof bases are designed for installation of roof air intakes or exhaust vents without using steel flanges. Both ends of the roof base are male connections and match fittings and roof air intakes / exhausts provided with female connections. When ordering, specify the roof base inclination angle suitable for your roof slope. A roof base is a two-piece product composed of a shifting inner duct for adjusting the height over the roof. Once installed, the joints should be sealed, e.g. with TALT tape. The product is also available, on special request, with female connections or made from aluminium or stainless steel sheet

Available materials — Product code examples

- TAGF-...-... - galvanized steel sheet
- TAGF-K-...-... - 1.4301/304 stainless steel sheet
- TAGF-K-...-...-316L - 1.4404/316L stainless steel sheet
- TAGF-A-...-... - AW-1050A H24 aluminium sheet
- TAGF-CU-...-... - M1E z4 copper sheet

Product code example

Product code: TAGF - aaa - bbb

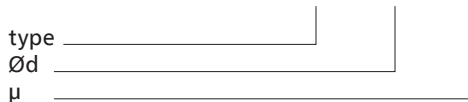

Product code	Ød _{nom} [mm]	A [mm]	B [mm]
TAGF-100	100	500	500
TAGF-125	125	525	525
TAGF-150	150	550	550
TAGF-160	160	560	560
TAGF-180	180	580	580
TAGF-200	200	600	600
TAGF-224	224	624	624
TAGF-250	250	625	625
TAGF-315	315	715	715
TAGF-355	355	755	755
TAGF-400	400	800	800
TAGF-450	450	850	850
TAGF-500	500	900	900
TAGF-560	630	960	960
TAGF-630	710	1030	1030

Weather collar

BAVE**Description**

BAVE weather collars are designed for installation on round ventilation ducts. They can be fastened with screws to female or male connection-sized ducts.

BAVE weather collars help seal roof penetrations to eliminate water streaks and stains indoors. The finish seal is fabricated on site with caulk.

All BAVE weather collars come with four M8x50 screws and nuts.

Available materials — Product code examples

BAVE-...-... - galvanized steel sheet
 BAVE-K-...-... - 1.4301/304 stainless steel sheet
 BAVE-K-...-...-316L - 1.4404/316L stainless steel sheet

Product code example

Product code: **BAVE - aaa**

type _____
 Ød _____

Dimensions

$\text{Ø}d_{\text{nom}}$ [mm]	A [mm]	B [mm]
100	70	100
125	70	100
160	70	110
200	70	110
250	70	110
315	70	130
355	70	130
400	70	130
450	70	130
500	70	150
630	70	150
710	70	150

Roof curb for round roof bases

COKD



Dimensions

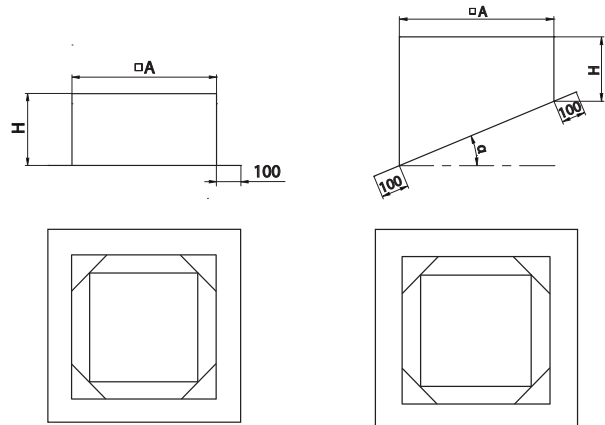

Description

COKD roof curbs are installed on the roof surface as supports for PD-B1, PD-B2 and PD-B3 roof bases. The product is available in galvanized steel, stainless steel and aluminium, plus versions with or without thermal insulation, and with a straight duct or a bend.

The standard insulating layer thickness is 25 mm or 50 mm. Sloping roof curbs are designed for sloping roofs. The standard overall height of the roof curb is 500 mm. Any overall height can be produced on request.

Insulation:

COKD - non-insulated
COKDI - insulated

Available materials — Product code examples

COKD-...-... - galvanized steel sheet
COKD-K-...-... - 1.4301/304 stainless steel sheet
COKD-K-...-...-316L - 1.4404/316L stainless steel sheet

Product code example

Product code: **COKDI - 50 - Ød - α**

type	_____
insulation	_____
size	_____
angle	_____

Size	A [mm]	H [mm]
100	270	500
125	290	500
140	350	500
150	370	500
160	390	500
200	430	500
250	460	500
300	500	500
315	520	500
355	600	500
400	620	500
450	710	500
500	730	500
560	790	500
630	890	500
710	1010	500
800	1090	500
1000	1260	500

Round roof exhaust vent

WD-C1



Description

A roof exhaust vent serves as a roof ventilator installed over the roof surface. The unit is usually mounted to a roof base, and both parts of the assembly are mated with FLS steel flanges which make the joint and the whole assembly very sturdy and stiff to resist strong gusts of wind. Other available versions of roof exhaust vents include male and female connection sizes for direct connection with spiral ducts and fittings or matching roof bases. The roof exhaust vent can be made from aluminium sheet or stainless steel sheet, whenever special performance or material is required.

Connection method — Product code examples

- WD-C1-...- - with FLS steel flange (standard version)
- WD-C1-...-NSL - male connector with gasket
- WD-C1-...-NYPLOWE - male connector w/o gasket
- WD-C1-...-MF - female connection for fittings
- WD-C1-...-NA RURE - double-sided male connector, slid over the duct

Available materials — Product code examples

- WD-C1-...-... - galvanized steel sheet
- WD-C1-K-...-... - 1.4301/304 stainless steel sheet
- WD-C1-A-...-... - aluminium sheet
- WD-C1-CU-...-... - copper sheet

Product code example

Product code: **WD-C1 - aaa - bbb**

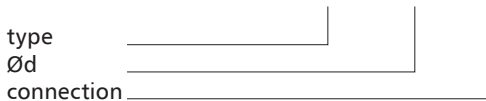

Dimensions

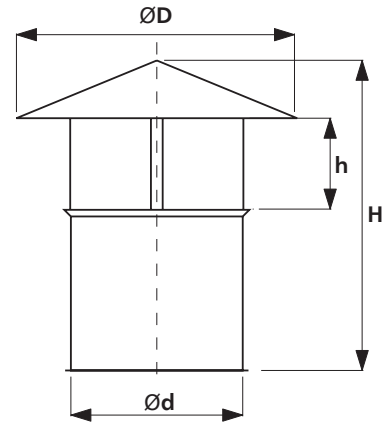

$\varnothing d_{nom}$ [mm]	$\varnothing D_{nom}$ [mm]	H [mm]	h [mm]	Weight [kg]
100	250	280	40	0.8
125	270	310	50	1.1
140	290	320	60	1.2
150	360	355	75	1.4
160	450	365	75	1.5
200	570	425	80	2.0
250	640	450	95	2.6
315	720	495	120	4.2
355	810	550	150	4.9
400	900	610	190	6.4
450	1000	650	220	8.5
500	1100	670	240	11.0
630	1200	760	270	16.9
710	1300	940	300	23.4
800	1400	1070	380	27.1
900	1500	1200	440	32.6

Round roof air intake unit

WD-C2



Description

WD-C2 roof exhaust vents are designed to minimize the ingress of rain into the ventilation ductwork. The available installation methods do not differ from those used for WD-C1 units, and the sloped design allows a larger cap for better protection against rain.

Connection method — Product code examples

- WD-C2-...- - with FLS steel flange (standard version)
- WD-C2-...-NSL - male connector with gasket
- WD-C2-...-NYPLOWE - male connector w/o gasket
- WD-C2-...-MF - female connection for fittings
- WD-C2-...-NA RURE - double-sided male connector, slid over the duct

Available materials — Product code examples

- WD-C2-...-... - galvanized steel sheet
- WD-C2-K-...-... - 1.4301/304 stainless steel sheet
- WD-C2-A-...-... - aluminium sheet
- WD-C2-CU-...-... - copper sheet

Product code example

Product code: **WD-C2 - aaa - bbb**

type _____
 Ød _____
 connection _____

Wymiary

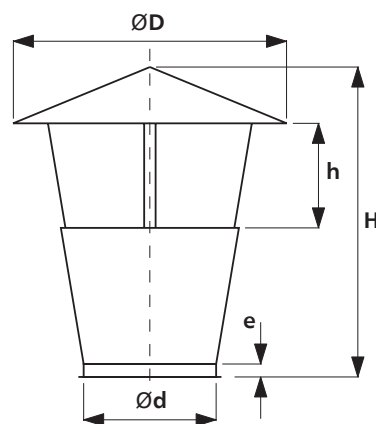

$\varnothing d_{nom}$ [mm]	$\varnothing D_{nom}$ [mm]	H [mm]	h [mm]	Weight [kg]
100	200	170	40	0.7
125	250	210	40	1.0
140	280	235	50	1.2
150	320	250	50	1.4
160	320	260	50	1.5
200	400	340	60	2.0
250	500	400	75	3.2
315	630	520	95	5.0
355	700	575	100	5.8
400	800	640	105	8.3
450	900	740	110	10.8
500	1000	810	110	15.8
630	1260	1010	120	25.7
710	1400	1050	140	29.0
800	1600	1260	160	41.4
900	1800	1430	200	49.5

Cylindrical roof ventilator

WD-B



Description

The type B cylindrical roof exhaust vents are made from galvanized steel sheet in the standard version. The bottom part features an FLS steel flange for connection with the roof base.

Other connection types and materials are available.

Connection method — Product code examples

- WD-B-...- - with FLS steel flange (standard version)
- WD-B-...-NSL - male connector with gasket
- WD-B-...-NYPLOWE - male connector w/o gasket
- WD-B-...-MF - female connection for fittings
- WD-B-...-NA RURE - double-sided male connector, slid over the duct

Available materials — Product code examples

- WD-B-...-... - galvanized steel sheet
- WD-B-K-...-... - 1.4301/304 stainless steel sheet
- WD-B-A-...-... - aluminium sheet
- WD-B-CU-...-... - copper sheet

Product code example

Product code: **WD-B - aaa - bbb**

type _____
 Ød _____
 connection _____

Dimensions

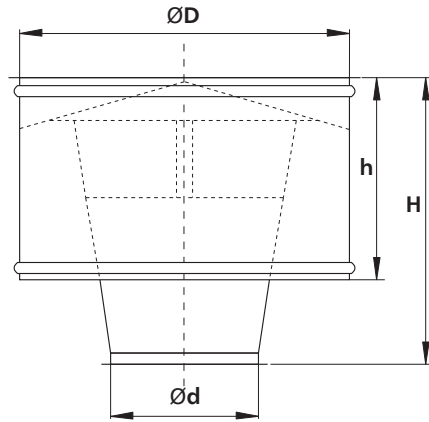

$\varnothing d_{nom}$ [mm]	$\varnothing D_{nom}$ [mm]	H [mm]	h [mm]	Weight [kg]
100	200	160	120	1,0
125	250	205	150	1,4
150	320	250	190	1,9
160	320	265	190	2,0
200	400	330	240	3,1
250	500	415	300	5,0
300	580	500	330	7,0
315	630	520	350	8,2
355	710	590	400	10,5
400	800	660	450	13,9
450	900	730	500	15,7
500	1000	825	550	19,9
630	1260	1040	700	38,4
800	1600	1270	900	63,6
1000	1780	1460	950	83,5

Vertical roof exhaust vent

WD-D



Description

The type D roof exhaust vents are available in galvanized steel in the standard version. The bottom part features an FLS steel flange for connection with the roof base.

Other connection types and sheet materials are available.

The base has a deflector for protection against snow and drainage of water to the outside of the vent. The roof exhaust vent requires bracing with side stays.

Since WD-D units have no standard drip features, they must only be used in continuous air flow ventilation systems.

Connection method — Product code examples

- WD-D-...- - with FLS steel flange (standard version)
- WD-D-...-NSL - male connector with gasket
- WD-D-...-NYPLOWE - male connector w/o gasket
- WD-D-...-MF - female connection for fittings
- WD-D-...-NA RURE - double-sided male connector, slid over the duct

Available materials — Product code examples

- WD-D-...-... - galvanized steel sheet
- WD-D-K-...-... - 1.4301/304 stainless steel sheet

Product code example

Product code: **WD-D - aaa - bbb**

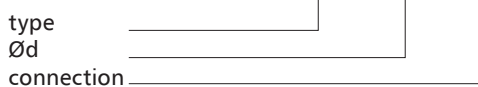

Dimensions

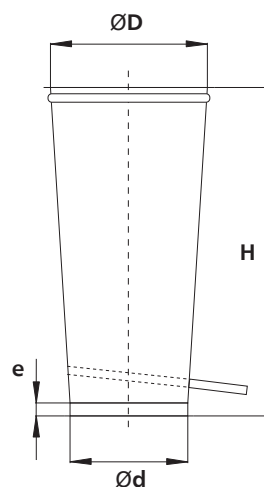

$\varnothing d_{nom}$ [mm]	$\varnothing D_{nom}$ [mm]	H [mm]	Weight [kg]
100	140	320	1.3
125	165	375	1.5
140	180	410	1.6
150	195	430	1.9
160	210	480	2.2
200	260	600	3.1
250	325	750	4.2
315	410	940	7.8
355	460	1080	8.9
400	520	1200	12.5
450	580	1300	15.3
500	650	1500	23.4
630	750	1890	34.8
710	820	2100	46.4
800	910	2300	56.3
900	1020	2500	68.6
1000	1150	2700	83.1

Roof exhaust vent

WD-E



Description

WD-E roof exhaust vents are used for rooftop termination of the ductwork to evacuate air to the outside. The outlet is protected against rain and snow by a sloping flange which deflects the water onto the side walls to drain it to the roofing. The standard roof exhaust vent is made from galvanized steel sheet and provided with an FLS steel flange.

The product is available on request with a male or female connection, and/or made from stainless steel or aluminium sheet

Available materials — Product code examples

WD-E-...-... - galvanized steel sheet

WD-E-K-...-... - 1.4301/304 stainless steel sheet

Product code example

Product code: **WD-E - aaa - bbb**

type _____
 Ød _____
 installation* _____

* NS - male connector

Dimensions

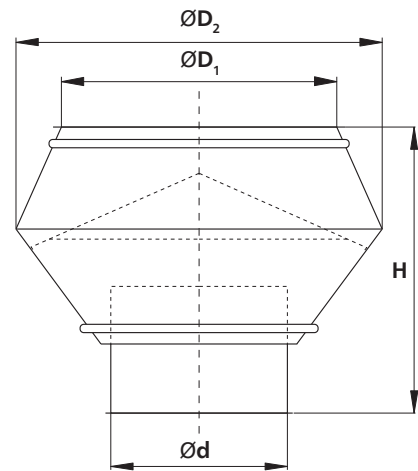

$\varnothing d_{nom}$ [mm]	$\varnothing D_1$ [mm]	$\varnothing D_2$ [mm]	H [mm]	Weight [kg]
125	185	225	450	2.3
150	220	270	490	2.7
160	230	290	510	2.8
200	280	360	575	3.6
250	350	450	630	5.2
300	400	520	680	6.6
315	440	570	710	7.5
355	500	640	750	9.9
400	560	720	800	13.0
450	630	810	860	15.7
500	700	900	915	19.3
560	790	1000	970	25.5
630	880	1135	1200	34.7
710	995	1280	1320	40.5
800	1120	1400	1500	56.5
1000	1400	1600	1600	74.0

Vertical roof exhaust vent

WD-G



Description

The type G roof exhaust vent provides the ventilation system with a vertical air exhaust flow. Given the overall product height, a standard connection method is recommended, by mating the FLS steel flanges and bracing with side cable stays. The inner standing edge of the roof exhaust vent provides an efficient output for the exhaust air. The standing edge also provides a drainage surface for rain and snow water which flows off onto the roof exhaust vent walls and then down to the roofing surface. This eliminates any hazard of water ingress into the ventilation ductwork.

The available versions can be made from stainless steel sheet or aluminium sheet and with various connection styles. The roof exhaust vent requires bracing with side stays.

Connection method — Product code examples

- WD-G-...- - with FLS steel flange (standard version)
- WD-G-...-NSL - male connector with gasket
- WD-G-...-NYPLOWE - male connector w/o gasket
- WD-G-...-MF - female connection for fittings
- WD-G-...-NA RURE - double-sided male connector, slid over the duct

Available materials — Product code examples

- WD-G-...-...- galvanized steel sheet

Product code example

Product code: **WD-G - aaa - bbb**

type _____
 Ød _____
 connection _____

Dimensions

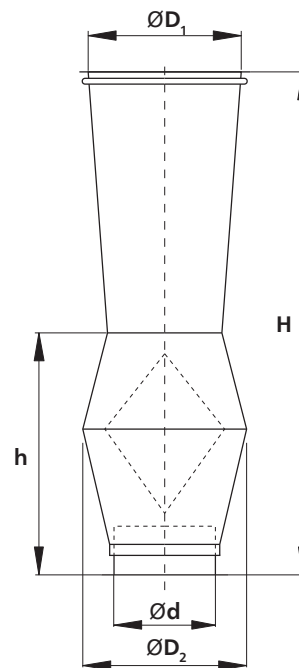

$\varnothing d_{nom}$ [mm]	$\varnothing D_1$ [mm]	$\varnothing D_2$ [mm]	H [mm]	h [mm]	Weight [kg]
100	170	180	660	300	2.7
125	200	220	780	380	3.8
140	250	270	900	460	5.1
160	320	360	1230	530	6.3
200	340	400	1370	720	7.3
250	410	450	1670	780	12.6
315	450	500	1820	880	16.6
355	490	540	1950	960	17.5
400	520	640	2170	1020	25.2
500	650	800	2655	1095	44.8

Roof exhaust vent

VHLA



Description

VHLA roof air intakes/exhaust vents are made from galvanized steel. The carefully designed form and finish provide a great visual impact and a splendid match for the building's architectural style.

The VHLA roof air intakes/exhaust vents fit ducts with $\varnothing d$. The standard diameter $\varnothing d$ is a male connection size, and the standard diameter $\varnothing D$ is a double-sided female connection size for installation of VHLA units on SPRI pre-insulated ducts with 50 mm of mineral wool.

The product can also be painted in any RAL colour. Product code for colour-painted units: VHLA-RAL-aaa-bbb.

Product code example

Product code: VHLA - aaa - bbb

type _____
 $\varnothing d$ _____
 $\varnothing D$ _____

Dimensions

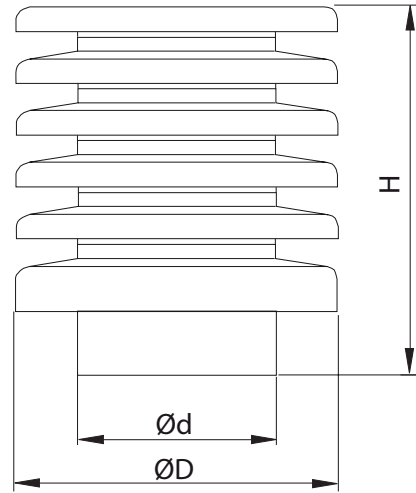

$\varnothing d_{nom}$ [mm]	$\varnothing D$ [mm]	H [mm]	No. of hood caps (pcs)
100	200	183	3
125	224	183	3
160	250	223	4
200	300	263	5
250	355	303	6

Technical specifications

Selection chart
Outdoor air

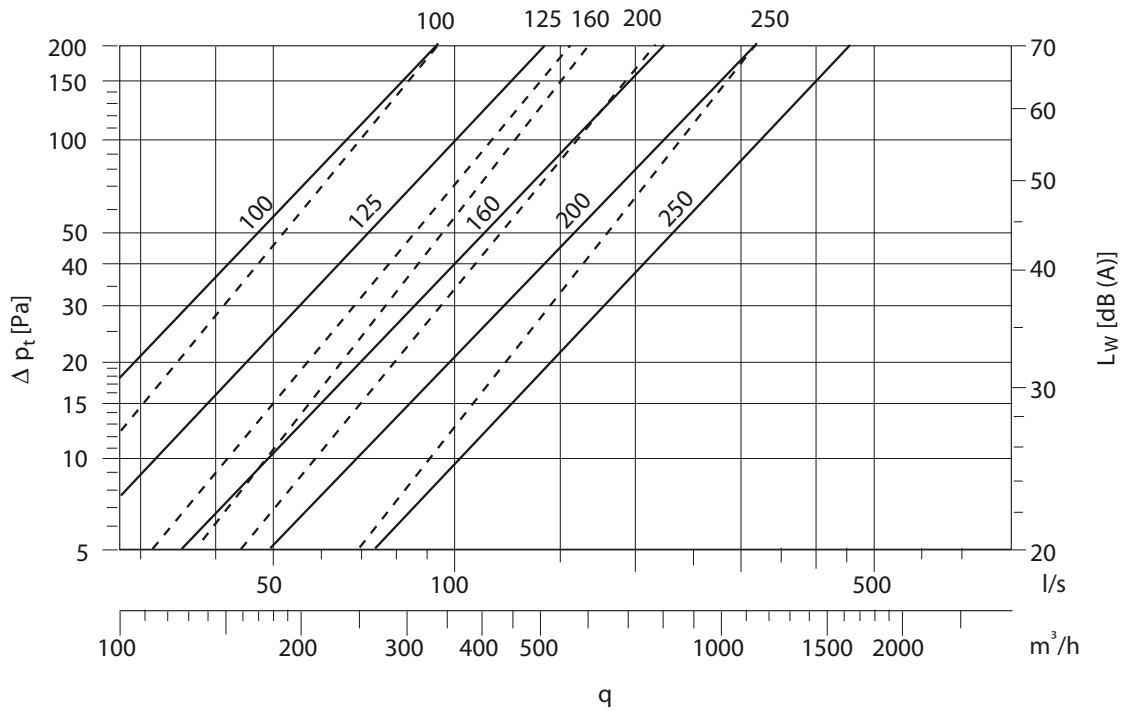

Exhausted air

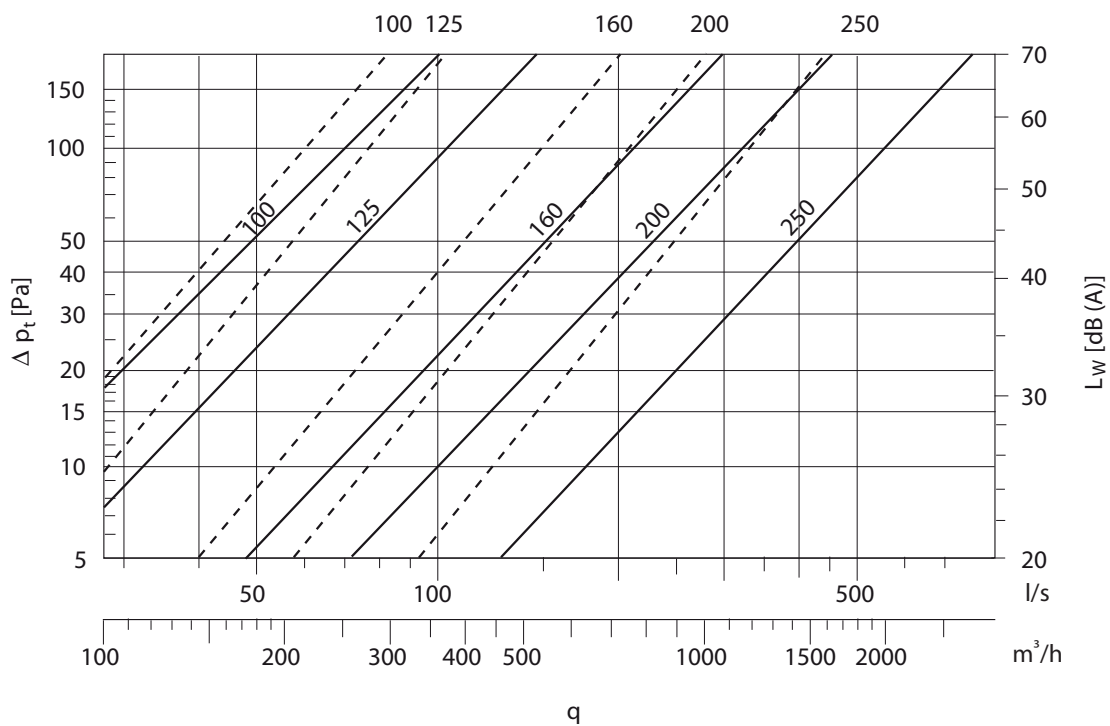

Roof cowl

VHLA-S



Description

VHLA-S Exhaust/supply roof cowl is made of segments, its modern and sleek design enhances the aesthetics of any project. Stainless steel and aluminium versions are now available as well as wider range of diameters thanks to newly implemented technology processes. VHLA-S exhaust/supply roof cowls can be powder coated in any RAL colour on special order.

Available materials — Product code examples:

VHLA-S-...-... - galvanised steel sheet
 VHLA-S-...-...-RAL.... - powder-coated galvanised sheet
 VHLA-S-KWS-...-... - 1.4301/304 stainless steel sheet
 VHLA-S-A-...-... - aluminium sheet

Connection method — Product code examples

VHLA-S-...-MSF - female connector for fittings
 VHLA-S-...-NS - male connector
 VHLA-S-...-NSL - male connector with a gasket
 VHLA-S-...-MSFF - extended female connector - slid over the duct

Product code example

Product code: **VHLA-S - 250 - MSF - RAL9006**

type _____
 Ød _____
 connection _____
 RAL colour _____

Dimensions

VHLA-S < Ø250

VHLA-S > Ø315

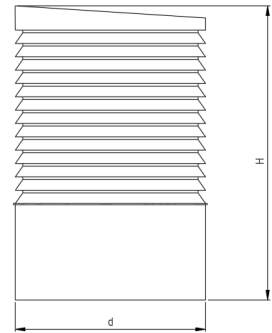
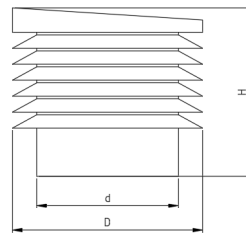

Product code	$\varnothing d_{nom}$ [mm]	$\varnothing D$ [mm]	H [mm]	No. of hood caps (pcs)
VHLA-S-080	80	180	250	3
VHLA-S-100	100	200	250	3
VHLA-S-125	125	224	250	3
VHLA-S-160	160	250	330	5
VHLA-S-200	200	300	330	5
VHLA-S-224	224	315	330	5
VHLA-S-250	250	355	350	5

Product code	$\varnothing d_{nom}$ [mm]	$\varnothing D$ [mm]	H [mm]	No. of hood caps (pcs)
VHLA-S-315	315	-	450	7
VHLA-S-355	355	-	500	8
VHLA-S-400	400	-	560	9
VHLA-S-450	450	-	630	10
VHLA-S-500	500	-	690	11
VHLA-S-560	560	-	750	12
VHLA-S-630	630	-	820	13
VHLA-S-710	710	-	900	14

Exhaust air tower

VHLA-ST



Description

VHLA-ST Supply air/ exhaust air tower is manufactured of segments, designed for ventilation duct installation. Thanks to a higher housing base in comparison to e.g. VHLA-S model, the ventilation tower does not supply air near ground. VHLA-ST design and a multitude of material versions - galvanised sheet, powder-coated, stainless steel or aluminum - make this model architecturally fit into the landscape of a modern housing estate or office complex or home installation of a ground heat exchanger.

Available materials:

- VHLA-ST-...-... - galvanised steel sheet
- VHLA-ST-...-...-RAL.... - powder-coated galvanised sheet
- VHLA-ST-KWS-...-... - 1.430/304 stainless steel sheet
- VHLA-ST-A-...-... - aluminium sheet

Connection method — Product code examples

- VHLA-ST-...-MSF - female connector for fittings
- VHLA-ST-...-NS - male connector
- VHLA-ST-...-NSL - male connector with a gasket
- VHLA-ST-...-MSFF - extended female connector - slid over the duct

Product code example

Product code: **VHLA-ST - 710 - MSF - RAL9006**

type	_____	_____	_____
Ød	_____	_____	_____
connection	_____	_____	_____
RAL colour	_____		

Dimensions

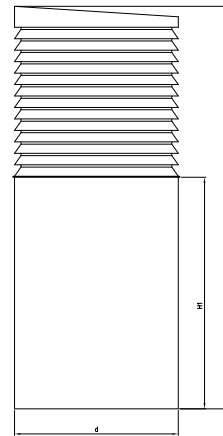

Product code	Ød _{nom} [mm]	H [mm]	H ₁ [mm]	No. of hood caps (pcs)
VHLA-ST-315	315	950	650	7
VHLA-ST-355	355	980	650	8
VHLA-ST-400	400	1010	650	9
VHLA-ST-450	450	1050	650	10
VHLA-ST-500	500	1090	650	11
VHLA-ST-560	560	1120	650	12
VHLA-ST-630	630	1150	650	13
VHLA-ST-710	710	1200	650	14

Circular roof cowl

WD-CS**Description**

WD-CS circular roof cowls are made from galvanized steel sheet in the standard version. The bottom part is a male connector for mounting to the roof base.

The product is available on request with a female connection and/or made from stainless steel or aluminium sheet.

Product code example

Product code: **WD-CS - aaa**

type _____
 Ød _____

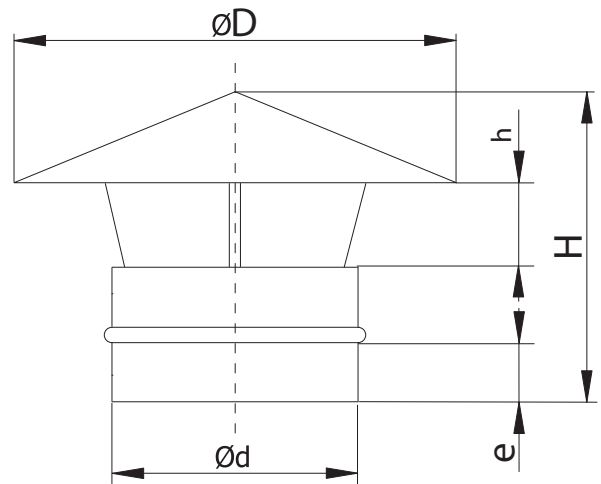
Dimensions

$\varnothing d_{nom}$ [mm]	$\varnothing D_{nom}$ [mm]	h [mm]	H [mm]
100	190	40	170
125	225	40	210
140	250	50	235
150	270	50	250
160	290	50	260
200	360	60	340
250	450	75	400
315	570	95	520
355	640	125	574
400	720	130	640
450	810	150	740
500	900	160	810
630	1140	190	1010
710	1300	230	1050
800	1400	240	1260
900	1480	300	1430

Roof turbine ventilator WD-TURBO



Description

WD-TURBO roof turbine ventilators cap the exhaust end of ventilation ductwork or a flue stack.

They spin by the force of wind. By this effect and the specially designed geometry of the turbine bell vanes, the ventilator sucks out the air (or flue gas, as the case may be) to the outside.

The roof turbine ventilators enhance the stack draught effect and provide protection against ingress of rain, snow and condensation.

Symbols:

Material:

A - aluminium

K - stainless steel

Connection type:

K - round bell with baseplate

KK - round bell with flange

KNS - round bell with male connector

P - flat with baseplate

Product code example

Product code: **WD - A - TURBO - K - aaa**

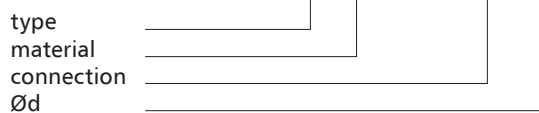

Dimensions

WD-...-TURBO-KNS

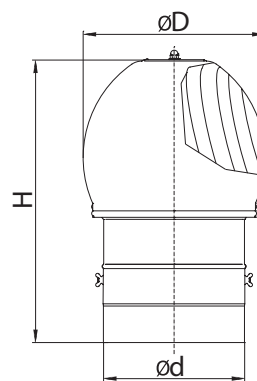

WD-...-TURBO-K

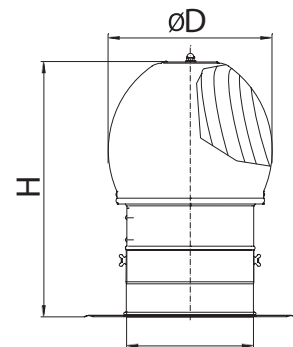

WD-...-TURBO-KK

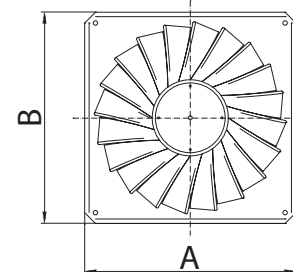
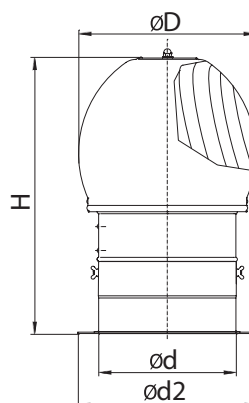

	Ød _{nom} [mm]	Ød ₂ [mm]	ØD _{nom} [mm]	H [mm]	A [mm]	B [mm]
male	150	-	225	337	-	-
	160	-	240	409	-	-
	200	-	300	409	-	-
	250	-	360	475	-	-
flanged	300	-	430	532	-	-
	150	210	225	217	-	-
	160	220	240	222	-	-
	200	260	300	283	-	-
	250	310	360	365	-	-
w/base	300	360	430	412	-	-
	150	-	225	217	333	333
	160	-	240	222	333	333
	200	-	300	283	333	333
	250	-	360	365	390	390
	300	-	430	412	440	440

Take-off bends with wire mesh

BSAVL-90/BSAV-90



Description

Take-off bends are air exhaust pieces for termination of ventilation ductwork made of spiral coiled ducts or other round duct types. They are made of BS or BSL segmented bends (depending on the length size) coupled by factory-made seal and hem with an ASV-45 angle take-off provided with wire mesh. The flared top of the take-off helps protect against ingress of rain and snow, and the 12.7x12.7 mm mesh protects against birds and large insects. The product is designed for exhaust ventilation systems in which the bend has a male connection size for joining with other compatible ductwork pieces. Versions provided with an FLS steel flange connection and made from stainless steel / aluminium are available on request.

Available materials — Product code examples

- BSAVL-90-... - galvanized steel sheet
- BSAVL-90-K-...-... - 1.4301/304 stainless steel sheet
- BSAVL-90-K-...-316L - 1.4404/316L stainless steel sheet, molybdenum-enriched

Product code example

Product code: **BSAVL - 90 - aaa**

type _____
 angle _____
 Ød₁ _____

Dimensions

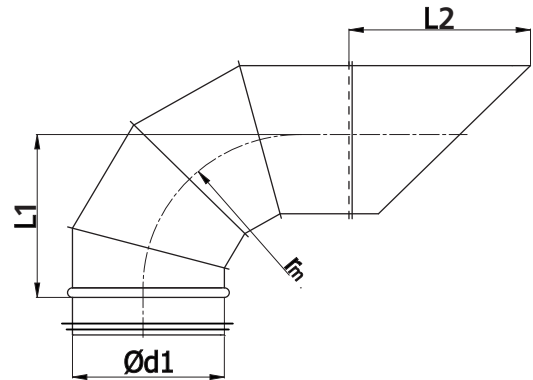

$$r_m \approx 1 \times d_1$$

Ød _{1 nom} [mm]	L ₁ [mm]	L ₂ [mm]	Weight [kg]
200	200	100	1.71
224	224	258	2.04
250	250	317	2.81
280	280	344	3.17
300	300	364	3.80
315	315	380	3.90
355	355	422	5.94
400	400	467	7.86
450	450	546	12.54
500	500	594	14.11
560	560	656	18.75
600	600	698	21.77
630	630	727	23.11
710	710	838	35.63
800	800	928	44.50
900	900	1027	55.16
1000	1000	1127	123.15

Technical specifications

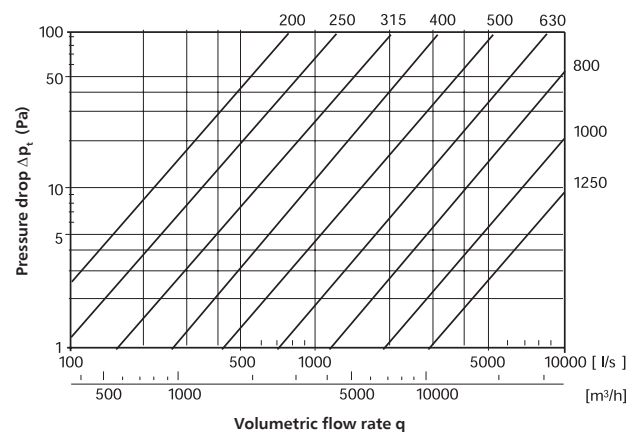

Outdoor vent take-off bend with wire mesh

BSILNL-135/BSILN-135



Description

Round segmented take-off bends serve as roof exhaust vents in mechanical, heat-recovery and gravity ventilation systems. The 135-degree angle of the mouth helps protect against ingress of rain, snow and water. The 12.7x12.7 mm mesh protects against leaves, debris and birds. The take-off bend can be used as an exhaust vent or an air intake unit. The male connector fits spiral ducts and type B1 round roof bases. The product is available on request with an FLS steel flange or a female connector size for combining with ventilation fittings.

Available materials — Product code examples
 BSILNL-135-... - galvanized steel sheet
 BSILNL-135-K-...-... - 1.4301/304 stainless steel sheet
 BSILNL-135-K-...-316L - 1.4404/316L stainless steel sheet, molybdenum-enriched

Product code example

Product code: **BSILNL - 135 - aaa**

type _____
 angle _____
 Ød₁ _____

Dane techniczne

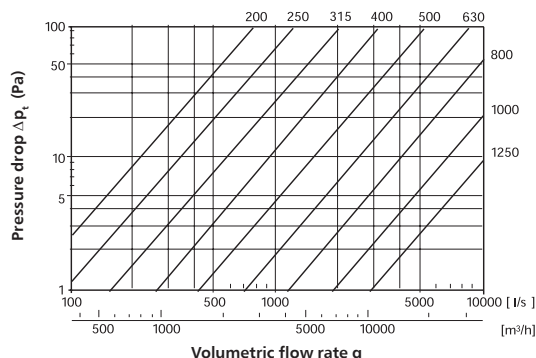

Dimensions

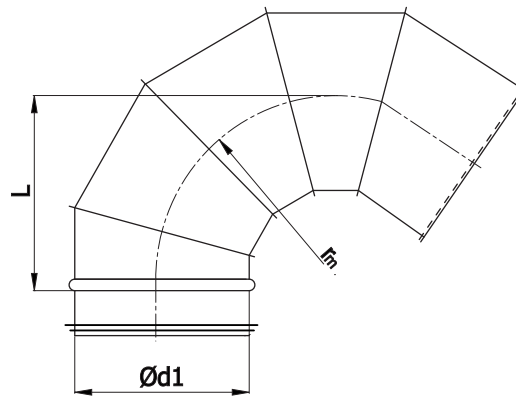

$$r_m \approx 1 \times d_1$$

Ød _{1 nom} [mm]	L [mm]	Weight [kg]
200	200	1.11
224	224	1.33
250	250	1.64
280	280	2.04
300	300	2.31
315	315	2.51
355	355	3.74
400	400	5.11
450	450	8.02
500	500	9.62
560	560	11.82
600	600	13.34
630	630	14.55
710	710	22.45
800	800	28.05
900	900	34.65
1000	1000	43.05
1120	1120	59.85
1250	1250	73.08
1400	1400	90.08
1500	1500	103.48
1600	1600	116.69

Roof cowl with mesh



CD-O-P / CD-S-P / CD-P-P



Description

CD-S-P / CD-O-P / CD-P-P Supply air roof cowl is designed to be placed on roof of residential buildings. The roof cowl has aesthetic design made of perforated metal sheet (square holes) and 3 types of top hats - pitched, round and flat. The mesh ensures proper airflow and simultaneously prevents birds, leaves and others from entering into the duct termination point. CD-S-P / CD-O-P / CD-P-P Supply air roof cowl has few types of connection fitted for different duct terminations.

Available versions:

-  CD-S-P - pitched hat
-  CD-O-P - round hat
-  CD-P-P - flat hat

Connection method — Product code examples

- CD-...-P-...-MSF - female connector for fittings
- CD-...-P-...-NS - male connector
- CD-...-P-...-NSL - male connector with a gasket (cannot be powder coated)
- CD-...-P-...-MSFF - extended female connector - slid over the duct

Available materials — Product code examples

- CD-...-P-...-... - galvanised steel sheet
- CD-...-P-...-...-RAL - galvanised sheet powder-coated in any colour from the RAL palette (except NSL version with a seal)

Product code example

Product code: **CD-S-P - 160 - NSL - RAL**

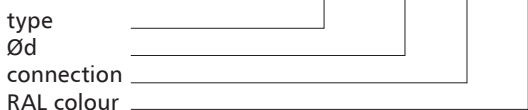

Wymiary

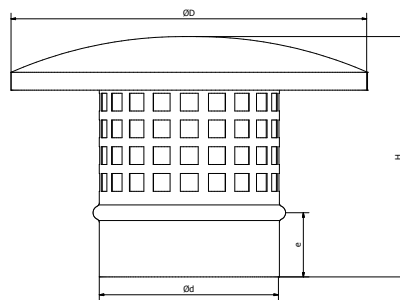

CD-O-P			
Ød [mm]	ØD [mm]	H [mm]	e [mm]
100	200	165	36
125	224	170	36
160	250	200	36

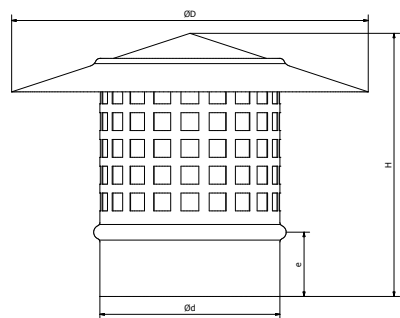

CD-S-P			
Ød [mm]	ØD [mm]	H [mm]	e [mm]
100	200	165	36
125	224	170	36
160	250	200	36

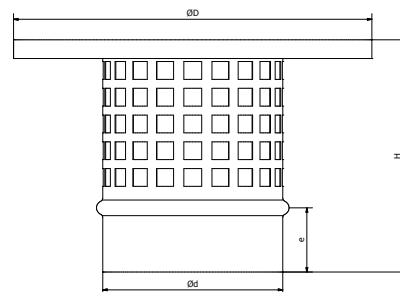

CD-P-P			
Ød [mm]	ØD [mm]	H [mm]	e [mm]
100	200	145	36
125	250	150	36
160	250	180	36

Straight roof air intake

CD-C1



Description

A standard roof air intake to be installed on type B1, B2 and B3 round roof bases. The 12.7x12.7 mm mesh protects against leaves, debris and birds. The cap at the top protects against rain, snow and water. The standard connection for this product is an FLS steel flange which can be replaced with a male connector for spiral ducts or a female connector suitable for fittings and roof bases (with a male connection size). Such replacement is recommended only for small diameter sizes. The versions available in stainless steel or aluminium enable using the air intake in non-standard ventilation systems.

The roof air intake is provided with 12.7x12.7 mm galvanized steel wire mesh made of 1 mm wires for protection against debris.

Connection method — Product code examples

- CD-C1-...- - with FLS steel flange (standard version)
- CD-C1-...-NSL - male connector with gasket
- CD-C1-...-NYPLOWE - male connector w/o gasket
- CD-C1-...-MF - female connection for fittings
- CD-C1-...-NA RURE - double-sided male connector, slid over the duct

Available materials — Product code examples

- CD-C1-...-... - galvanized steel sheet
- CD-C1-K-...-... - 1.4301/304 stainless steel sheet
- CD-C1-K-...-316L - 1.4404/316L stainless steel sheet, molybdenum-enriched

Product code example

Product code: **CD-C1 - aaa - bbb**

type

Ød

connection



Dimensions

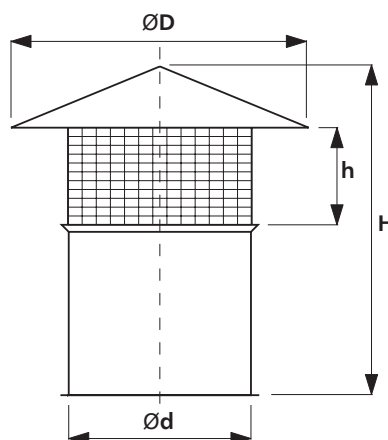

Ød [mm]	ØD [mm]	H [mm]	h [mm]	Weight [kg]
100	250	280	40	0,9
125	270	310	50	1,2
140	290	320	60	1,3
150	360	355	75	1,5
160	450	365	75	1,6
200	570	425	80	2,2
250	640	450	95	2,7
315	720	495	120	4,4
355	810	550	150	5,2
400	900	610	190	6,7
450	1000	650	220	9,0
500	1100	670	240	11,3
630	1200	760	270	17,4
710	1300	940	300	24,2
800	1400	1070	380	28,0
900	1500	1200	440	33,5

Flared roof air intake unit

CD-C2**Description**

The type C2 flared roof air intake units are made from galvanized steel sheet in the standard version. The bottom part features an FLS steel flange for connection with the roof base. The roof air intake is available on request with other connection styles and/or made from stainless steel or aluminium sheet. The roof air intake is provided with 12.7x12.7 mm galvanized steel wire mesh made of 1 mm wires for protection against debris.

Connection method — Product code examples

- CD-C2-...- - with FLS steel flange (standard version)
- CD-C2-...-NSL - male connector with gasket
- CD-C2-...-NYPLOWE - male connector w/o gasket
- CD-C2-...-MF - female connection for fittings
- CD-C2-...-NA RUREĖ - double-sided male connector, slid over the duct

Available materials — Product code examples

- CD-C2-...-... - galvanized steel sheet
- CD-C2-K-...-... - 1.4301/304 stainless steel sheet
- CD-C2-K-...-316L - 1.4404/316L stainless steel sheet, molybdenum-enriched

Product code example

Product code: **CD-C2 - aaa - bbb**

type _____

Ød _____

connection _____

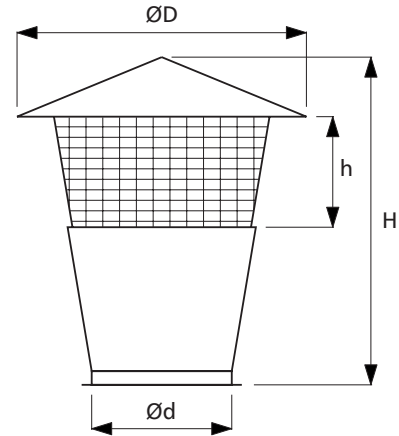
Dimensions

Ød [mm]	ØD [mm]	H [mm]	h [mm]	Weight [kg]
100	200	170	40	0,8
125	250	210	40	1,1
140	280	235	50	1,3
150	320	250	50	1,5
160	320	260	50	1,6
200	400	340	60	2,3
250	500	400	75	3,4
315	630	520	95	5,3
355	700	575	100	6,2
400	800	640	105	8,8
450	900	740	110	11,5
500	1000	810	110	16,5
630	1260	1010	120	26,5
710	1400	1050	140	30,0
800	1600	1260	160	42,6
900	1800	1430	200	50,9

Ventilation chimney cowl for round ducts

RHA



Description

The ventilation chimney cowl is the easiest, simplest and most budget-friendly all-rounder of all possible vertical air exhaust ends in installation systems built with round ducts and fittings. The product is available in 3 different sizes, each for a specific diameter range. The product is installed by bending down the 3 or 4 legs to fit the connected spiral duct, inserting the legs down to the stop, and fastening them with WGO screws or blind rivets. Optional versions are available on request, made from stainless steel sheet or aluminium sheet.

Available materials — Product code examples

- RHA-... - galvanized steel sheet
- RHA-K-... - 1.4301/304 stainless steel sheet
- RHA-K-...-316L - 1.4404/316L stainless steel sheet, molybdenum-enriched

Product code example

Product code: **RHA - aaa**

type*

Ød

- * RHA-1 — suitable for ducts in diameters ≈ 80-125
- * RHA-2 — suitable for ducts in diameters ≈ 140-200
- * RHA-3 — suitable for ducts in diameters ≈ 224-315

Description

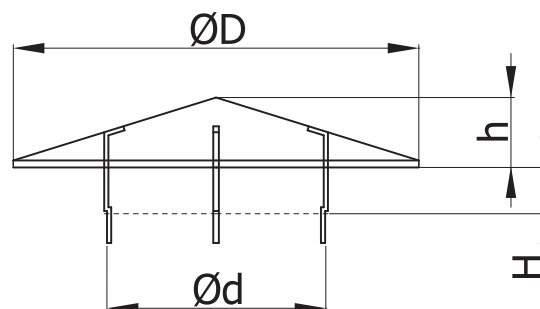

Ød [mm]	H [mm]	h [mm]	ØD [mm]	Legs (pcs)	Weight (kg)
80 – 125	50	30	180	3	0.2
140 – 200	75	45	290	3	0.5
224 – 315	100	75	505	4	1.3

Ventilation chimney cowl

VHK**Description**

VHK ventilation chimney cowls offer a great solution for roof air intakes or exhausts in industrial or housing ventilation systems.

They are made from galvanized steel sheet in the standard version; non-standard versions in stainless steel sheet, aluminium sheet or plastic-coated steel sheet (in various colours) are available on request. The intake mouth is protected by a steel mesh. The standard version has a connector port; a flanged version is available on request.

Available materials — Product code examples

- VHK-... - galvanized steel sheet
 VHK-K... - 1.4301/304 stainless steel sheet
 VHK-K...-316L - 1.4404/316L stainless steel sheet, molybdenum-enriched
 VHK-A... - aluminium sheet
 VHK-A... - copper sheet

Product code example

Product code: **VHK - aaa**

type _____
 Ød₁ _____

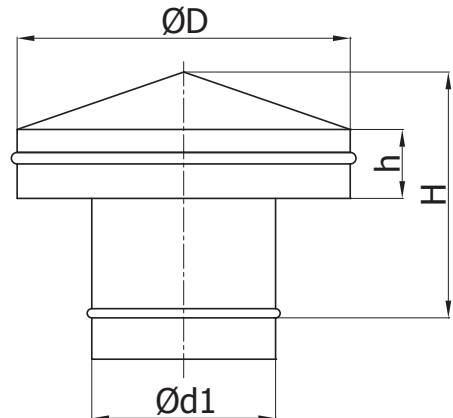
Dimensions

Ød ₁ [mm]	ØD [mm]	h [mm]	H [kg]	Weight [kg]
80	180	60	133	0,7
100	180	60	133	0,7
125	224	60	139	0,9
140	290	60	148	1,0
150	290	60	148	1,1
160	290	60	148	1,1
180	360	100	197	1,7
200	360	100	197	1,9
224	405	100	208	2,4
250	450	100	228	2,6
280	570	100	244	3,6
300	570	100	244	3,8
315	570	100	244	4,1
355	720	150	337	6,0
400	720	150	337	6,2
450	810	150	349	7,2
500	900	200	411	11,2
560	1080	200	435	12,0
600	1080	200	435	12,2
630	1135	200	442	12,8
710	1280	200	482	14,5
800	1440	200	503	18,0

Technical specifications

Exhaust vent

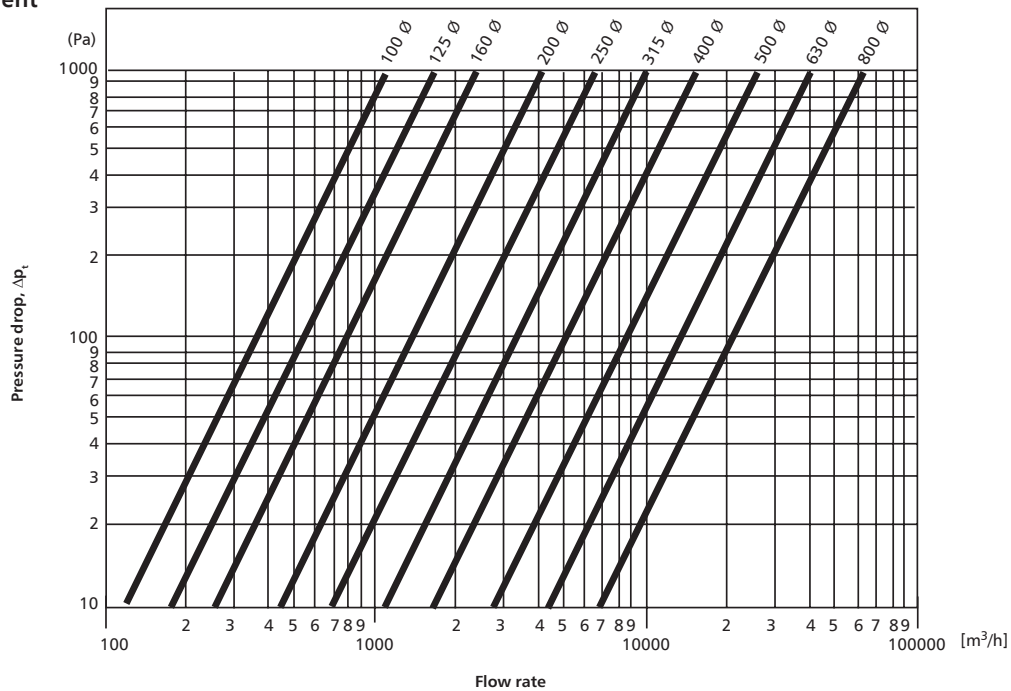

Air intake

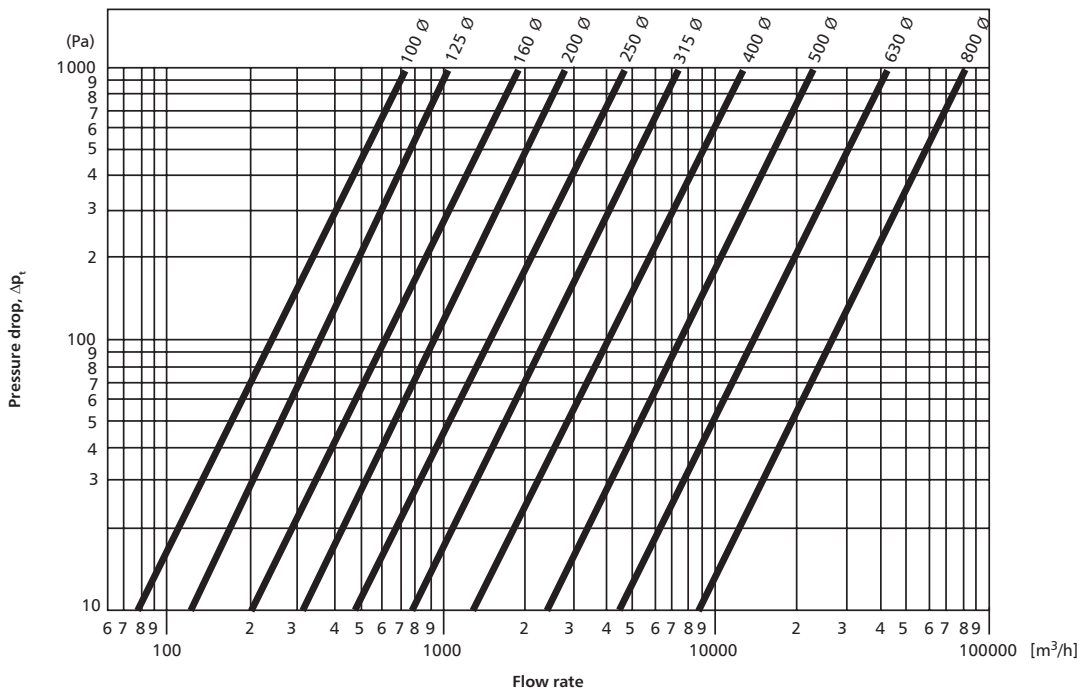

Air intake and roof exhaust units

HAN/HAF**Description**

HAN/HAF roof exhaust units are suitable for both industrial and housing ventilation systems.

The air is exhausted in a vertical stream to avoid contamination of the air and the nearby roof surface. This roof exhaust unit is so efficient that roof air intakes can be installed very close by.

The standard version is made from galvanized steel sheet; non-standard versions in stainless steel sheet, aluminium sheet, or plastic-coated steel sheet (in various colours) are available on request. The roof exhaust unit is topped with a 1/2-inch wire mesh and has an inner deflector flange for protection against snow and drainage of water to the outside of the vent.

Standard HAN roof exhaust units are manufactured with male flanges, female flanges, and double-sided female connections (for sliding over a duct).

Standard HAF roof exhaust units come with FLS steel flanges.

NOTE:

HAN - mounted over a fitting (female connector), into a duct (male connector), or over a duct (double-sided female connector);,

HAF - FLS steel flange connection.

Available materials — Product code examples

HAN/HAF-...- galvanized steel sheet

HAN/HAF-K-...- 1.4301/304 stainless steel sheet

Product code example

Product code: **HAN - aaa**

type _____
 Ød₁ _____

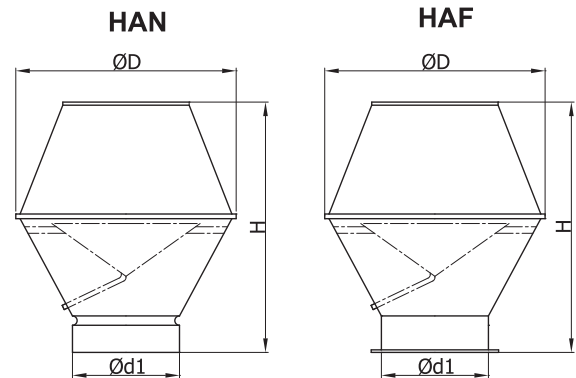
Dimensions

H = installation height for HAN/HAF

Ød ₁ [mm]	ØD [mm]	H [mm]	HAF weight (kg)	HAN weight (kg)
100	180	220	1,1	0,7
125	225	240	1,4	0,9
140	245	280	1,5	1,0
150	265	315	1,8	1,3
160	280	340	1,9	1,3
180	310	375	2,2	1,6
200	345	420	2,8	2,1
224	385	475	3,1	2,3
250	430	505	3,7	2,9
280	480	585	5,3	4,2
300	515	600	6,2	5,0
315	550	620	7,7	6,4
355	615	705	9,3	7,9
400	685	905	15,7	14,1
450	775	970	18,3	16,5
500	855	1055	21,3	19,3
560	955	1170	25,9	23,4
600	1015	1255	32,0	29,3
630	1075	1300	33,5	30,7
710	1215	1490	46,3	43,1

HAN/HAF

Technical specifications

Pressure drop

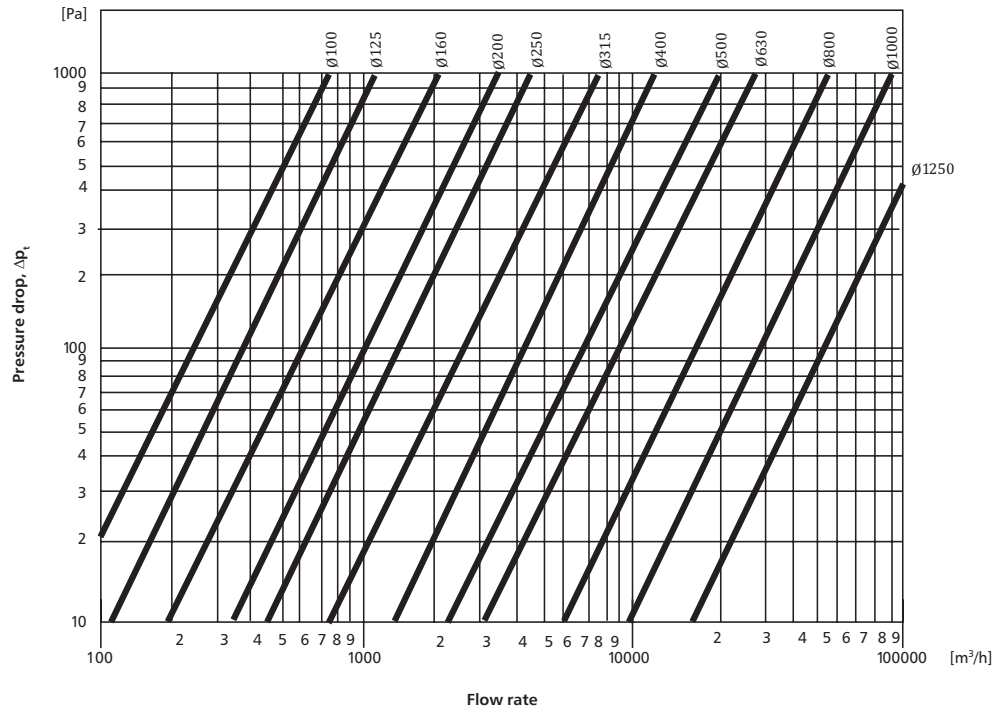

Sound ratings

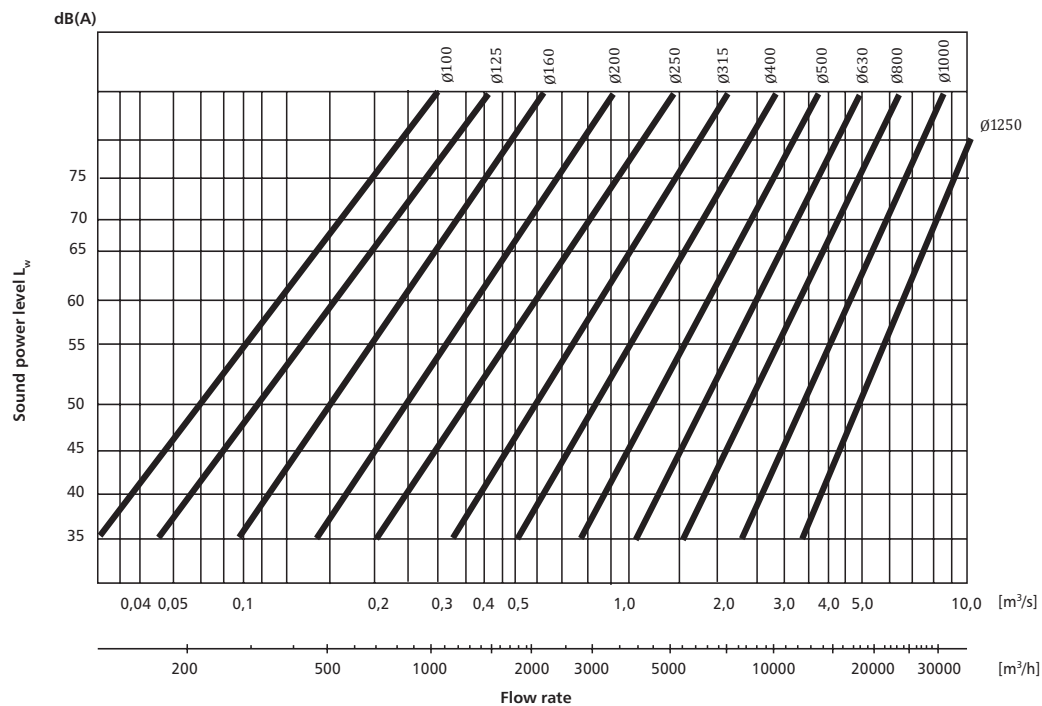

Square roof hood base

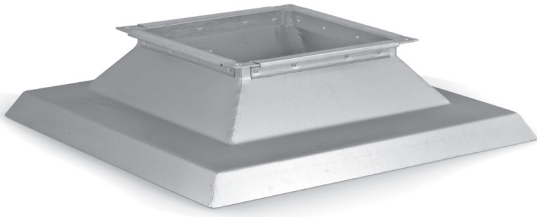
PDQ-AI**Description**

PDQ-AI roof bases are designed for termination of ventilation systems directly at the roof surface. The top part has a PQ30 frame angle flange to fit square air intakes and exhaust units. The product is available in all square cross-section sizes with the side length up to 1400 mm. The standard version is intended for flat roofs. The roof base can be customized for installation on up to 30-degree sloping roofs on request. The product is optionally available in stainless steel and aluminium sheet.

Available materials — Product code examples

PDQ-AI-...-...- galvanized steel sheet

Product code example

Product code: **PDQ-AI - 400 - 400**

type _____
 a _____
 b _____

Product code examples for standard sizes:

PDQ-AI-a-b **PDQ-AI-400-400**

Medium-pressure version:

PDQ-AI-a-b-S **PDQ-AI-400-400-S**

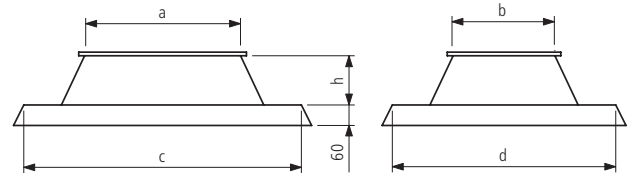
Dimensions

$a \times b$ [mm]	$c \times d$ [mm]	h [mm]
200 × 200	498 x 498	125
300 × 300	626 x 626	150
400 × 400	755 x 755	175
500 × 500	885 x 885	200
600 × 600	1014 x 1014	225
700 × 700	1143 x 1143	250
800 × 800	1272 x 1272	275
900 × 900	1401 x 1401	300
1000 × 1000	1531 x 1531	325
1100 × 1100	1660 x 1660	350
1200 × 1200	1789 x 1789	375
1300 × 1300	1917 x 1917	400
1400 × 1400	2046 x 2046	425

Square roof air intake/exhaust hood base

PDQ-AII



Description

PDQ-AII roof bases provide a connection between square ductwork and a roof ventilator or exhaust vent. The bottom part is an extended square duct, fabricated to the ordered size (max. 1400x1400 mm). The top part of the standard version is designed for installation on flat roofs and made of PQ30 frame angles to fit square air intakes and exhaust units. The roof base is also available, on request, in stainless steel or aluminium sheet or customized to roof slopes up to 30 degrees

Available materials - Product code examples
 PDQ-AII-....-... - galvanized steel sheet

Product code example

Product code: **PDQ-AII - 400 - 400**

type _____
 a _____
 b _____

Product code examples for standard sizes:

PDQ-AII-a-b **PDQ-AII-400-400**

Medium-pressure version:

PDQ-AII-a-b-S **PDQ-AII-400-400-S**

The square duct angle frame is made to Polish standards.

Dimensions

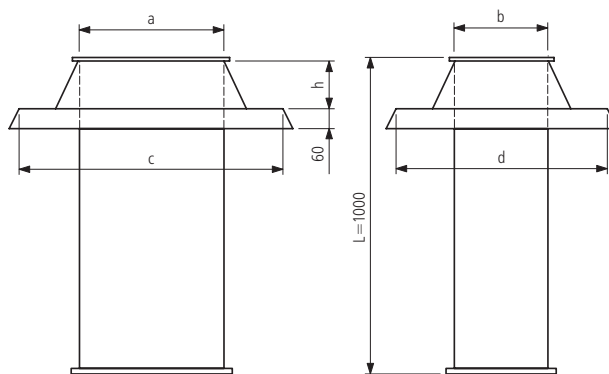

$a \times b$ [mm]	$c \times d$ [mm]	h [mm]
200 × 200	498 × 498	125
300 × 300	626 × 626	150
400 × 400	755 × 755	175
500 × 500	885 × 885	200
600 × 600	1014 × 1014	225
700 × 700	1143 × 1143	250
800 × 800	1272 × 1272	275
900 × 900	1401 × 1401	300
1000 × 1000	1531 × 1531	325
1100 × 1100	1660 × 1660	350
1200 × 1200	1789 × 1789	375
1300 × 1300	1917 × 1917	400
1400 × 1400	2046 × 2046	425

Roof curb for square roof bases

CQKD



Dimensions

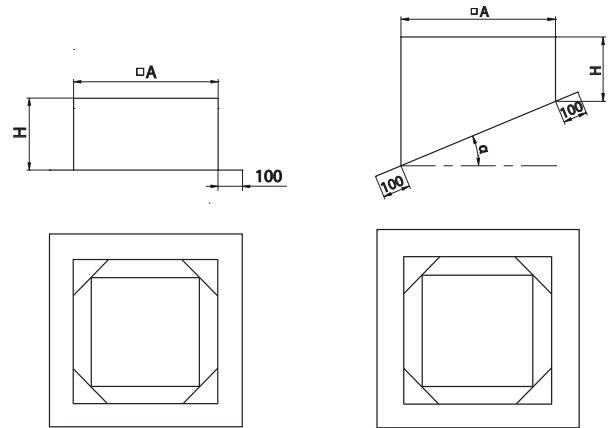

Description

CQKD roof curbs are installed on the roof surface as supports for PDQ-AI and PDQ-All roof bases. The product is available in galvanized steel, stainless steel and aluminium, plus versions with or without thermal insulation, and with a straight duct or a bend.

The standard insulating layer thickness is 25 mm or 50 mm. Sloping roof curbs are designed for sloping roofs.

The standard overall height of the roof curb is 500 mm. Any overall height can be produced on request.

Insulation:

I - insulated

Available materials — Product code examples

- CQKD-50-...-... - galvanized steel sheet
- CQKD-50-K-...-... - 1.4301/304 stainless steel sheet
- CQKD-50-K-...-...-316L - 1.4404/316L stainless steel sheet, molybdenum-enriched

Product code example

Product code: **CQKDI - 50 - AxB - α**

type	_____
insulation	_____
size	_____
angle	_____

Size [mm]	A [mm]	H [mm]
200 x 200	458	500
300 x 300	586	500
400 x 400	715	500
500 x 500	845	500
600 x 600	974	500
700 x 700	1103	500
800 x 800	1232	500
900 x 900	1361	500
1000 x 1000	1491	500
1100 x 1100	1620	500
1200 x 1200	1749	500
1300 x 1300	1877	500
1400 x 1400	2006	500

Square roof air intake unit

CDQ-A



Description

CDQ-A roof air intake units provide air entry termination in air intake ventilation systems. They are provided with 12.7x12.7 mm galvanized steel wire mesh made of 1 mm wires for protection against debris. CDQ-A roof air intakes are made from galvanized steel sheet. The flange is an PQ angle frame with NQ corner straps.

Available materials — Product code examples
 CDQ-A-...-... - galvanized steel sheet
 CDQ-A-K-...-... - 1.4301/304 stainless steel sheet
 CDQ-A-K-...-...-316L - 1.4404/316L stainless steel sheet, molybdenum-enriched

Product code example
 Product code: **CDQ-A - 400 - 400**

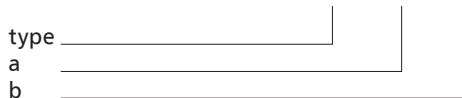

Product code examples for standard sizes:
CDQ-A-a-b **CDQ-A-400-400**
 Medium-pressure version:
CDQ-A-a-b-S **CDQ-A-400-400-S**

Dimensions

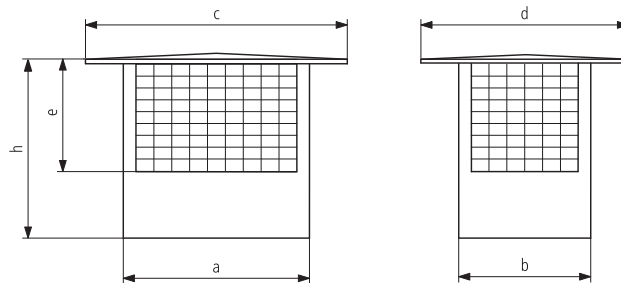

<i>a x b</i> [mm]	<i>c</i> [mm]	<i>d</i> [mm]	<i>e</i> [mm]	<i>h</i> [mm]
200 x 200	420	420	110	450
300 x 300	560	560	130	470
400 x 400	760	760	180	520
500 x 500	920	920	210	550
600 x 600	1080	1080	240	580
700 x 700	1260	1260	280	620
800 x 800	1460	1460	330	670
900 x 900	1640	1640	370	710
1000 x 1000	1820	1820	410	750
1100 x 1100	1980	1980	440	780
1200 x 1200	2160	2160	480	820
1300 x 1300	2340	2340	520	860
1400 x 1400	2520	2520	560	900

Louvre roof air intake hood

CDQ-B**Description**

The product is intended for rooftop installation or directly over buried heat exchanger units in heat-recovery systems. The unit admits air into the ventilation system. It is made from galvanized steel sheet. The horizontal louvre blades protect against ingress of rain, snow and water. The 12.7x12.7 mm mesh protects the air intake against birds, large insects, leaves and debris. The bottom of the CDQ-B air intake unit is trimmed with PQ-30 or PQ-20 angles for direct fastening with SRS screws, NKS nuts and KLQ G-clamps to a roof base or a square duct.

Available materials — Product code examples

CDQ-B-...-... - galvanized steel sheet

CDQ-B-K-...-... - 1.4301/304 stainless steel sheet

Product code example

Product code: **CDQ-B - 400 - 400**

typ _____
 a _____
 b _____

Product code examples for standard sizes:

CDQ-B-a-b **CDQ-B-400-400**

Medium-pressure version:

CDQ-B-a-b-S **CDQ-B-400-400-S**

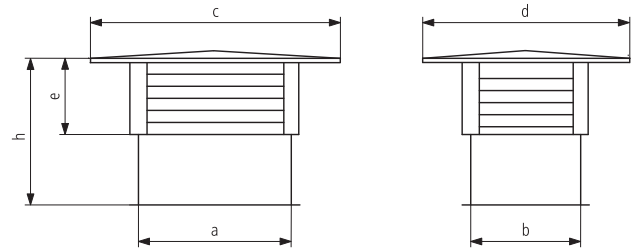
Dimensions

<i>a x b</i> [mm]	<i>c</i> [mm]	<i>d</i> [mm]	<i>e</i> [mm]	<i>h</i> [mm]	Clearance
200 x 200	360	360	340	620	79%
300 x 300	460	460	400	680	78%
400 x 400	560	560	460	740	77%
500 x 500	660	660	520	800	77%
600 x 600	760	760	640	920	77%
700 x 700	860	860	700	980	76%
800 x 800	960	960	760	1040	76%
900 x 900	1060	1060	820	1100	76%
1000 x 1000	1160	1160	940	1220	76%
1100 x 1100	1260	1260	1000	1280	76%
1200 x 1200	1360	1360	1060	1340	76%
1300 x 1300	1460	1460	1120	1400	76%
1400 x 1400	1560	1560	1240	1520	76%

Roof exhaust vent

WDQ-A



Description

WDQ-A roof exhaust vents offer the best budget option on the market for square ductwork systems. The cap protects against rain, snow and water, while the wide gaps in the side walls help to ensure efficient air exhaust from the ventilation system. The standard version is made from galvanized steel sheet and trimmed with PQ-20 or PQ-30 angles for fastening to a roof base or directly to a square duct. Other angles and materials are available or request, including PQ-40 units or versions in stainless steel sheet and aluminium sheet.

Available materials — Product code examples
 WDQ-A-...-... - galvanized steel sheet
 WDQ-A-K-...-... - 1.4301/304 stainless steel sheet
 WDQ-A-K-...-...-316L - 1.4404/316L stainless steel sheet molybdenum-enriched

Product code example
 Product code: **WDQ-A - 400 - 400**

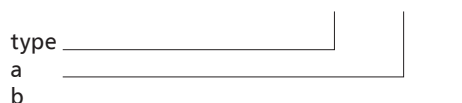

Product code examples for standard sizes:
WDQ-A-a-b **WDQ-A-400-400**
 Medium-pressure version:
WDQ-A-a-b-S **WDQ-A-400-400-S**

Dimensions

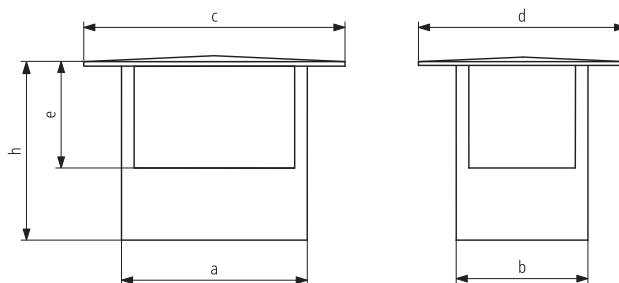

<i>a x b</i> [mm]	<i>c</i> [mm]	<i>d</i> [mm]	<i>e</i> [mm]	<i>h</i> [mm]
200 x 200	420	420	110	450
300 x 300	560	560	130	470
400 x 400	760	760	180	520
500 x 500	920	920	210	550
600 x 600	1080	1080	240	580
700 x 700	1260	1260	280	620
800 x 800	1460	1460	330	670
900 x 900	1640	1640	370	710
1000 x 1000	1820	1820	410	750
1100 x 1100	1980	1980	440	780
1200 x 1200	2160	2160	480	820
1300 x 1300	2340	2340	520	860
1400 x 1400	2520	2520	560	900

Louvre roof exhaust hood

WDQ-B**Description**

WDQ-B roof exhaust vents feature horizontal louvres; these reduce the air exhaust flow below the performance ratings of WDQ-A units while minimizing to a great extent the risk of rain, snow, or water ingress. The standard installation method requires bolting PQ angles to a roof base or a duct, either made from galvanized steel sheet. The product is available in stainless steel sheet on request.

Available materials — Product code examples

WDQ-B-...-... - galvanized steel sheet

WDQ-B-K-...-... - 1.4301/304 stainless steel sheet

Product code example

Product code: **WDQ-B - 400 - 400**

type _____
 a _____
 b _____

Product code examples for standard sizes:

WDQ-B-a-b **WDQ-B-400-400**

Medium-pressure version:

WDQ-B-a-b-S **WDQ-B-400-400-S**

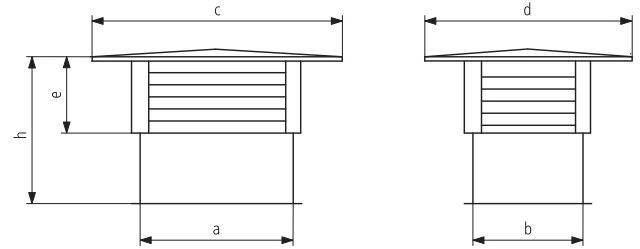
Dimensions

<i>a x b</i> [mm]	<i>c</i> [mm]	<i>d</i> [mm]	<i>e</i> [mm]	<i>h</i> [mm]	Clearance
200 x 200	360	360	340	620	79%
300 x 300	460	460	400	680	78%
400 x 400	560	560	460	740	77%
500 x 500	660	660	520	800	77%
600 x 600	760	760	640	920	77%
700 x 700	860	860	700	980	76%
800 x 800	960	960	760	1040	76%
900 x 900	1060	1060	820	1100	76%
1000 x 1000	1160	1160	940	1220	76%
1100 x 1100	1260	1260	1000	1280	76%
1200 x 1200	1360	1360	1060	1340	76%
1300 x 1300	1460	1460	1120	1400	76%
1400 x 1400	1560	1560	1240	1520	76%

Type E roof exhaust vents

WDQ-E



Description

The type E roof exhaust vents are installed in air exhaust ventilation systems as air exhaust termination units. The product features an inner water drain. The flange is made of P30 sheet angles. Inside the vent, there is a drip tray for removing rain and melt water. The exhaust vent is closed with galvanized steel wire mesh.

Available materials — Product code examples

WDQ-E-...-...-...-...- galvanized steel sheet

Product code example

Product code: **WDQ-E - 300 - 300 - 700 - 720**

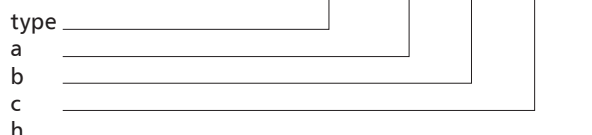

Product code examples for standard sizes:

WDQ-E-a-b **WDQ-E-300-300**

Medium-pressure version:

WDQ-E-a-b-S **WDQ-E-300-300-S**

Dimensions

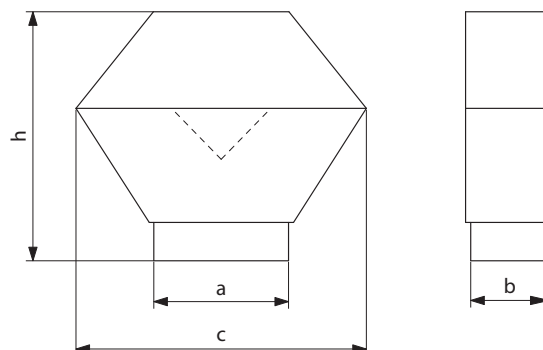

$a \times b$ [mm]	c [mm]	h [mm]
250 x 250	600	660
300 x 300	700	720
400 x 400	900	890
500 x 500	1100	1060
600 x 600	1300	1200
800 x 800	1700	1540
1000 x 1000	2100	1880
1200 x 1200	2500	2220

Air intake and exhaust bends

BFQN-135**Description**

The air intake and exhaust bends are terminations for ventilation ducts. The ends are fitted with sheet angles, and the entire bend is braced by cross-wise ribbing. The outer end above the roof has louvre blades and a wire mesh inside the bend.

Available materials — Product code examples

BFQN-135-...-... - galvanized steel sheet

BFQN-K-...-... - 1.4301/304 stainless steel sheet

Product code example

Product code: **BFQN-135 - 500 - 300**

type _____
 a _____
 b _____

Product code examples for standard sizes:

BFQN-135-a-b **BFQN-135-500-400**

Medium-pressure version:

BFQN-135-a-b-S **BFQN-135-500-300-S**

Dimensions